

# CLEVENGER IRRIGATION WORKS

## SEC. 3 - T.12S. R.5 W. W.M.

Scale:- 1 inch = 40 chains.

May 28, 1926

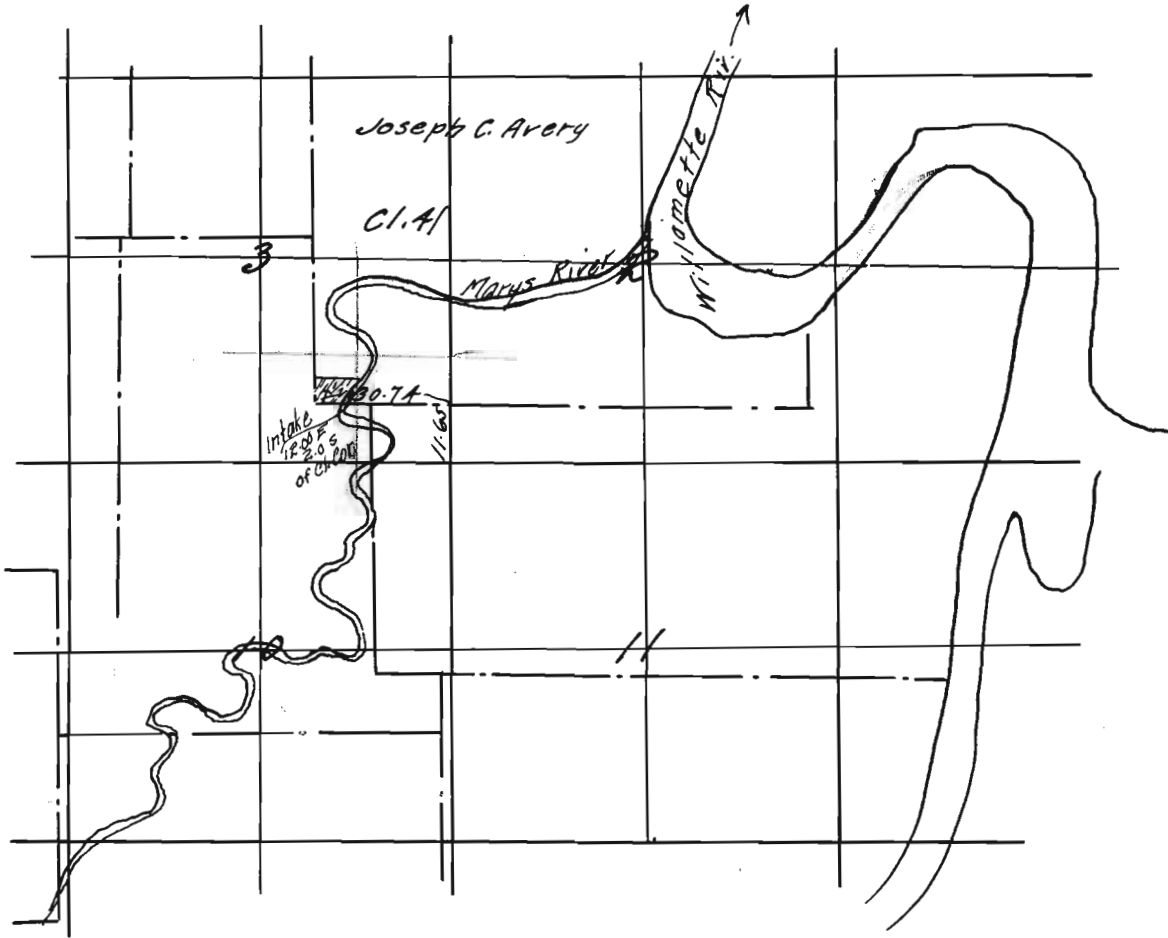

Certificate:-

I, Walter W. Larsen, of Corvallis, Oregon, do hereby certify that this map was made from notes taken during an actual survey by me and assistants on May 1922 and subsequent dates and that it correctly represents the works described in the accompanying application together with the location of streams and other ditches in the immediate vicinity

Walter W. Larsen  
Registered Professional Engineer  
Oregon No. 1261

May 1923

10812

STATE ENGINEER

RECEIVED

MAY 2 1926

NO. 10812

Application No. 10812  
Permit No.