

FINAL PROOF MAP  
 E 1/2 NE 1/4 Section 13  
 T.39S. R.1E. W.M.  
 Lake County, Oregon





Edward N. & Diane C. Almojuela  
 Application #G 11762  
 Permit #G 11169

G-11169  
 72376

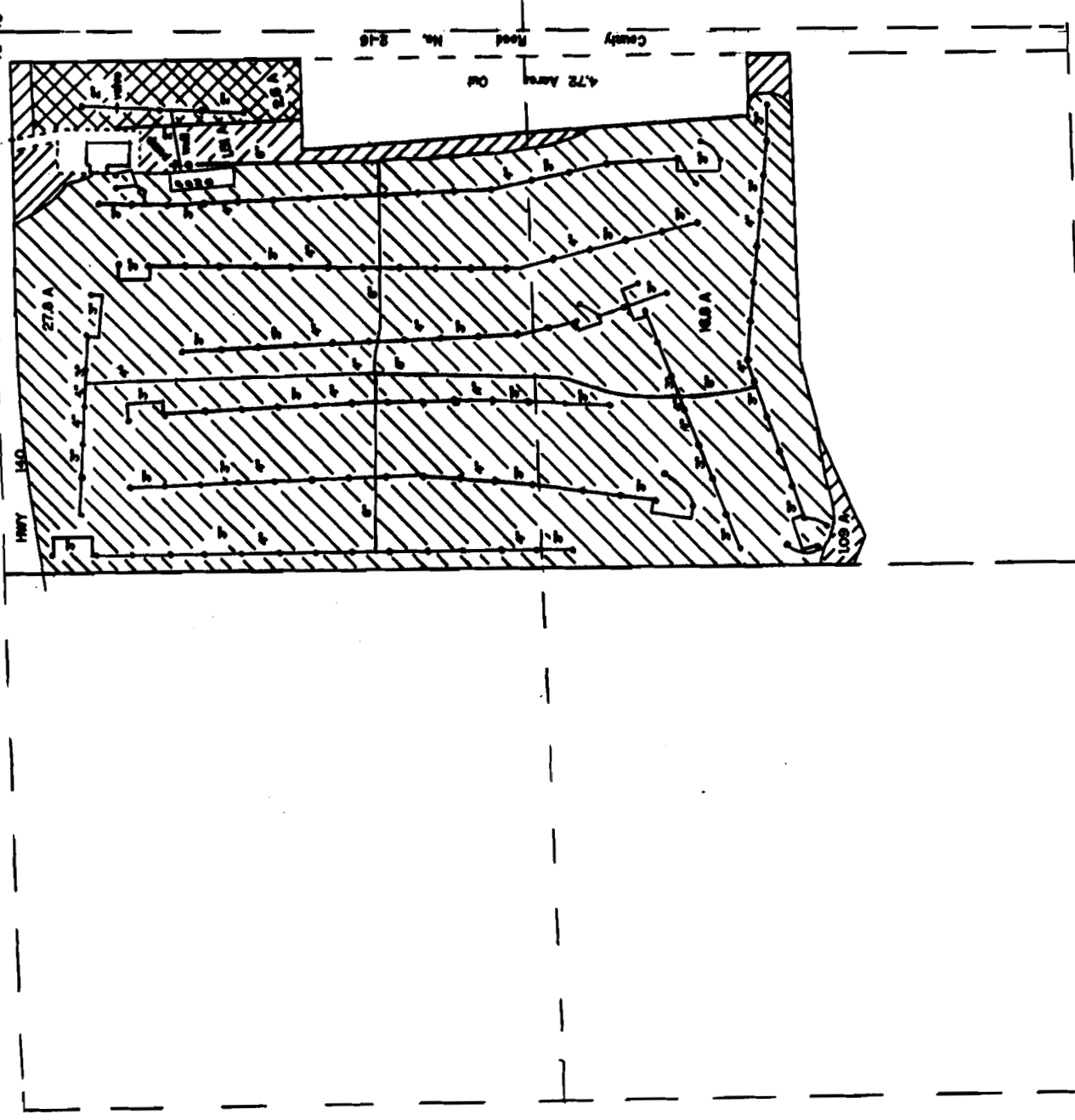

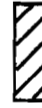
Well is located 9.33° 17' 37" W a distance of 588.24' from the NE section corner Section 13



-  44.6 acres Supplemental to Certificate # 47469 and # 36888
-  2.6 acres Supplemental to Certificate # 47469
-  2.6 acres Primary
-  Indicates location of outlet for sprinkler
-  Section corner - railroad spike in center of Hwy

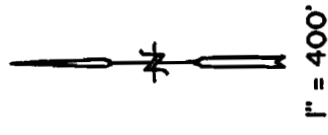

This map is for the purpose of identifying the location of the water right only and is not intended to provide legal dimensions or location of property ownership lines.

Drawing # WR 3492  
 March 1987