

TOWNSHIP 26 SOUTH, RANGE 4 WEST, W.M.

SECTION 14

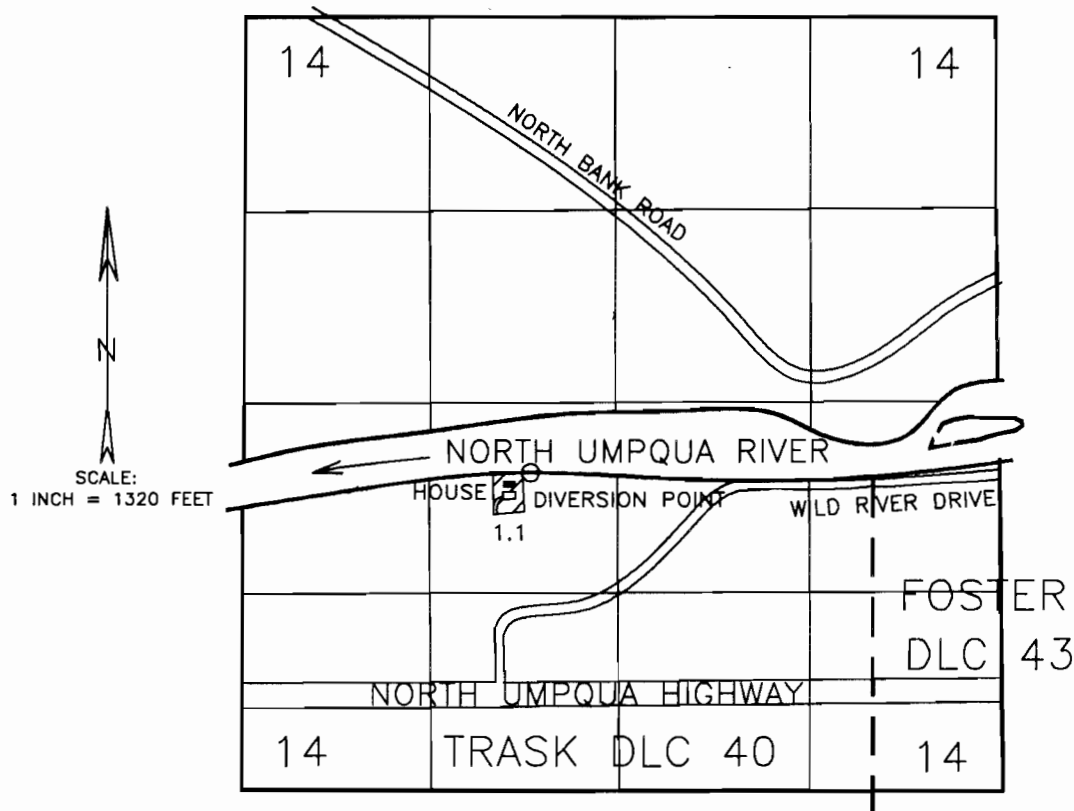

THE DIVERSION POINT IS LOCATED 2170 FEET NORTH AND 3160 FEET WEST FROM THE SOUTHEAST CORNER OF SECTION 14.

FINAL PROOF SURVEY

for

JAMES C. CADDOCK

APPLICATION 70011

PERMIT 50797

THE PURPOSE OF THIS MAP IS TO IDENTIFY THE LOCATION OF THE WATER RIGHT. IT IS NOT INTENDED TO PROVIDE INFORMATION RELATIVE TO THE LOCATION OF PROPERTY OWNERSHIP BOUNDARY LINES.

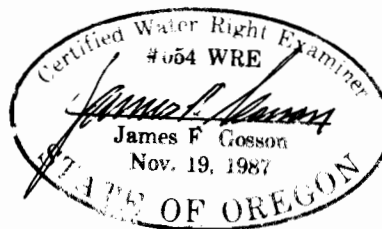

CORRECTED 12/20/92 ms

surveyed 8/23/92 ms