

TOWNSHIP 26 SOUTH, RANGE 5 WEST, W.M.

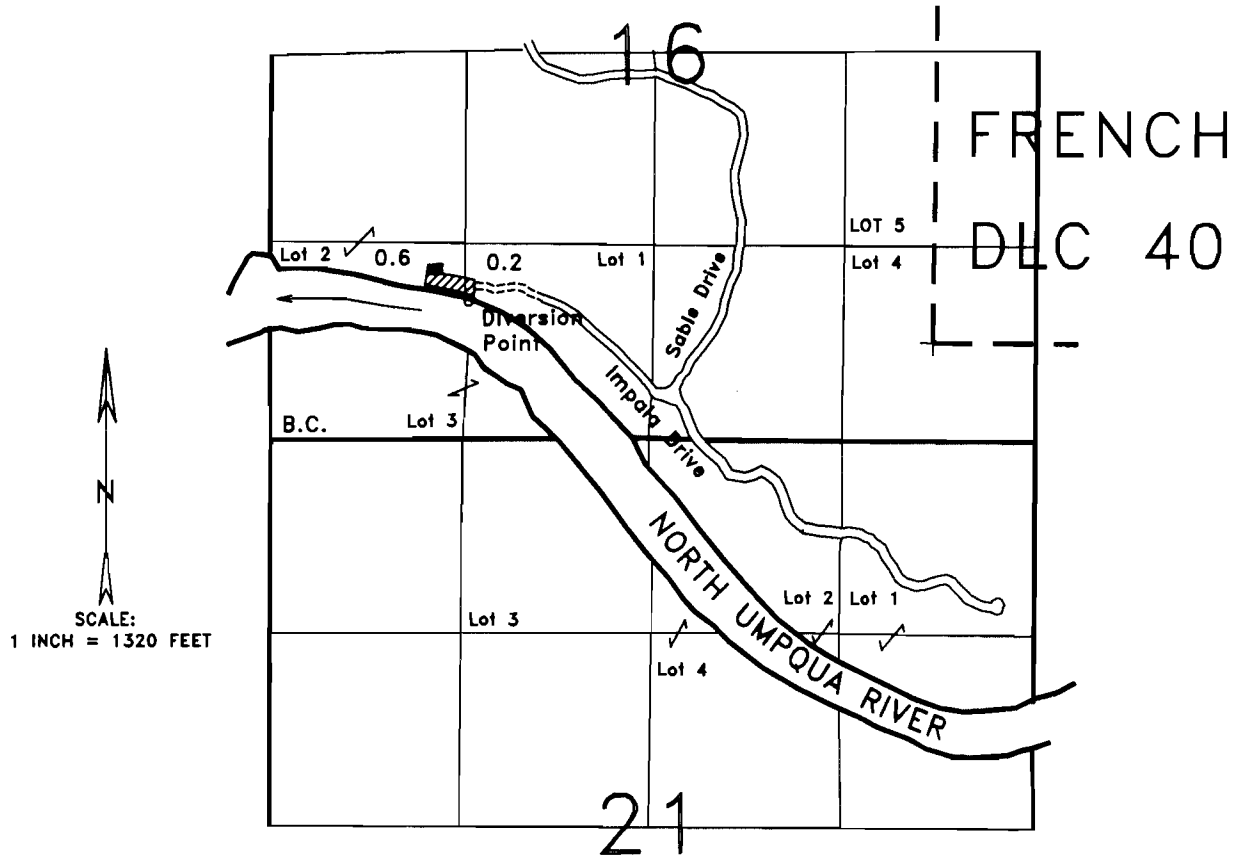

THE DIVERSION POINT IS LOCATED 950' NORTH & 1360' EAST FROM THE SOUTHWEST CORNER OF SECTION 16.

FINAL PROOF SURVEY
for
DANIEL R. FRIEDMAN
Application 70619
Permit 51182

THE PURPOSE OF THIS MAP IS TO IDENTIFY THE LOCATION OF THE WATER RIGHT. IT IS NOT INTENDED TO PROVIDE INFORMATION RELATIVE TO THE LOCATION OF PROPERTY OWNERSHIP BOUNDARY LINES.

