

T. 16 S. R. 2 E. W.M.

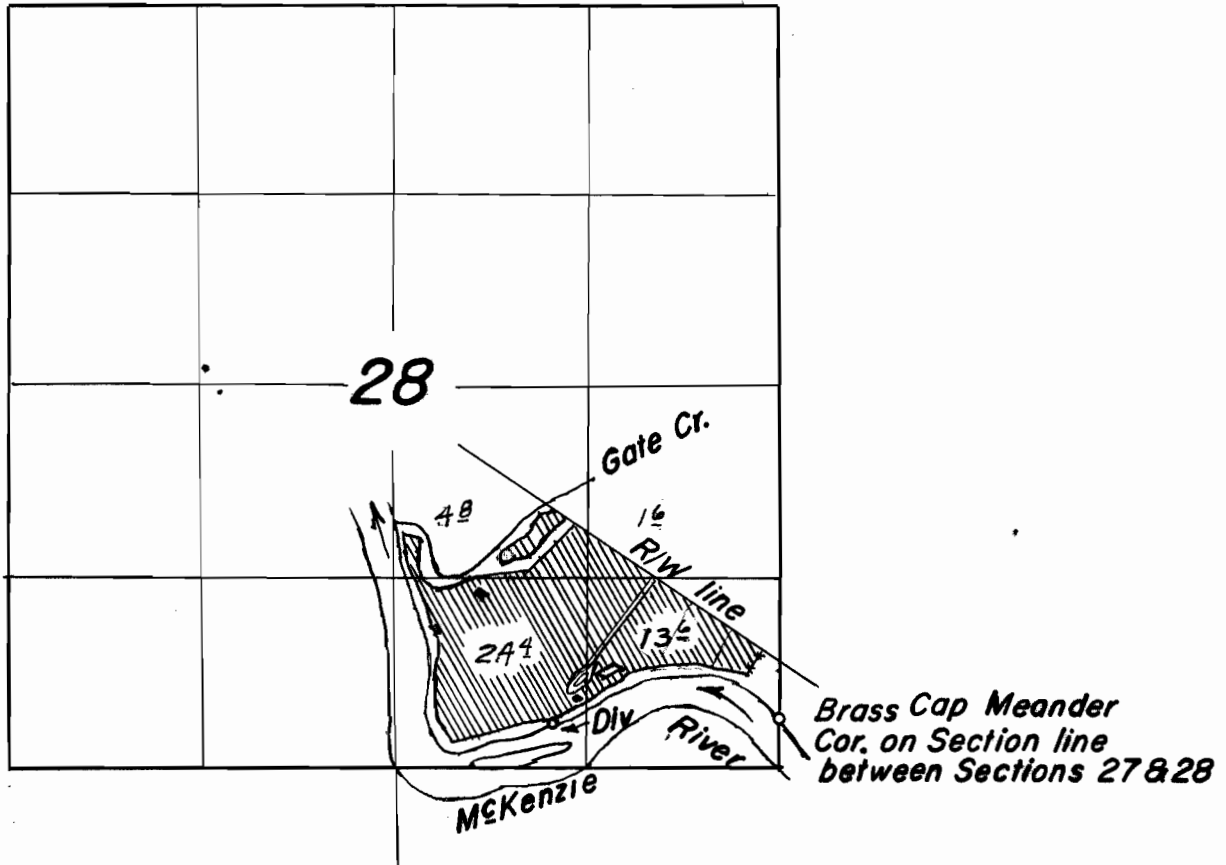

FINAL PROOF SURVEY
UNDER

Application No. 33494 Permit No. 26475
IN NAME OF

JUANITA F. CASSELMAN

Surveyed APRIL 19 1962, by C.O. Bartels
F.L. Siegmund

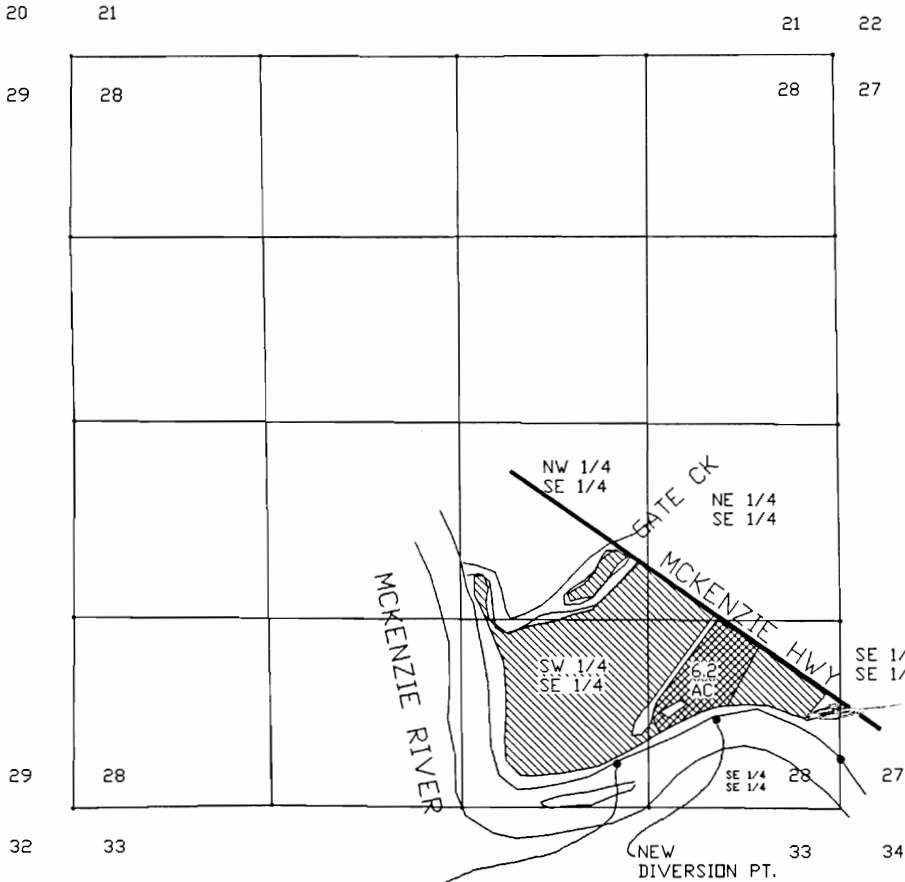

EXISTING RIGHT
PERMIT NO. 26475

LOT 1

BRASS CAP MEANDER
CORNER ON SECTION
LINE BETWEEN SECTIONS
27 & 28.

SCALE 1" = 1320'

NOTE:
THIS MAP WAS PREPARED FOR THE
PURPOSE OF IDENTIFYING THE LOCATION
OF THE WATER RIGHT ONLY. IT IS
NOT INTENDED TO PROVIDE DIMENSIONS
OR LOCATION OF PROPERTY OWNERSHIP
LINES.

NEW DIVERSION PT. LOCATION
231.49 FEET NORTH &
849.04 FEET WEST OF THE
WEST MEANDER CORNER BETWEEN
SECTIONS 27 & 28.

FINAL PROOF SURVEY
APPLICATION #T-6606 & 51989 PERMIT #26475

FOR
JACK E. SHEKELL
45748 MCKENZIE HWY
VIDA, OR 97488
PH 896-0082

BY
STEPHEN H. FORD INC.
SECTION 28, TOWNSHIP 16 SOUTH, RANGE 2 EAST, W.M.
1120 BAILEY HILL ROAD NO. 1
EUGENE, OR 97402
PH (503) 344-1852
JOB NO. 1219.9

