

G 5510 5

CANCELLED
V. 50 P. 610 & 629

T. 15S., R. 32E., W.M.

T-7003 T-6925
12775
74274

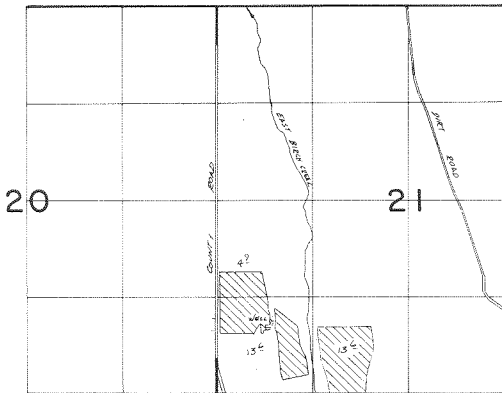

Well Loc. 1000' N of 750' E From SW Cor. Sec 21

FINAL PROOF SURVEY
UNDER

Application No. G:5701. Permit No. G:5510...
IN NAME OF

...CHARLES W. & DIXIE CUMISKY.

Surveyed ^{21st} ~~1st~~ _{100 250 4} ~~1st~~ 1986, by W. L. Church

48 12