

# MAP

ACCOMPANYING APPLICATION FOR PERMIT  
TO APPROPRIATE WATER  
SECTION 26 T2S R6 E. W.M.  
Scale 1" = 400'

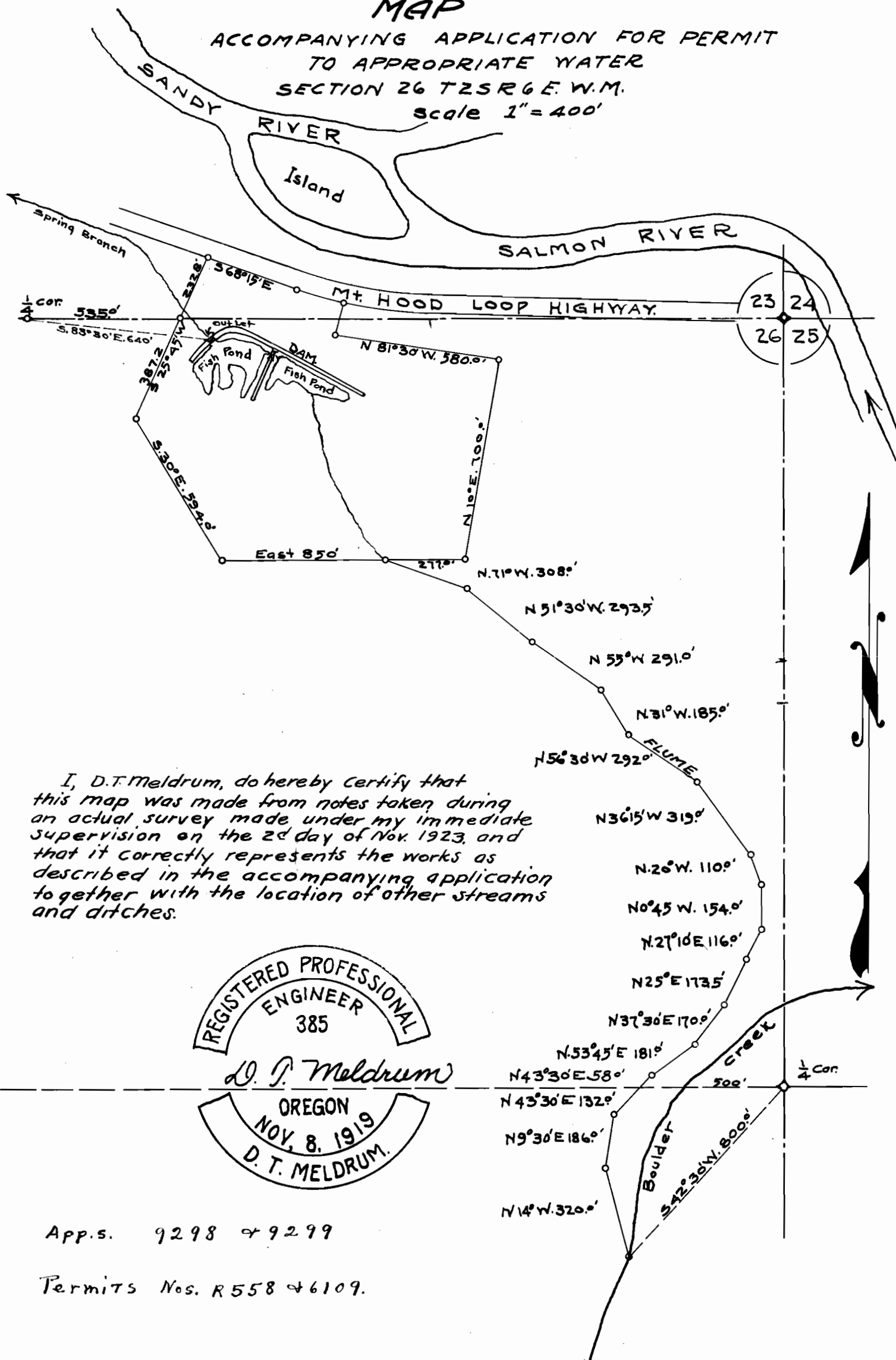

I, D.T. Meldrum, do hereby certify that this map was made from notes taken during an actual survey made under my immediate supervision on the 2d day of Nov. 1923, and that it correctly represents the works as described in the accompanying application together with the location of other streams and ditches.

REGISTERED PROFESSIONAL  
ENGINEER  
385

*D. T. Meldrum*

OREGON  
NOV. 8, 1919  
D. T. MELDRUM.

App.s. 9298 & 9299

Permits Nos. R558 & 6109.