

MAP
 Accompanying application for permit to
 appropriate water
 for the

ABRAHAM WILSON IRRIGATION SYSTEM

IN

SEC'S 12 AND 13 T28S R5W W.M.
 DOUGLAS COUNTY OREGON

CERTIFICATE OF SURVEYOR

I, C.W. Springer, of Roseburg Oregon,
 do hereby certify that this map was made
 from notes taken during an actual survey
 made by me on June 19, 1923, and that
 it correctly represents the works
 described in the accompanying application,
 together with the location of streams
 and other ditches in the immediate vicinity.

C. W. Springer
 Deputy County Surveyor.

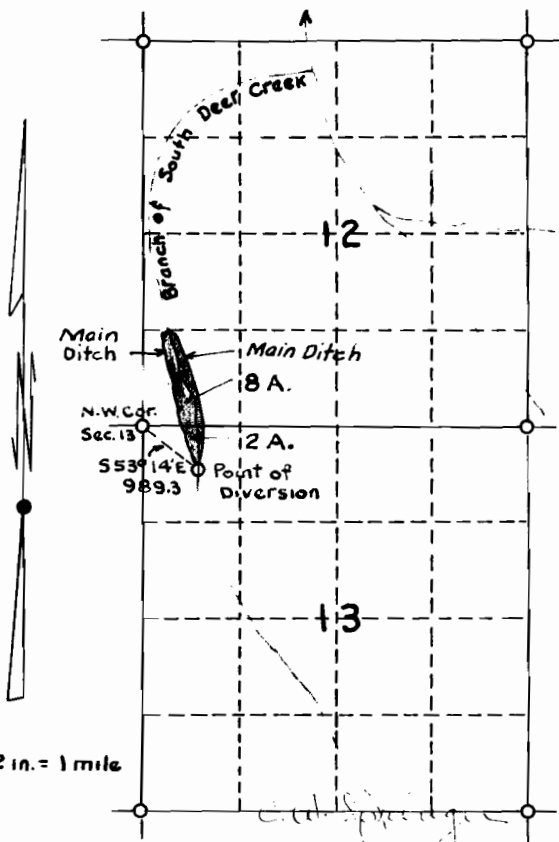

SCALE - 2 in. = 1 mile

*Abraham Wilson No. 7507
 Filed No. 5944*