

RECEIVED

POND # 15

JUL 19 1996

WATER RESOURCES DEPT.
SALEM, OREGON

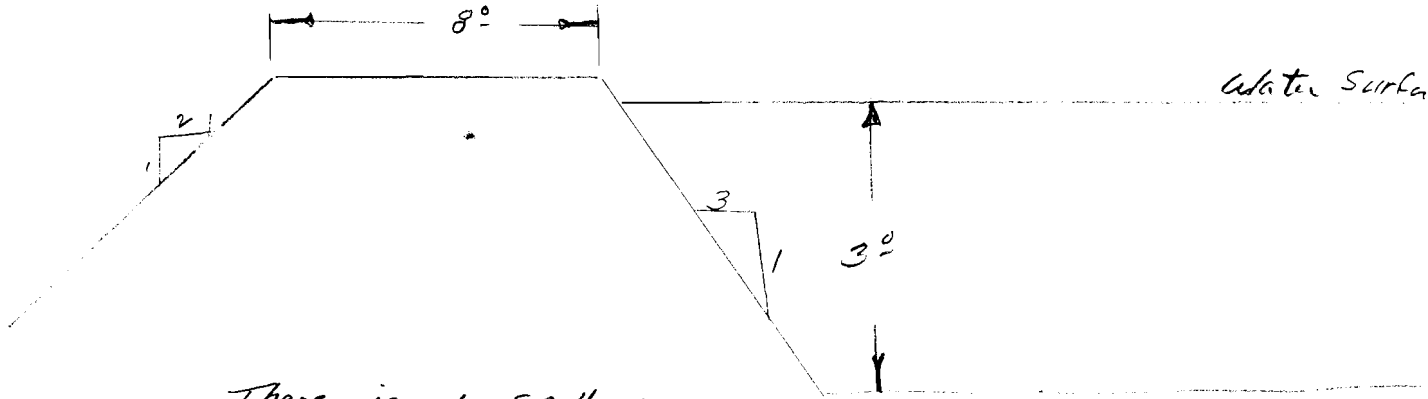

There is no spillway
on this structure.

$$\text{Surface Area} = 40^2 \times 3.1416 = \underline{5026.3 \text{ Sq. FT.}}$$

$$\text{Capacity} = 40 \times 40 \times 3.1416 \times 3 = \underline{15,080 \text{ FT}^3}$$

$$\frac{15,080 \times .40}{43,560} = \underline{.12 \text{ AC FT.}}$$

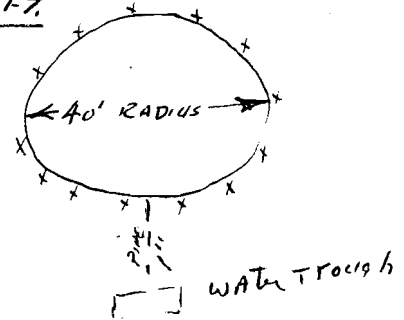

This pond was constructed shortly after the original application was sent to Water Resources, and was in place prior to January 1, 1993. The pond has no overflow as the water does not flow away from the pond. The pond was dug out of the ground and is filled by snow melt and a spring near the surface. The water is piped to a water trough so that the cattle do not cave in the pond banks.

Application No. R- 81203
Permit No.

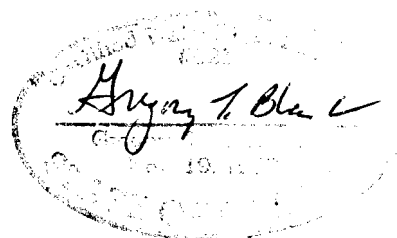

3



SCALE: 1" = 1320'

APPLICATION MAP FOR
WATER RIGHTS

T 6 S R 40 E

For
THE HART ESTATE INVESTMENT

DATE: March 10, 1992

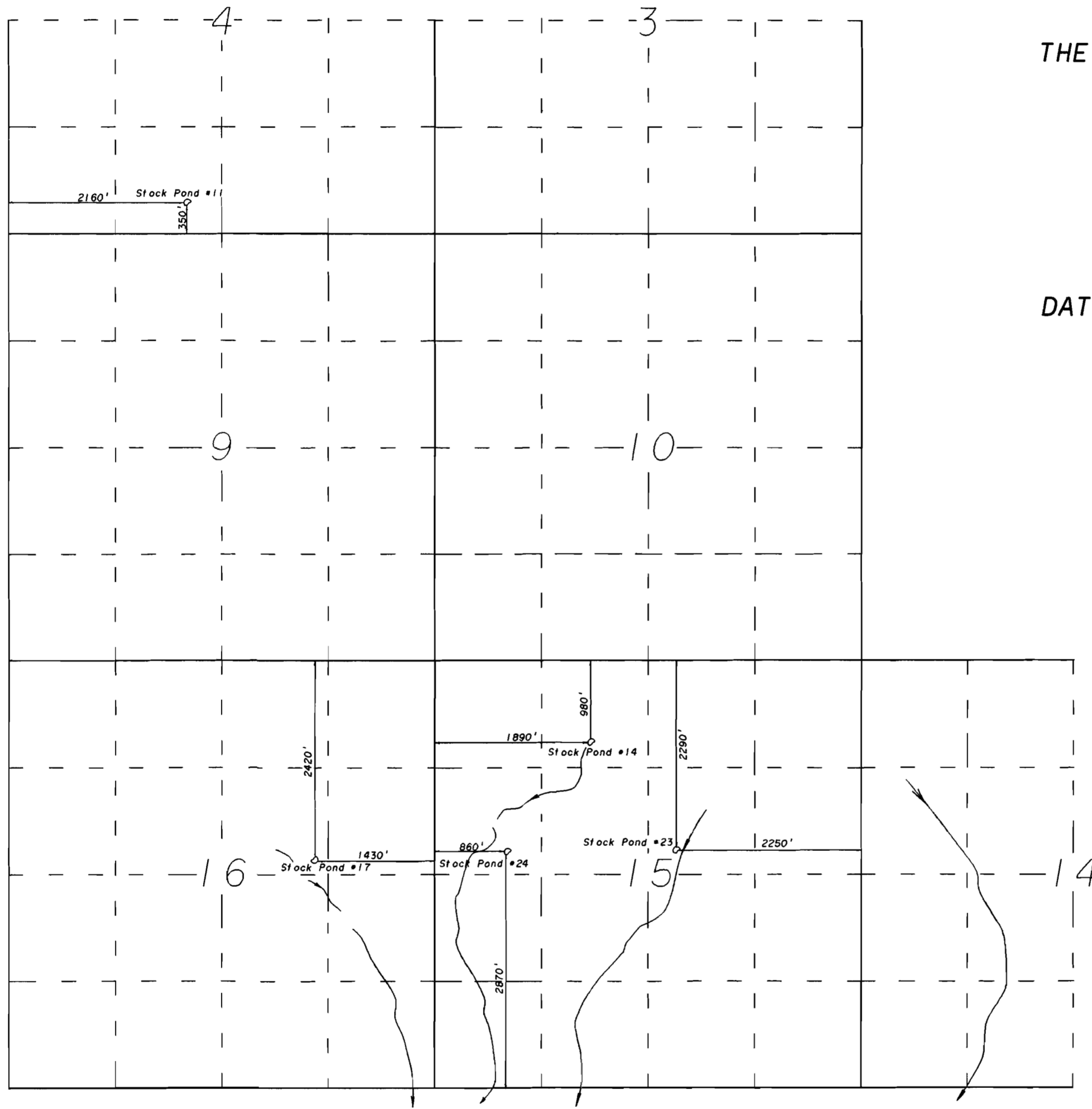

Water Right R-81003

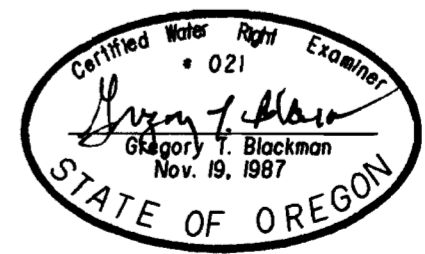

BAGETT-GRIFFITH & ASSOCIATES
2006 Adams Avenue
LaGrande, Oregon 97850

NOTE: The preparation of this map was for the purpose of identifying the location of the proposed water right and has no intent to provide dimensions or location of property ownership lines. Location information shown hereon was furnished by the applicant.

4



SCALE: 1" = 1320'

APPLICATION MAP FOR WATER RIGHTS

T 6 S R 40 E

For
THE HART ESTATE INVESTMENT

DATE: March 10, 1992

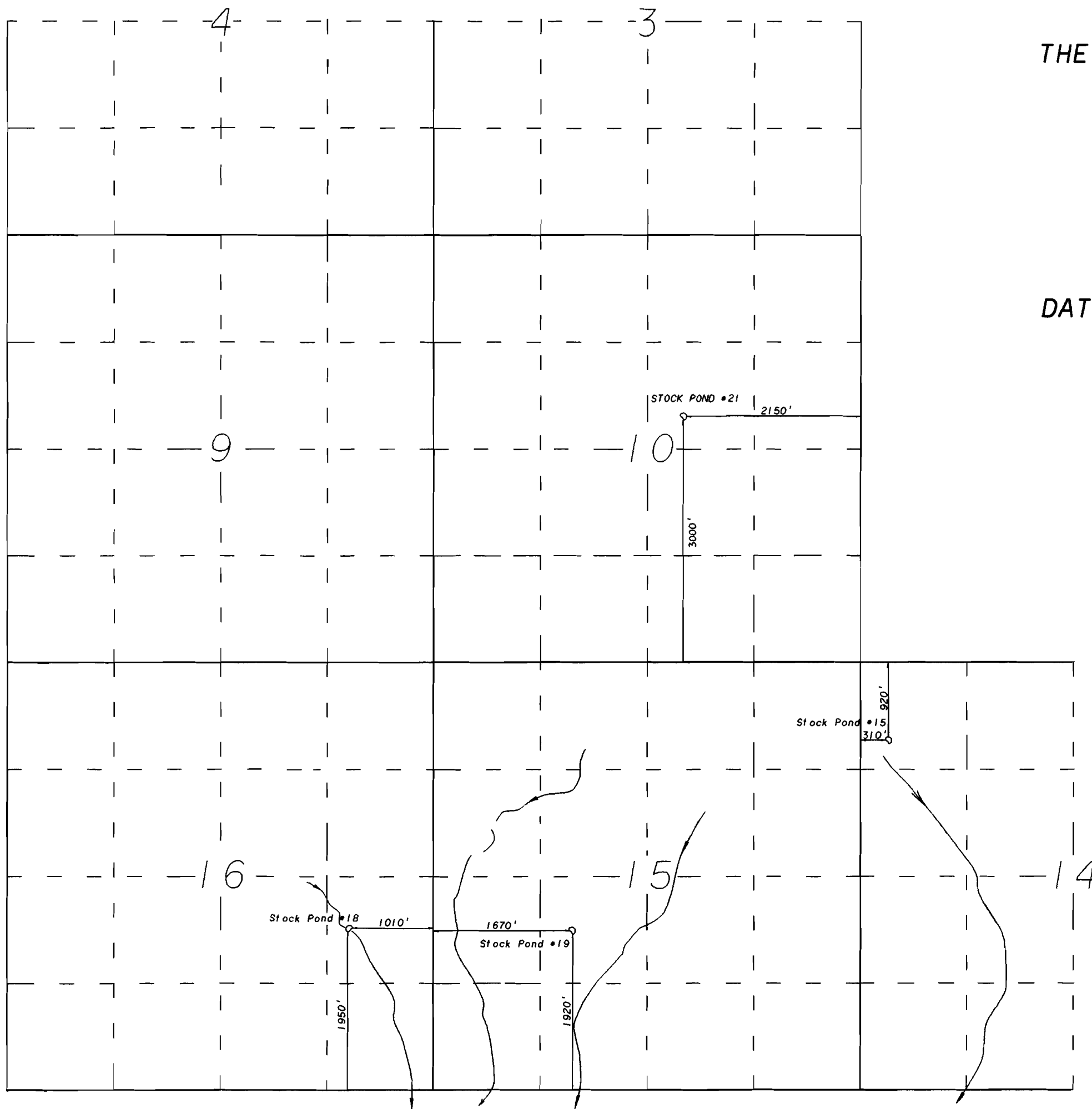

OFFICE OF
WATER RIGHTS
DIVISION

REGISTRATION NO. R-81003

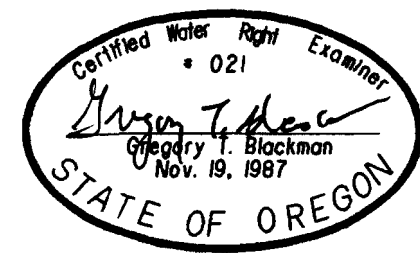

BAGETT-GRIFFITH & ASSOCIATES
2006 Adams Avenue
LaGrande, Oregon 97850

NOTE: The preparation of this map was for the purpose of identifying the location of the proposed water right and has no intent to provide dimensions or location of property ownership lines. Location information shown hereon was furnished by the applicant.