

R-81342

RECEIVED

JUL 30 1996
WATER RESOURCES DEPT.
SALEM, OREGON

SCALE 1:9600

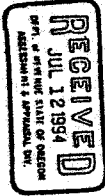

See Map 2N 10 11

See Map 2N 10 1

See Map 2N 11 7

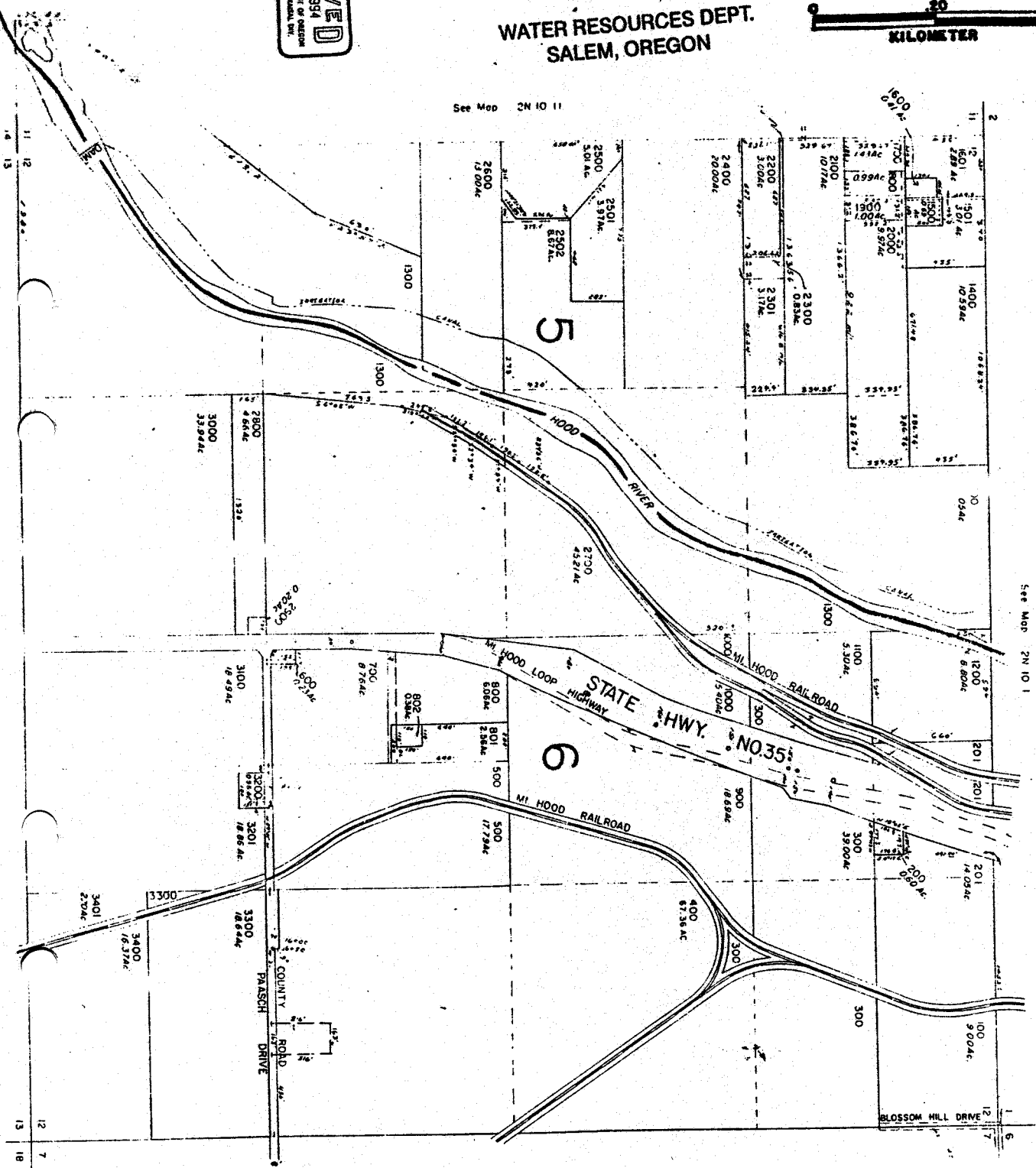

Section T2N R10E WM
Hood River County
1:400'

Application No. R-81342
Permit No.

2N 10 12

CANCELLED
401

21 12