

T. 8 S. R. 39 E. W. M.

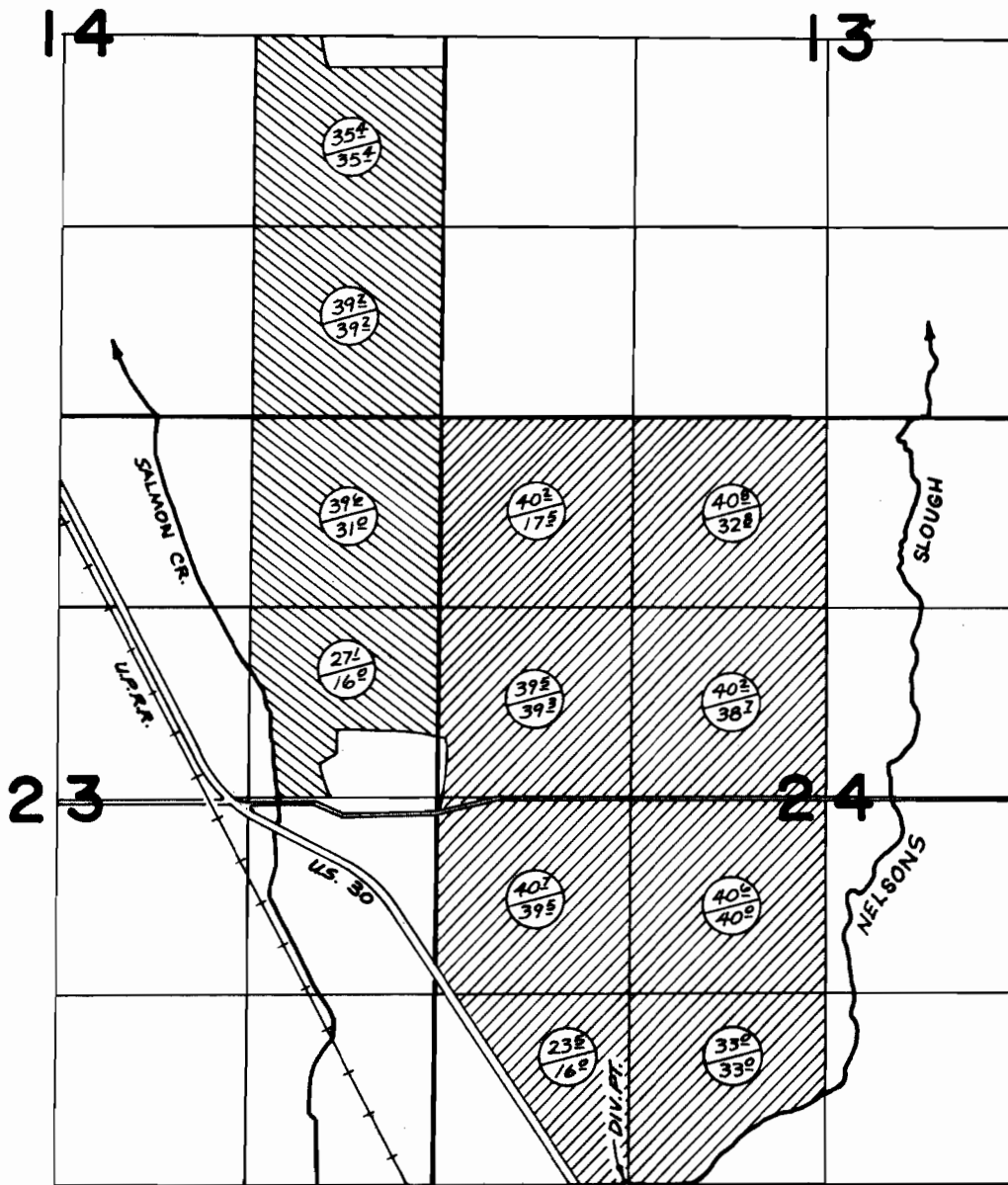

DIK. PT. - 10' N., 1340' E., FROM S.W. CORNER SECTION 24

FINAL PROOF SURVEY

UNDER



FOUND
ALLOWED



PRIMARY
SUPPLEMENTAL

Application No. 48384 Permit No. 36323
IN NAME OF

CHANDLER HEREFORDS INC.

Surveyed OCT. 31 1974, by L.M. TOLLY