

# T. 29 S., R. 7 W., W.M.

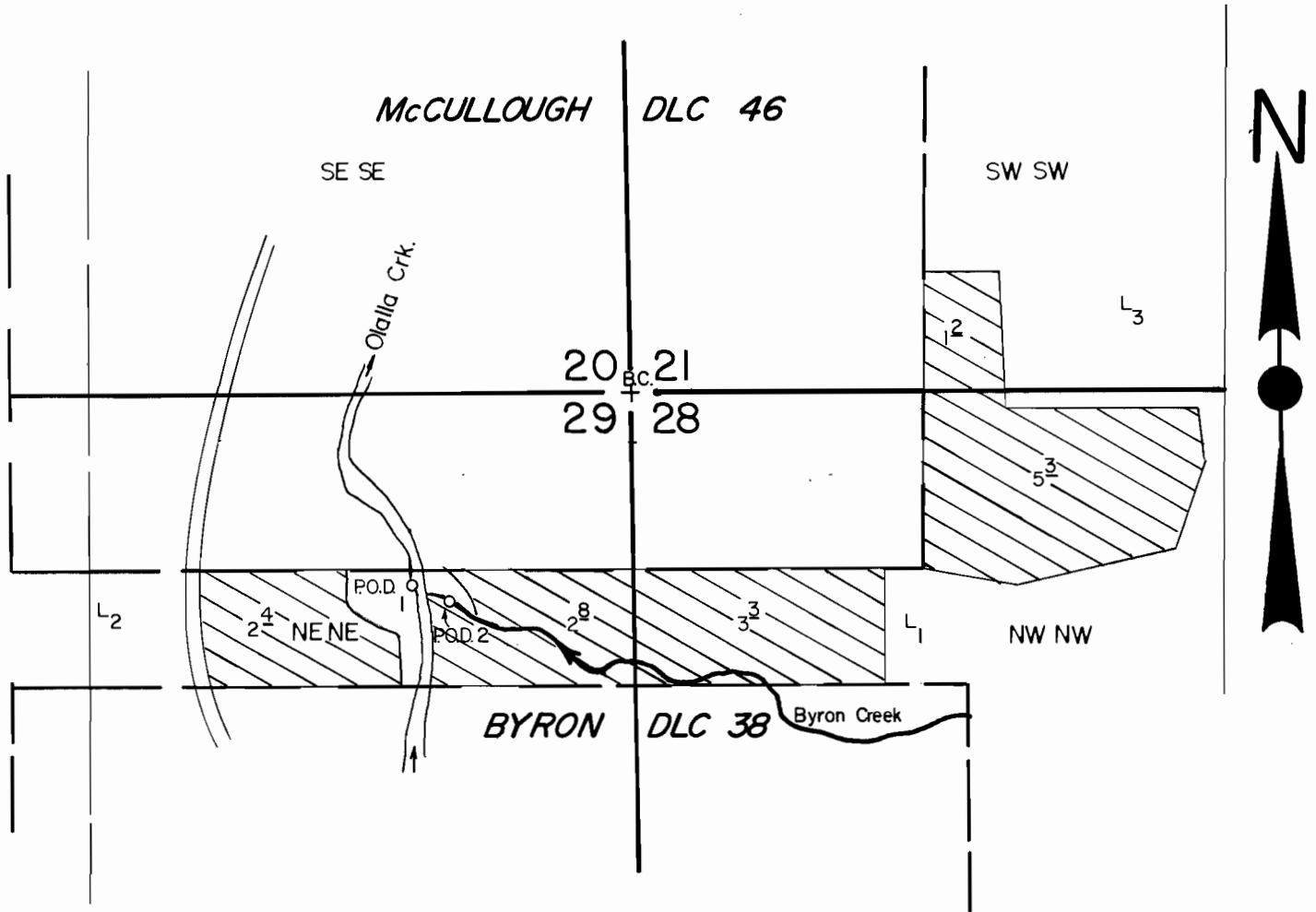

P.O.D. 1, ( App. 55128 ), Loc.: 430' S. & 500' W.

P.O.D. 2, ( App. 50493 ), Loc.: 470' S. & 415' W.

Scale: 1" = 400'

both from NE Cor. Sec. 29.

## FINAL PROOF SURVEY UNDER

50493                      38130

Application No. 55128... Permit No. 41393.....

IN NAME OF

A. HENRY STRAIN

Surveyed JUNE 4, 1979, by S. DONALDSON...