

T. 39 S., R. 3 E., W.M.

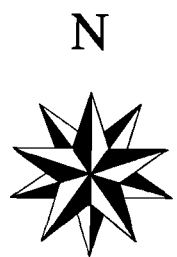
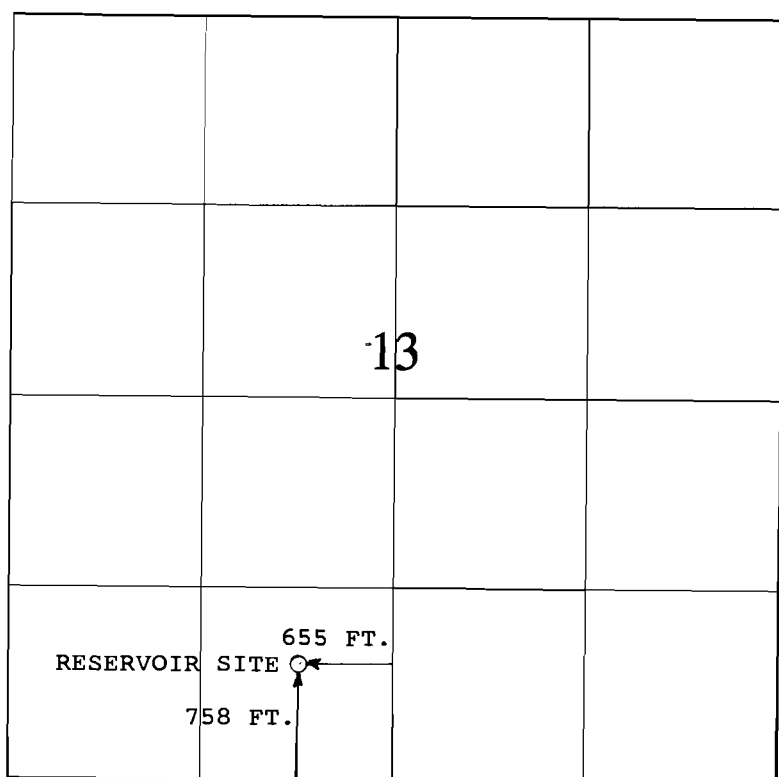

1 IN. = 1320 FT.

IRON PIPE AND BRASS CAP

RECEIVED

OCT 01 1993

WATER RESOURCES DEPT.
SALEM, OREGON

APPLICATION MAP

FOR

BEAVER CREEK #3

IN NAME OF

UNITED STATES BUREAU OF LAND MANAGEMENT

JUNE 2, 1993

THE PURPOSE OF THIS MAP IS FOR IDENTIFYING THE LOCATION OF THE WATER RIGHT ONLY AND IS NOT INTENDED TO PROVIDE LEGAL DIMENSIONS OR LOCATION OF PROPERTY OWNERSHIP LINES.

WRE 6058A OREGON

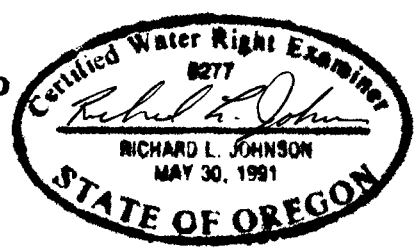

U.S. BUREAU OF LAND MANAGEMENT - OSO
BRANCH OF CADASTRAL SURVEY

LETTER OF AUTHORIZATION
DATED: MAY 3, 1993

EXECUTED BY:
RICHARD L. JOHNSON, PLS, CWRE

OR-942.1
P.O. BOX 2965
PORTLAND OR., 97208

No. R-73682
"CONTINGENT NO."

69001

T. 39 S., R. 3 E., W.M.

REBAR AND
ALUMINUM CAP

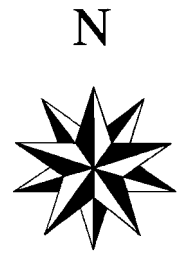
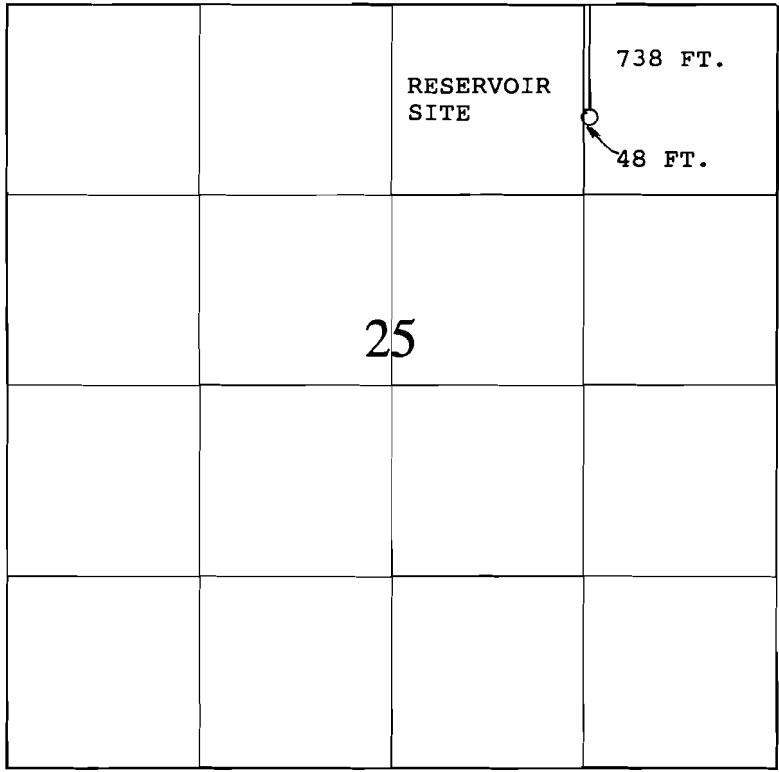

1 IN. = 1320 FT.

RECEIVED

OCT 01 1993

WATER RESOURCES DEPT.
SALEM, OREGON

APPLICATION MAP

FOR

CCC CAMP

IN NAME OF

UNITED STATES BUREAU OF LAND MANAGEMENT

JUNE 2, 1993

THE PURPOSE OF THIS MAP IS FOR IDENTIFYING THE LOCATION OF THE WATER RIGHT ONLY AND IS NOT INTENDED TO PROVIDE LEGAL DIMENSIONS OR LOCATION OF PROPERTY OWNERSHIP LINES.

WRE 6059A OREGON

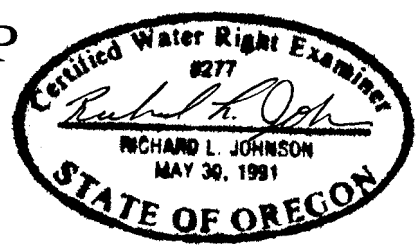

U.S. BUREAU OF LAND MANAGEMENT - OSO
BRANCH OF CADASTRAL SURVEY

EXECUTED BY:
RICHARD L. JOHNSON, PLS, CWRE

LETTER OF AUTHORIZATION
DATED: MAY 3, 1993

OR-942.1
P.O. BOX 2965
PORTLAND OR., 97208

T. 39 S., R. 3 E., W.M.

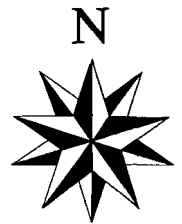
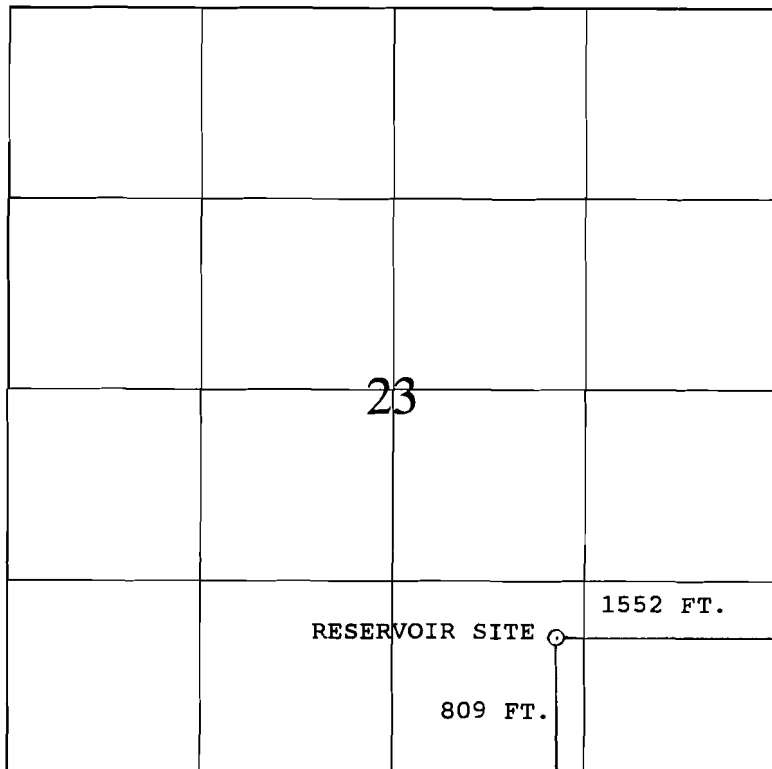

1 IN. = 1320 FT.

IRON PIPE AND BRASS CAP

APPLICATION MAP

FOR

ROBCO FREE

IN NAME OF

UNITED STATES BUREAU OF LAND MANAGEMENT

JUNE 7, 1993

THE PURPOSE OF THIS MAP IS FOR IDENTIFYING THE LOCATION OF THE WATER RIGHT ONLY AND IS NOT INTENDED TO PROVIDE LEGAL DIMENSIONS OR LOCATION OF PROPERTY OWNERSHIP LINES.

WRE 6063A OREGON

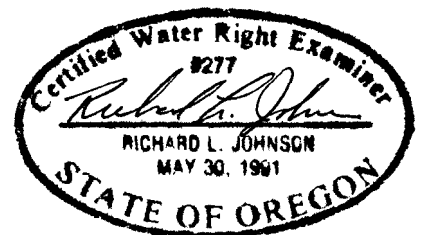
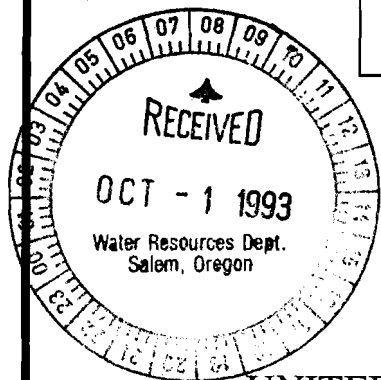

U.S. BUREAU OF LAND MANAGEMENT - OSO
BRANCH OF CADASTRAL SURVEY

EXECUTED BY:
RICHARD L. JOHNSON, PLS, CWRE

LETTER OF AUTHORIZATION
DATED: MAY 3, 1993

OR-942.1
P.O. BOX 2965
PORTLAND OR., 97208

T. 39 S., R. 3 E., W.M.

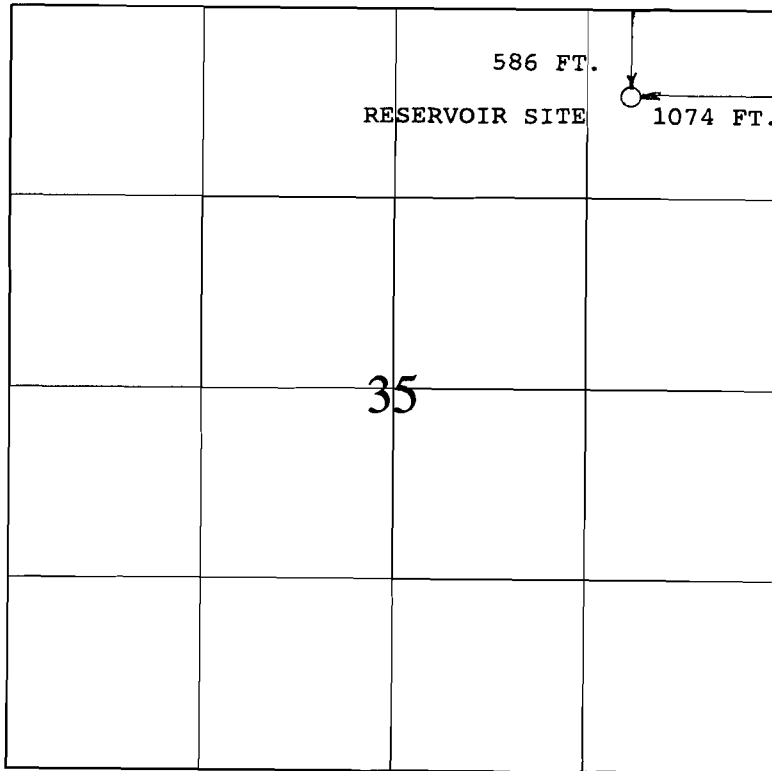

IRON PIPE AND BRASS CAP

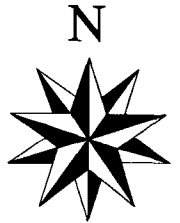

1 IN. = 1320 FT.

RECEIVED

OCT 01 1993

WATER RESOURCES DEPT.
SALEM, OREGON

APPLICATION MAP

FOR

EAST CHINQUAPIN MOUNTAIN

IN NAME OF

UNITED STATES BUREAU OF LAND MANAGEMENT

JUNE 7, 1993

THE PURPOSE OF THIS MAP IS FOR IDENTIFYING THE LOCATION OF THE WATER RIGHT ONLY AND IS NOT INTENDED TO PROVIDE LEGAL DIMENSIONS OR LOCATION OF PROPERTY OWNERSHIP LINES.

WRE 6064A OREGON

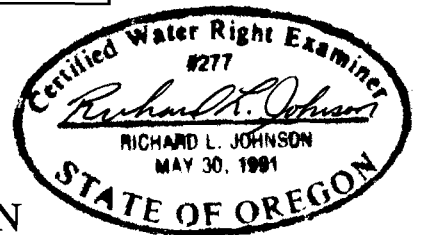

U.S. BUREAU OF LAND MANAGEMENT - OSO
BRANCH OF CADASTRAL SURVEY

EXECUTED BY:
RICHARD L. JOHNSON, PLS, CWRE

LETTER OF AUTHORIZATION
DATED: MAY 3, 1993

OR-942.1
P.O. BOX 2965
PORTLAND OR., 97208

Application # R 16382

RECEIVED

MAY - 5 1994

T. 39 S., R. 3 E., W.M.

WATER RESOURCES DEPT
SALEM, OREGON

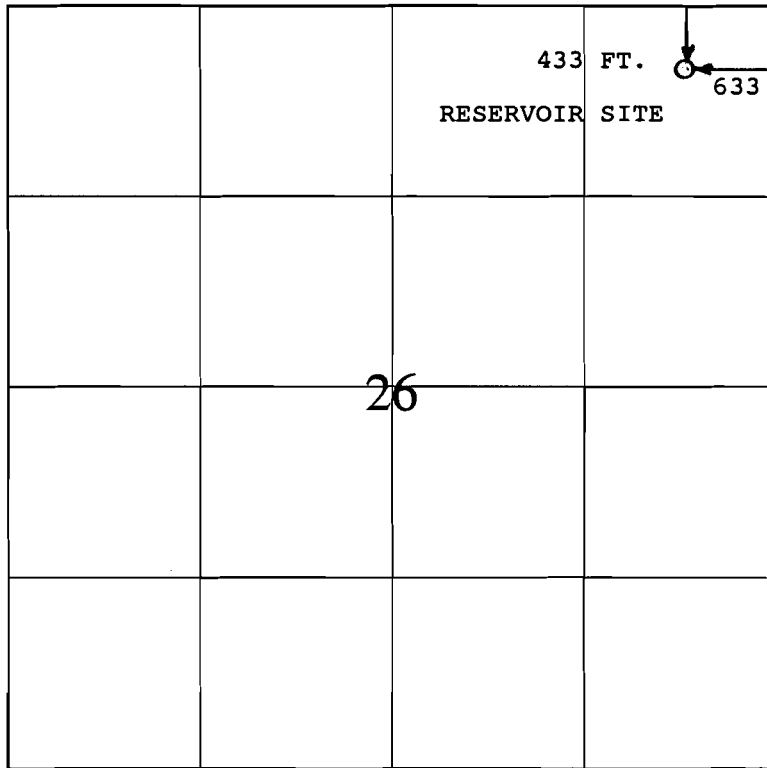

IRON PIPE AND
BRASS CAP

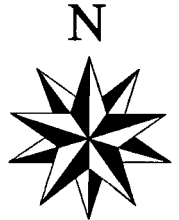

1 IN. = 1320 FT.

AMENDED APPLICATION MAP

FOR

EAST CHINQUAPIN MOUNTAIN

IN NAME OF

UNITED STATES BUREAU OF LAND MANAGEMENT

JUNE 7, 1993

THE PURPOSE OF THIS MAP IS FOR IDENTIFYING THE LOCATION OF THE WATER RIGHT ONLY AND IS NOT INTENDED TO PROVIDE LEGAL DIMENSIONS OR LOCATION OF PROPERTY OWNERSHIP LINES.

WRE 6064A OREGON

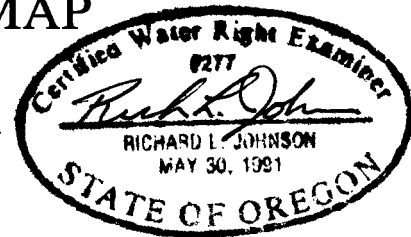

U.S. BUREAU OF LAND MANAGEMENT - OSO
BRANCH OF CADASTRAL SURVEY

EXECUTED BY:
RICHARD L. JOHNSON, PLS, CWRE

LETTER OF AUTHORIZATION
DATED: MAY 3, 1993

OR-942.1
P.O. BOX 2965
PORTLAND OR., 97208