

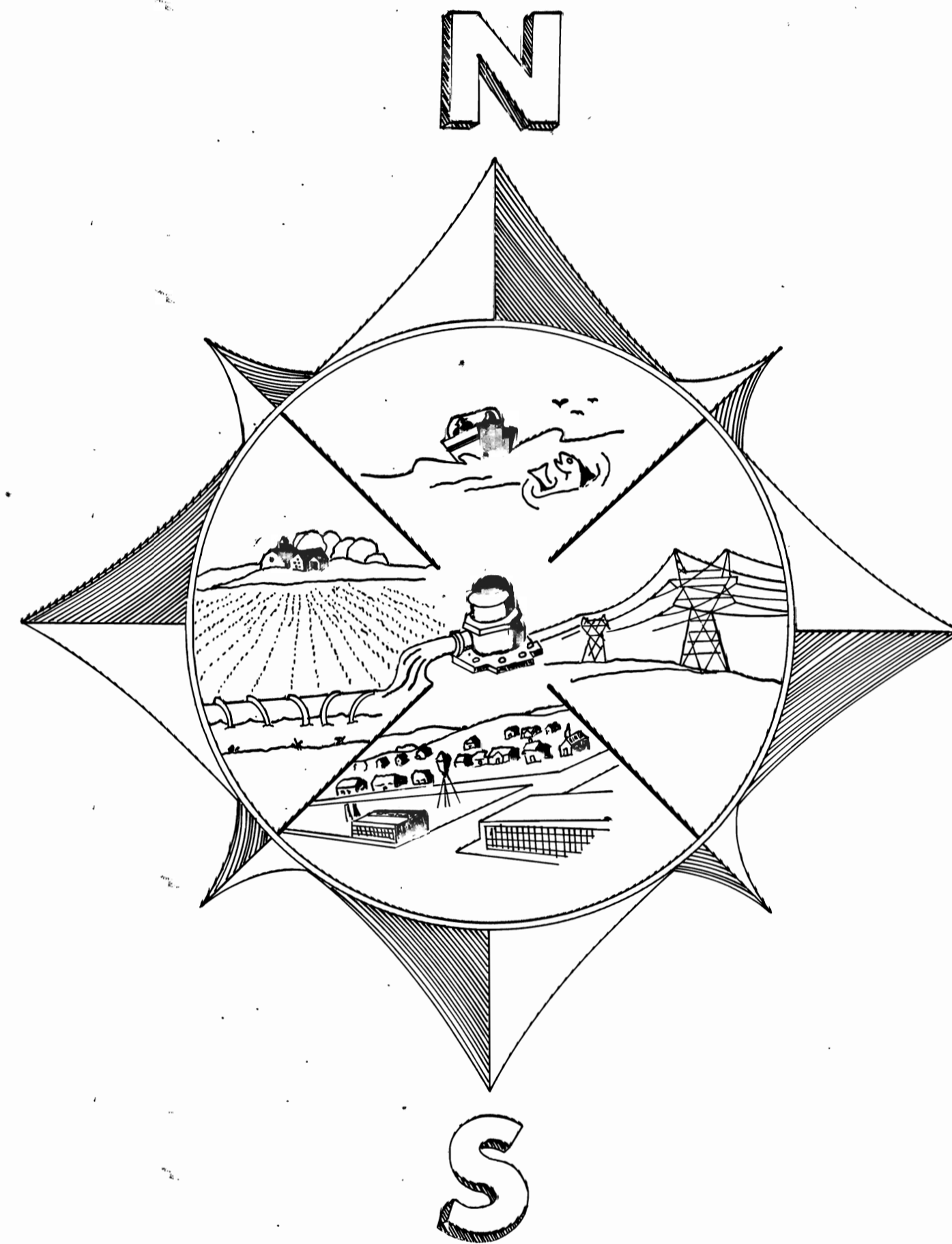

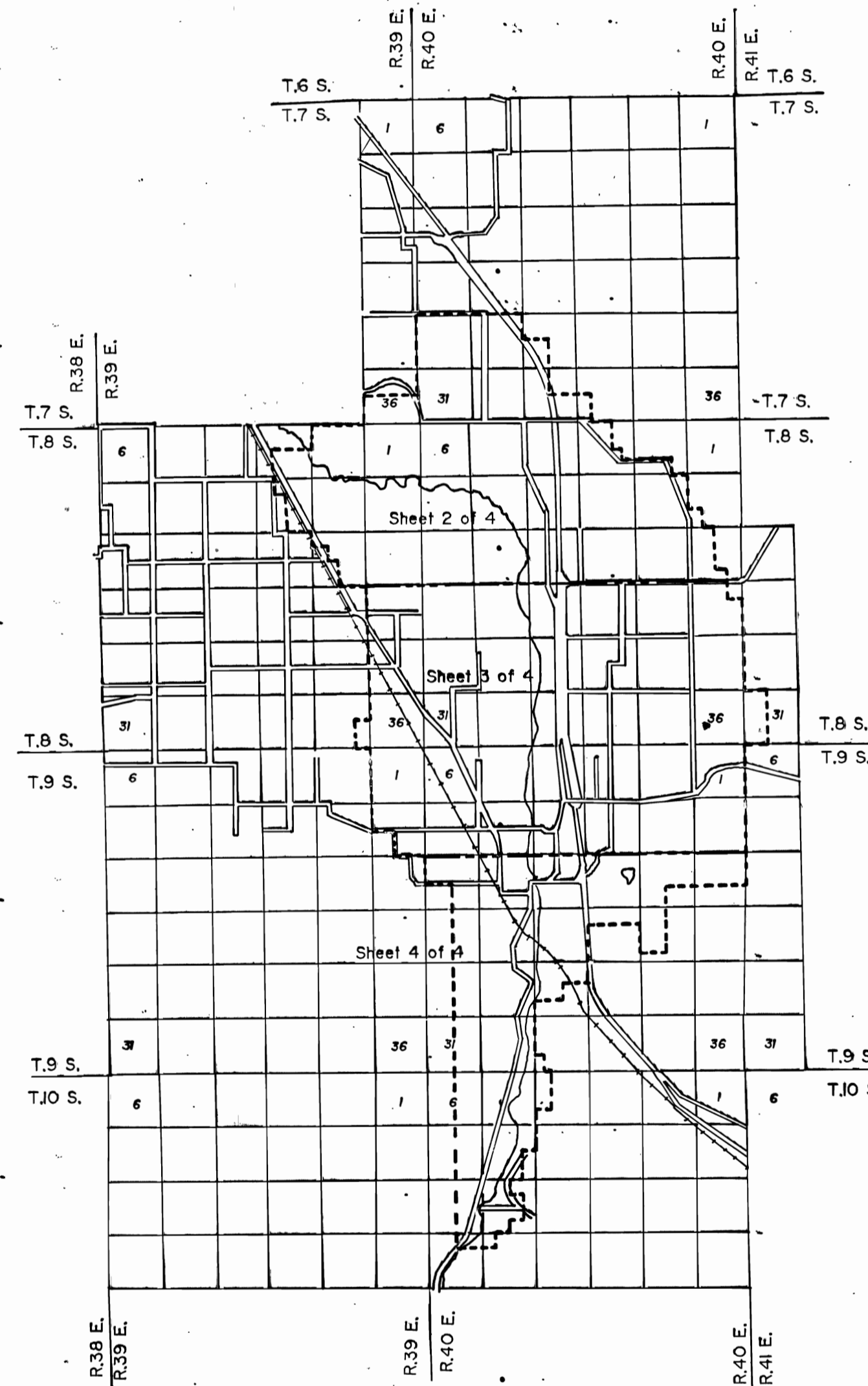

Points of Diversion



Map Index

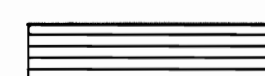

LEGEND

-  Application Number 62167--  
Primary Powder River, Supplemental Storage
-  Application Number 62167--  
Supplemental Storage
-  Application Number 62167--  
Supplemental Powder River and Storage
-  District Boundary

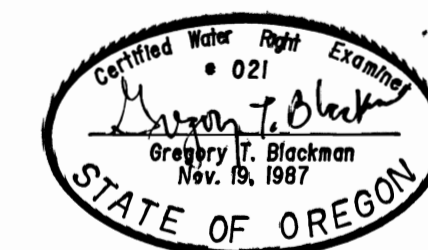

NOTE: The preparation of this map was for the purpose of identifying the location of the proposed water right and has no intent to provide dimensions or location of property ownership lines. Location information shown hereon was furnished by the applicant.

- MASON DAM**  
NW 1/4 NE 1/4, SECTION 25, 50 FEET SOUTH AND 1500 FEET WEST FROM NE CORNER SECTION 25, T 10 S., R 38 E., W.M.
- SMITH DITCH**  
NW 1/4 NE 1/4, SECTION 19, 945 FEET SOUTH AND 1865 FEET WEST FROM NE CORNER SECTION 19, T 10 S., R 40 E., W.M.
- SHAW-STEWART DITCH**  
NW 1/4 NE 1/4, SECTION 19, 570 FEET SOUTH AND 1900 FEET WEST FROM NE CORNER SECTION 19, T 10 S., R 40 E., W.M.
- CURRY DITCH**  
NW 1/4 NW 1/4, SECTION 17, 1270 FEET SOUTH AND 1170 FEET EAST FROM NW CORNER SECTION 17, T 10 S., R 40 E., W.M.
- MARSH-DICKINSON DITCH**  
NE 1/4 SW 1/4, SECTION 5, 1600 FEET NORTH AND 2350 FEET EAST FROM SW CORNER SECTION 5, T 10 S., R 40 E., W.M.
- BAMBERGER DITCH**  
SE 1/4 NE 1/4, SECTION 32, 2650 FEET SOUTH AND 690 FEET WEST FROM NE CORNER SECTION 32, T 9 S., R 40 E., W.M.
- SETTLERS SLOUGH DITCH**  
NW 1/4 SW 1/4, SECTION 21, 2160 FEET NORTH AND 30 FEET EAST FROM SW CORNER SECTION 21, T 9 S., R 40 E., W.M.
- BALDOCK-NEW-HOME DITCH**  
SW 1/4 NW 1/4, SECTION 16, 1700 FEET SOUTH AND 400 FEET EAST FROM NW CORNER SECTION 16, T 9 S., R 40 E., W.M.
- CORRAL DITCH**  
SW 1/4 NW 1/4, SECTION 9, 50 FEET NORTH AND 2720 FEET EAST FROM C 1/4 CORNER SECTION 8, T 9 S., R 40 E., W.M.
- ESTES WEST DITCH**  
NE 1/4 NE 1/4, SECTION 8, 110 FEET SOUTH AND 600 FEET WEST FROM NE CORNER SECTION 8, T 9 S., R 40 E., W.M.
- MCENROE EAST DITCH**  
NE 1/4 SE 1/4, SECTION 5, 2250 FEET NORTH AND 320 FEET WEST FROM SE CORNER SECTION 5, T 9 S., R 40 E., W.M.
- COMPANY EAST DITCH**  
SE 1/4 NE 1/4, SECTION 5, 1600 FEET SOUTH AND 280 FEET WEST FROM NE CORNER SECTION 5, T 9 S., R 40 E., W.M.
- COMPANY WEST DITCH**  
SE 1/4 NE 1/4, SECTION 5, 1600 FEET SOUTH AND 320 FEET WEST FROM NE CORNER SECTION 5, T 9 S., R 40 E., W.M.
- WENDT EAST DITCH**  
SW 1/4 SW 1/4, SECTION 33, 1000 FEET NORTH AND 600 FEET EAST FROM SW CORNER SECTION 33, T 8 S., R 40 E., W.M.
- POWERS EAST 2 DITCH**  
NW 1/4 SW 1/4, SECTION 33, 2640 FEET NORTH AND 850 FEET EAST FROM SW CORNER SECTION 33, T 8 S., R 40 E., W.M.
- POWERS EAST 1 DITCH**  
NW 1/4 SW 1/4, SECTION 33, 2650 FEET NORTH AND 850 FEET EAST FROM SW CORNER SECTION 33, T 8 S., R 40 E., W.M.
- POWERS WEST 1 DITCH**  
NW 1/4 SW 1/4, SECTION 33, 2650 FEET NORTH AND 800 FEET EAST FROM SW CORNER SECTION 33, T 8 S., R 40 E., W.M.
- PERKINS EAST 2**  
SE 1/4 NE 1/4, SECTION 20, 110 FEET NORTH AND 390 FEET WEST FROM EAST 1/4 CORNER SECTION 20, T 8 S., R 40 E., W.M.
- POWERS WEST 2 DITCH**  
SW 1/4 NW 1/4, SECTION 33, 2650 FEET NORTH AND 800 FEET EAST FROM SW CORNER SECTION 33, T 8 S., R 40 E., W.M.
- TAGGETT WEST DITCH**  
SE 1/4 NW 1/4, SECTION 28, 2650 FEET NORTH AND 1650 FEET EAST FROM SW CORNER SECTION 28, T 8 S., R 40 E., W.M.
- TAGGETT EAST DITCH**  
SE 1/4 NW 1/4, SECTION 28, 2650 FEET NORTH AND 1690 FEET EAST FROM SW CORNER SECTION 28, T 8 S., R 40 E., W.M.
- HARRISON DITCH**  
NE 1/4 NE 1/4, SECTION 20, 20 FEET SOUTH AND 1130 FEET WEST FROM NE CORNER SECTION 20, T 8 S., R 40 E., W.M.
- GREIR WEST DITCH**  
NE 1/4 NE 1/4, SECTION 17, 4460 FEET NORTH AND 920 FEET WEST FROM SE CORNER SECTION 17, T 8 S., R 40 E., W.M.
- GREIR EAST 2 DITCH**  
NE 1/4 NE 1/4, SECTION 17, 4470 FEET NORTH AND 880 FEET WEST FROM SE CORNER SECTION 17, T 8 S., R 40 E., W.M.
- GREIR EAST 3 DITCH**  
NE 1/4 NE 1/4, SECTION 17, 4470 FEET NORTH AND 880 FEET WEST FROM SE CORNER SECTION 17, T 8 S., R 40 E., W.M.
- BECK-COLTON WEST 2 DITCH**  
NE 1/4 SW 1/4, SECTION 8, 1700 FEET NORTH AND 2050 FEET EAST FROM SW CORNER SECTION 8, T 8 S., R 40 E., W.M.
- COLTON BECK EAST 2 DITCH**  
NE 1/4 SW 1/4, SECTION 8, 1740 FEET NORTH AND 2070 FEET EAST FROM SW CORNER SECTION 8, T 8 S., R 40 E., W.M.
- COLTON-BECK WEST 1 DITCH**  
SE 1/4 NW 1/4, SECTION 8, 2660 FEET NORTH AND 1390 FEET EAST FROM SW CORNER SECTION 8, T 8 S., R 40 E., W.M.
- COLTON BECK EAST 1 DITCH**  
SE 1/4 NW 1/4, SECTION 8, 2670 FEET NORTH AND 1430 FEET EAST FROM SW CORNER SECTION 8, T 8 S., R 40 E., W.M.
- COLTON-LAZY J.W.2 DITCH**  
SE 1/4 NE 1/4, SECTION 7, 1470 FEET SOUTH AND 40 FEET WEST FROM NE CORNER SECTION 7, T 8 S., R 40 E., W.M.
- COLTON-LAZY J.W.1 DITCH**  
NE 1/4 NE 1/4, SECTION 7, 420 FEET SOUTH AND 1240 FEET WEST FROM NE CORNER SECTION 7, T 8 S., R 40 E., W.M.
- COLTON-LAZY J.E.2 DITCH**  
NE 1/4 NE 1/4, SECTION 7, 390 FEET SOUTH AND 1200 FEET WEST FROM NE CORNER SECTION 7, T 8 S., R 40 E., W.M.
- COLTON-LAZY J.E.1 DITCH**  
NE 1/4 NE 1/4, SECTION 7, 390 FEET SOUTH AND 1200 FEET WEST FROM NE CORNER SECTION 7, T 8 S., R 40 E., W.M.
- LILLEY DITCH**  
NE 1/4 NE 1/4, SECTION 11, 270 FEET SOUTH AND 340 FEET WEST FROM NE CORNER SECTION 11, T 8 S., R 39 E., W.M.
- MCKITRICK PUMP**  
NE 1/4 NW 1/4, SECTION 17, 10 FEET SOUTH AND 1570 FEET EAST FROM NW CORNER SECTION 17, T 10 S., R 40 E., W.M.
- EPPINGER**  
NE 1/4 SE 1/4, SECTION 8, 40 FEET SOUTH AND 2640 FEET EAST FROM CENTER OF SECTION 8, T 9 S., R 40 E., W.M.

FINAL PROOF SURVEY

UNDER  
Application Number 62167  
Permit Number 50696

PREPARED FOR:  
Baker Valley Irrigation District

BAGETT-GRIFFITH & ASSOCIATES  
LaGrande, Oregon

SCALE: 1"=1320'

T. 7 & 8 S., R. 39 & 40 E., W.M.

LEGEND

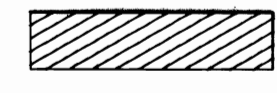
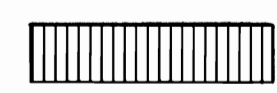
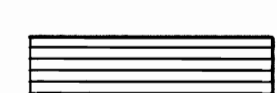
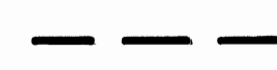
-  Application Number 62167-- Primary Powder River, Supplemental Storage
-  Application Number 62167-- Supplemental Storage
-  Application Number 62167-- Supplemental Powder River and Storage
-  District Boundary

RECEIVED  
 APR 7 1993  
 WATER RESOURCES DEPT.  
 SALEM, OREGON

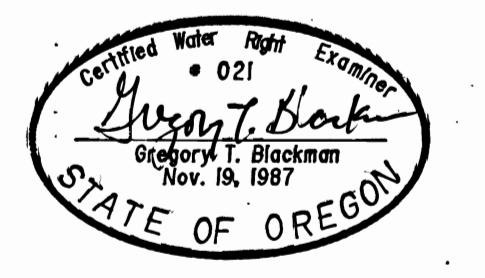

NOTE: The preparation of this map was for the purpose of identifying the location of the proposed water right and has no intent to provide dimensions or location of property ownership lines. Location information shown hereon was furnished by the applicant.

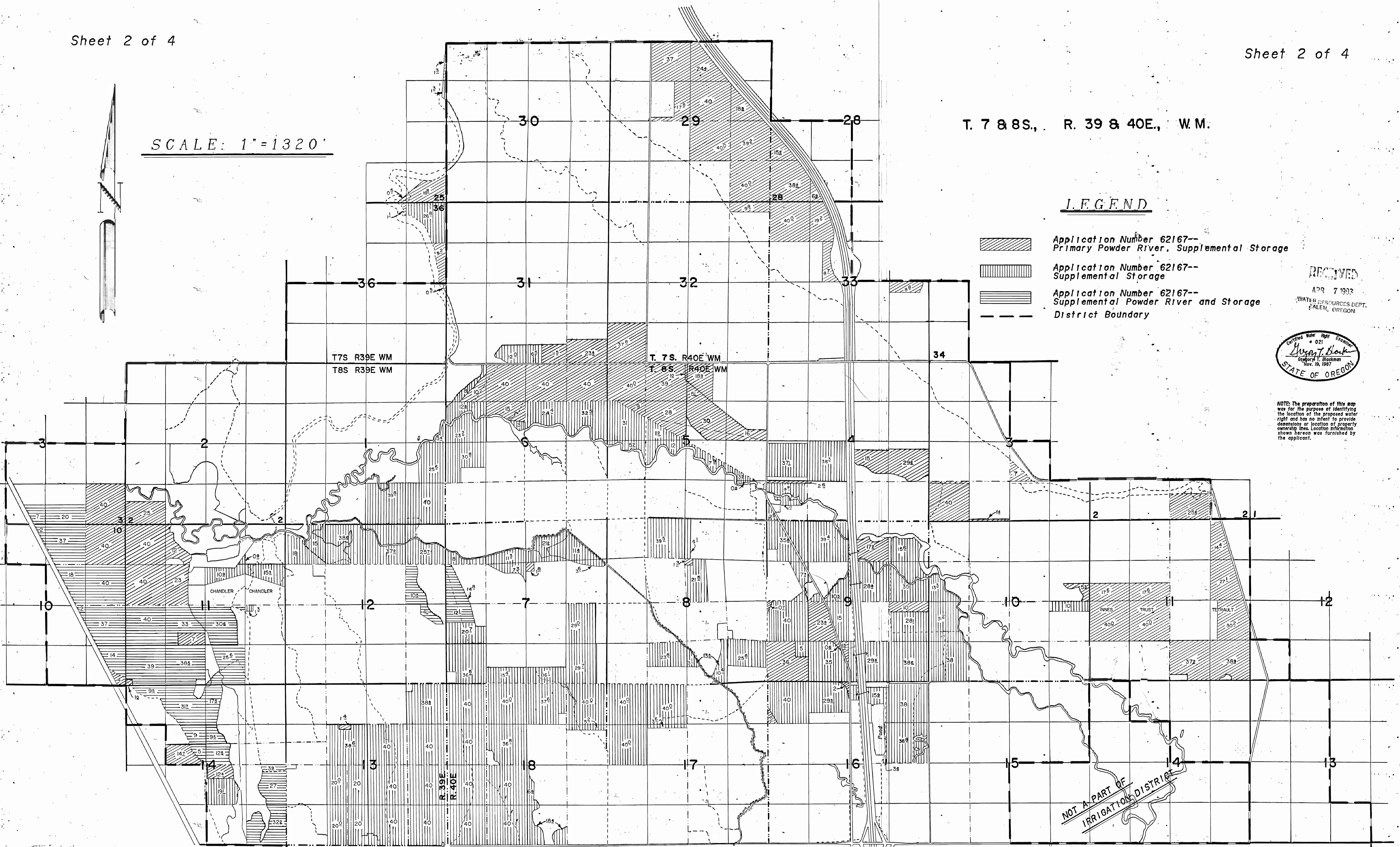

NOT A PART OF  
 IRRIGATION DISTRICT

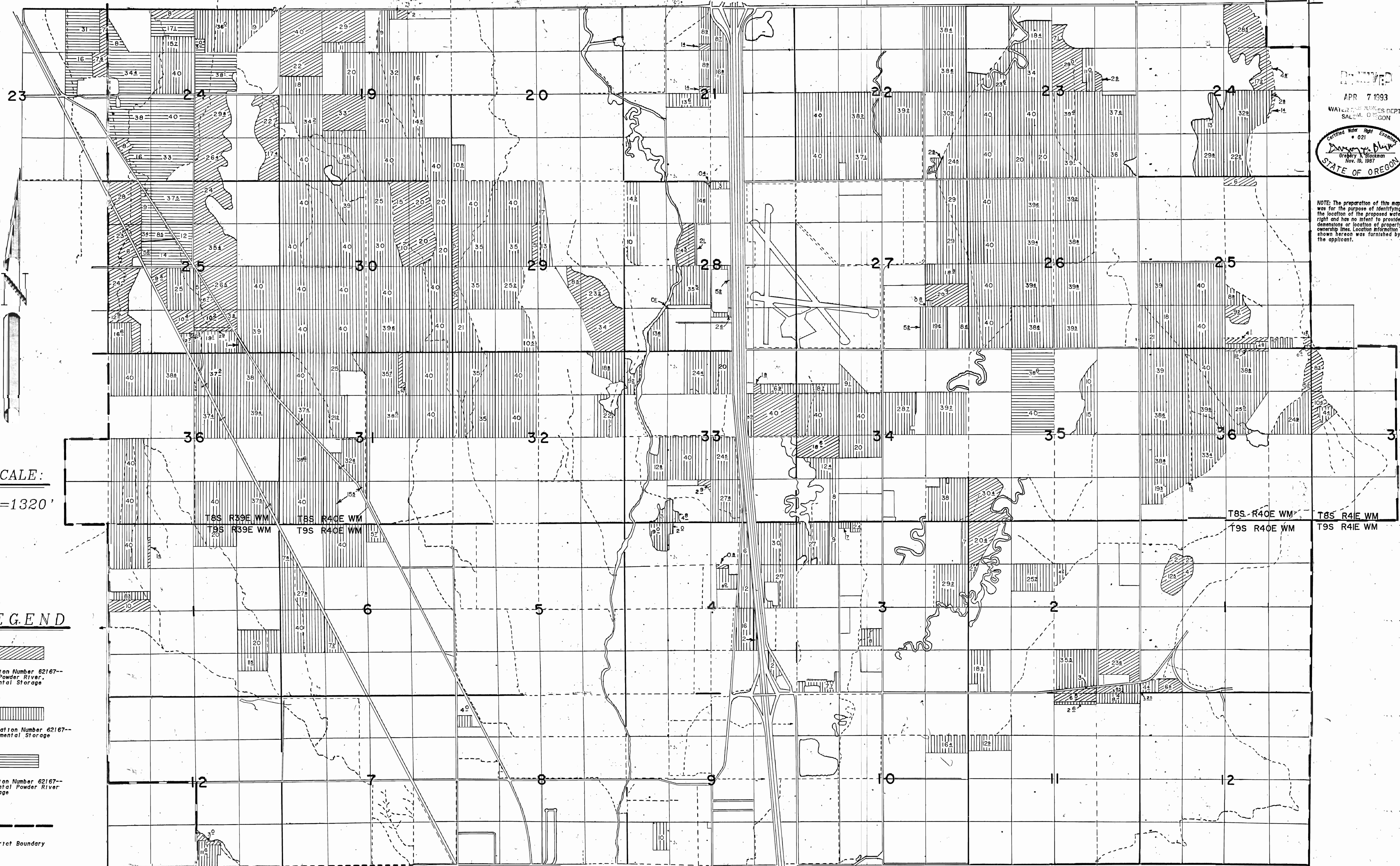



APR 7 1993  
 WATER RESOURCES DEPT.  
 SALEM, OREGON

Certified Water Right Examiner  
 # 021  
*Gregory A. Blackman*  
 Nov. 18, 1987  
 STATE OF OREGON

NOTE: The preparation of this map was for the purpose of identifying the location of the proposed water right and has no intent to provide dimensions or location of property ownership lines. Location information shown hereon was furnished by the applicant.

SCALE:  
 1" = 1320'

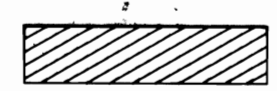
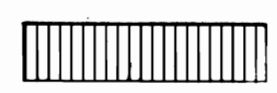
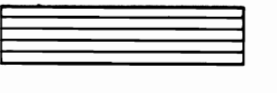

**LEGEND**

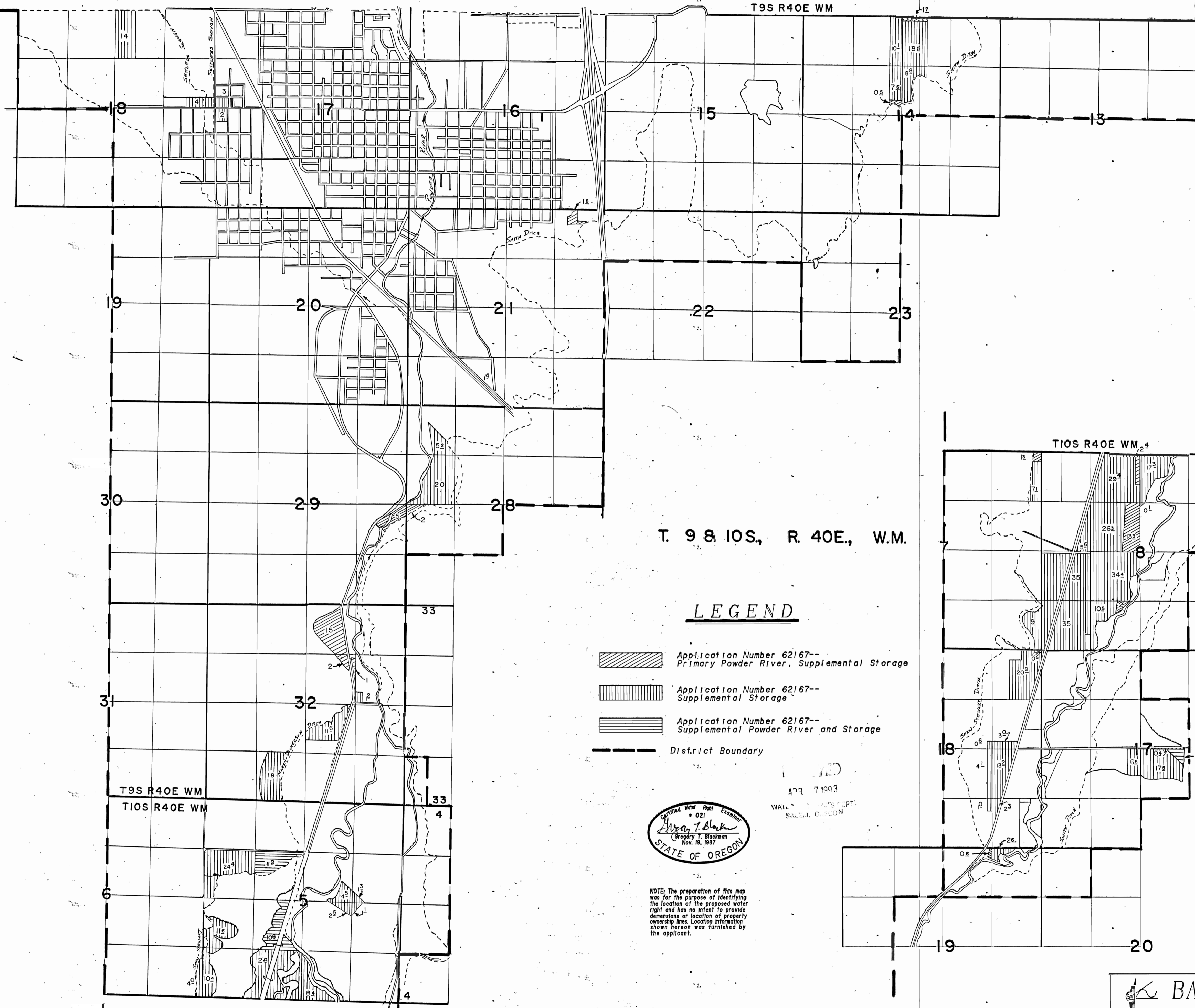
-  Application Number 62167--  
Primary Powder River  
Supplemental Storage
-  Application Number 62167--  
Supplemental Storage
-  Application Number 62167--  
Supplemental Powder River  
and Storage
-  District Boundary



T. 9 S. 10 S., R. 40 E., W.M.

LEGEND

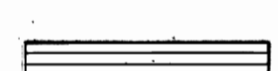
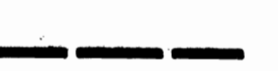
-  Application Number 62167--  
Primary Powder River, Supplemental Storage
-  Application Number 62167--  
Supplemental Storage
-  Application Number 62167--  
Supplemental Powder River and Storage
-  District Boundary



NOTE: The preparation of this map was for the purpose of identifying the location of the proposed water right and has no intent to provide dimensions or location of property ownership lines. Location information shown hereon was furnished by the applicant.

APR 7 1988  
WATER RIGHTS DIVISION  
SACRAMENTO, CALIFORNIA

SCALE: 1"=1320'