

T.33S., R.2E., W.M.

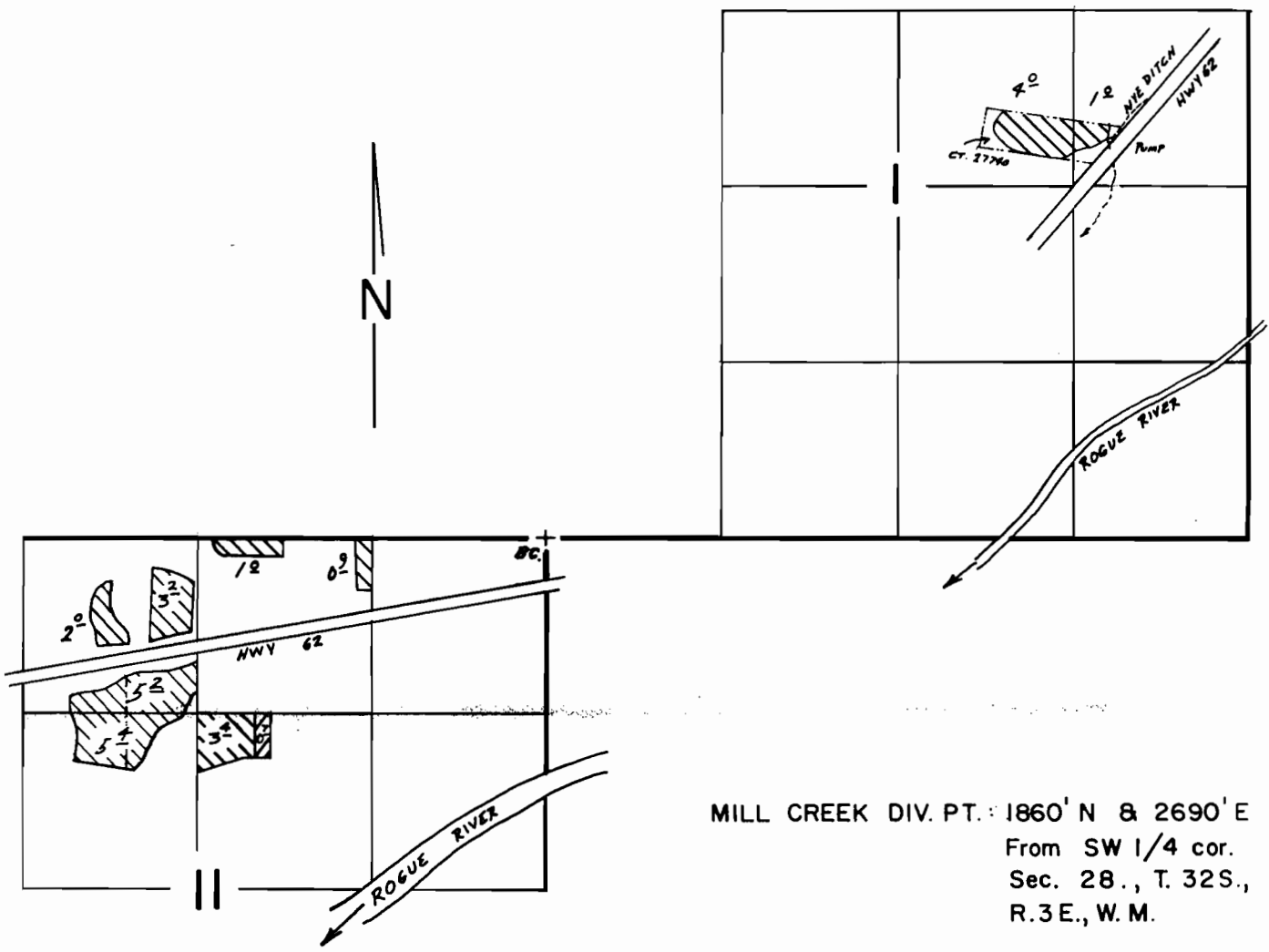

MILL CREEK DIV. PT.: 1860' N & 2690' E
 From SW 1/4 cor.
 Sec. 28., T. 32S.,
 R. 3E., W. M.

- PRIMARY
- SUPPLEMENTAL

Scale 1" = 1320'

FINAL PROOF SURVEY UNDER

Transfer No. 2624

Application No. Permit No.
 IN NAME OF

.....
 Surveyed Oct. 28, 1985, by B.S. JAMES.....

T. 33 S., R. 2 E., W. M.

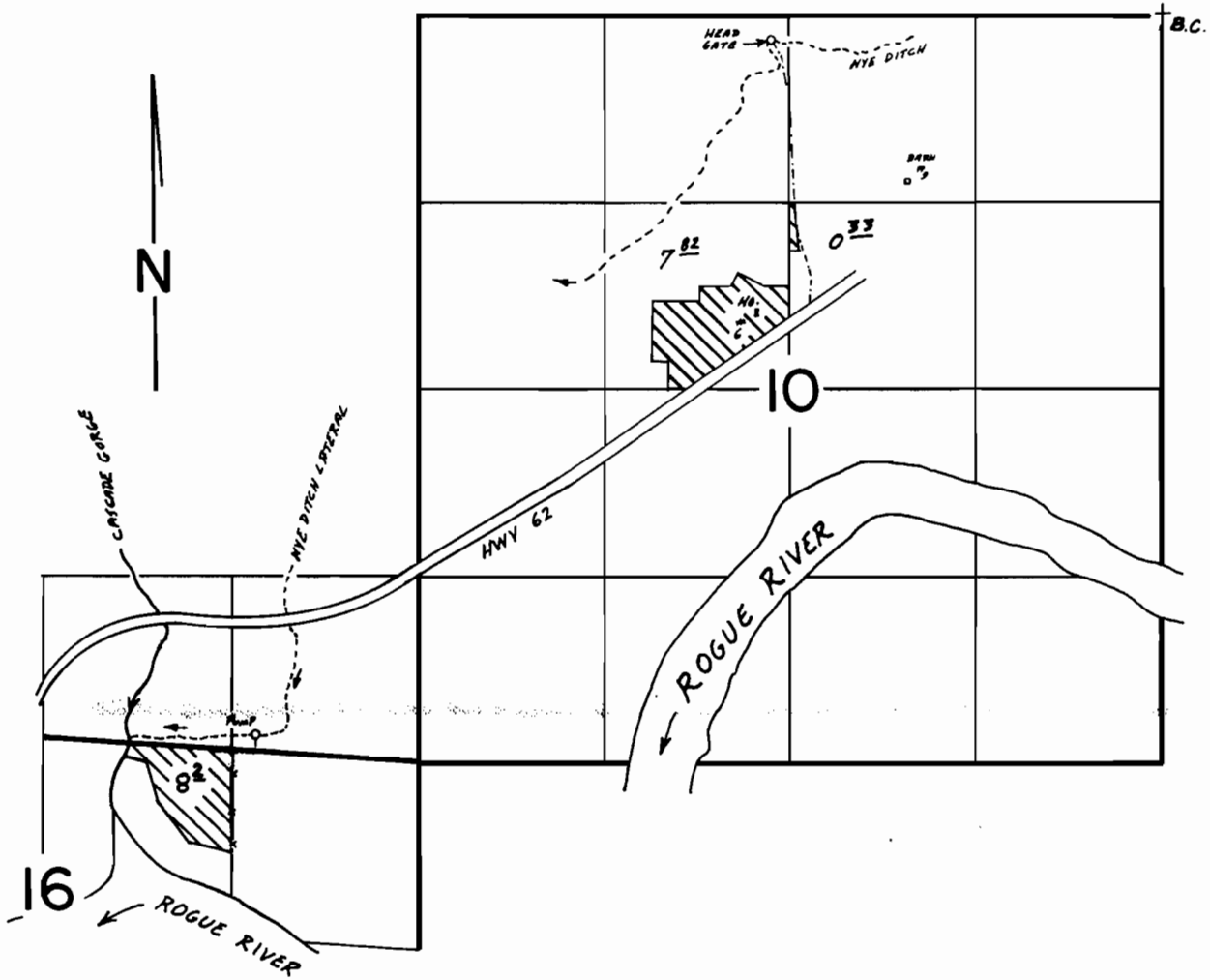

Scale 1"=1320'

FINAL PROOF SURVEY UNDER

Transfer No. 2624

Application No. Permit No.
IN NAME OF

.....
Surveyed Oct. 28, 1985, by B.S. JAMES