

T. 1 S., R. 10 E., W.M.

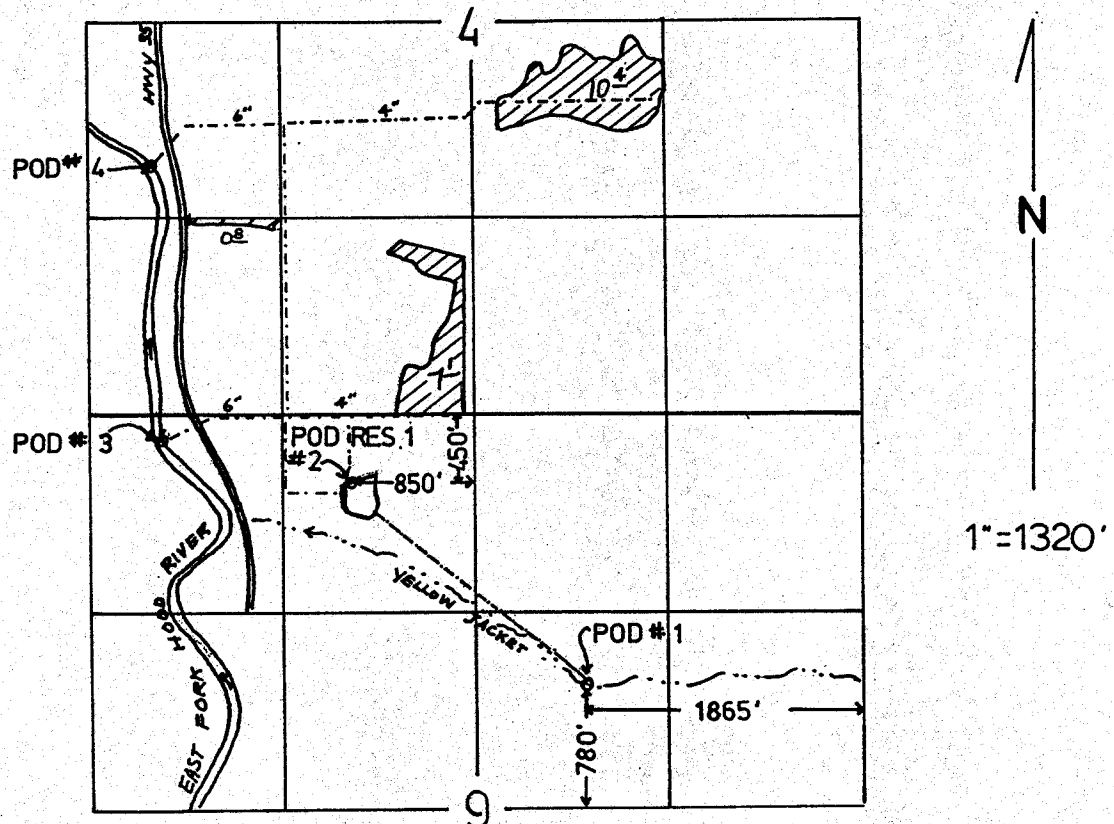

POD NO. 3 - 165° S. AND 455' E. FROM N.W. COR. SEC. 9.
POD NO. 4 - 1020° S. AND 2140' W. FROM CEN. COR. SEC. 4.

FINAL PROOF SURVEY

UNDER

63760

47448

Application No. R-64548 Permit No. R-8667

IN NAME OF

JOHN JACOBSON

Surveyed 10-9, 1991, by J. MILLER