

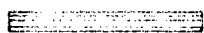

T.6S.R.3 W. W.M.

-  P.G. 2083 From West Well (no. 3)
-  P. G 2083 from 2 Wells (no. 1 & 2)
-  P. 27951 from Creek & Lake
-  P 27951 Supp. from Lake
-  P.G. 2083 from Oldenburg well

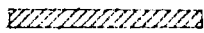
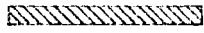

Wells 1,2 & 3 located #1-1480 ft. S. & 1240 ft. E.; #2-2170 ft. S. & 1040 ft. E.; #3-1750 ft. S. & 20 ft. E.; ALL from the NW. cor. A. Smith D.L.C. #69. Clear Lake Div. Pt. located 1960 ft. W. & 700 ft. S.; Clagget Cr. Div. Pt. located 310 ft. W. & 1280 ft. S.; Oldenburg well located 20 ft. E. & 580 ft. S. All from the NE cor. A. Smith D.L.C. #69.

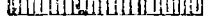
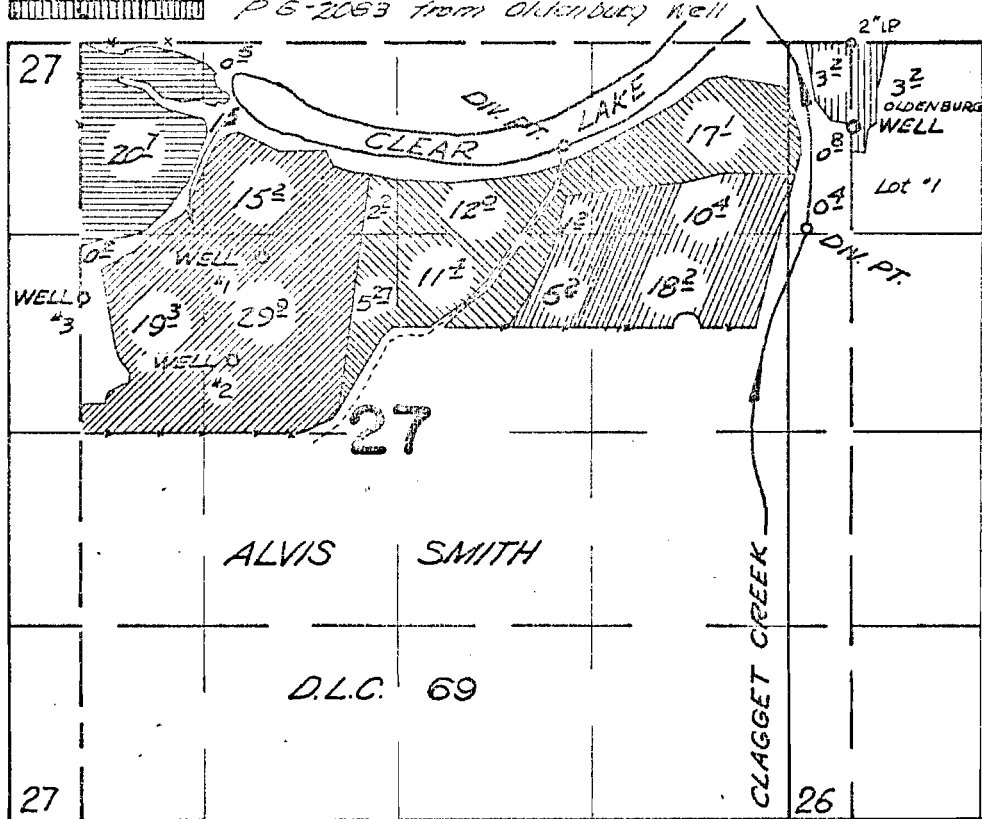
FINAL PROOF SURVEY UNDER

G 2271 G 2083
Application No. 37503 Permit No. 27951
IN NAME OF

GORDON TURNIDGE

Surveyed Oct. 19, 1966, by V. GARNER