

48169
74781

RECEIVED

SEP 23 1983

WATER RESOURCES DEPT.
SALEM, OREGON

UNITED STATES
DEPARTMENT OF THE INTERIOR
BUREAU OF LAND MANAGEMENT

SECTION 13
SE 1/4 NW 1/4

Oregon State Water Filings

TOWNSHIP 40S., RANGE 3E., W. M.

Application No. R-66705, 66706

Permit No. R 9254 48169

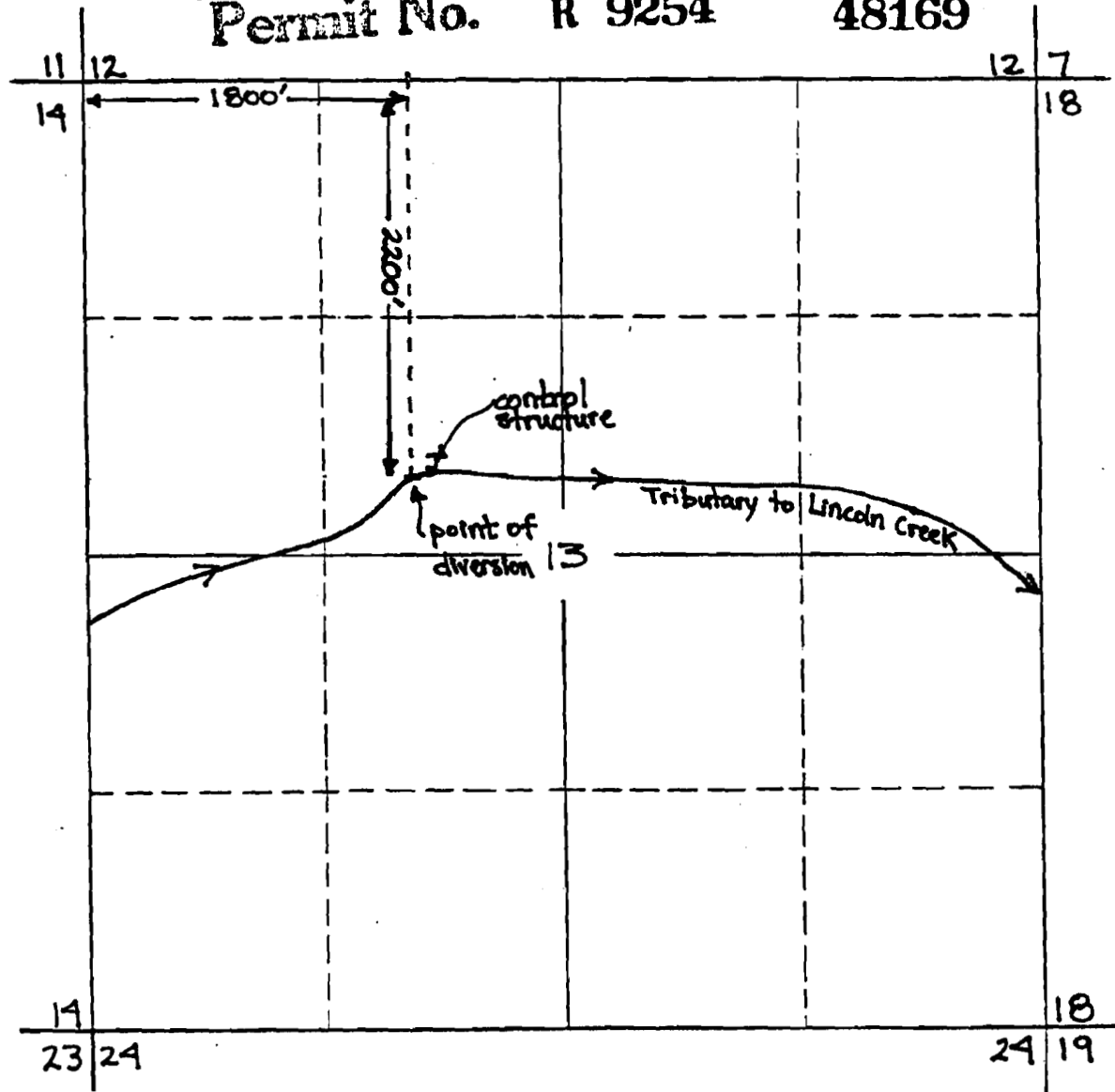

SCALE : 1" = 1000'

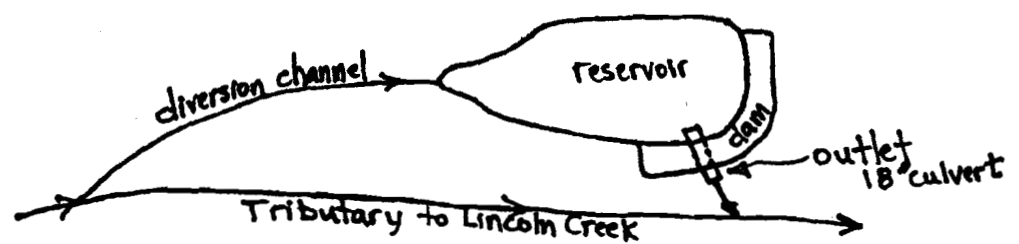

Enlargement of Diversion & Reservoir