

# APPLICATION MAP FOR PERMIT TO CONSTRUCT A RESERVOIR

**Application No. 12-73661**  
**Permit No.**

**"CERTIFICATE NO. 68986"**

**RECEIVED**  
**SEP 30 1993**  
WATER RESOURCES DEPT.  
SALEM, OREGON

**OVERTOP (48-5206) RESERVOIR**  
SE1/4 SW 1/4, SEC. 27, T. 21S., R. 38E., W.M.  
U.S.G.S. QUAD - JUNTURA, OREG. - 7 1/2'

**CRUMENT (48-5454) RESERVOIR**  
NW1/4 NE1/4, SEC. 34, T. 21S., R. 38E., W.M.  
U.S.G.S. QUAD - JUNTURA, OREG. - 7 1/2'

**BULL CANYON HEADWATER (48-5908) RESERVOIR**  
SE1/4 NE1/4, SEC. 34, T. 21S., R. 38E., W.M.  
U.S.G.S. QUAD - JUNTURA, OREG. - 7 1/2'

**ANTELOPE SPRING (48-0418) RESERVOIR**  
NW1/4 NW1/4, SEC. 33, T. 21S., R. 38E., W.M.  
U.S.G.S. QUAD - JUNTURA, OREG. - 7 1/2'

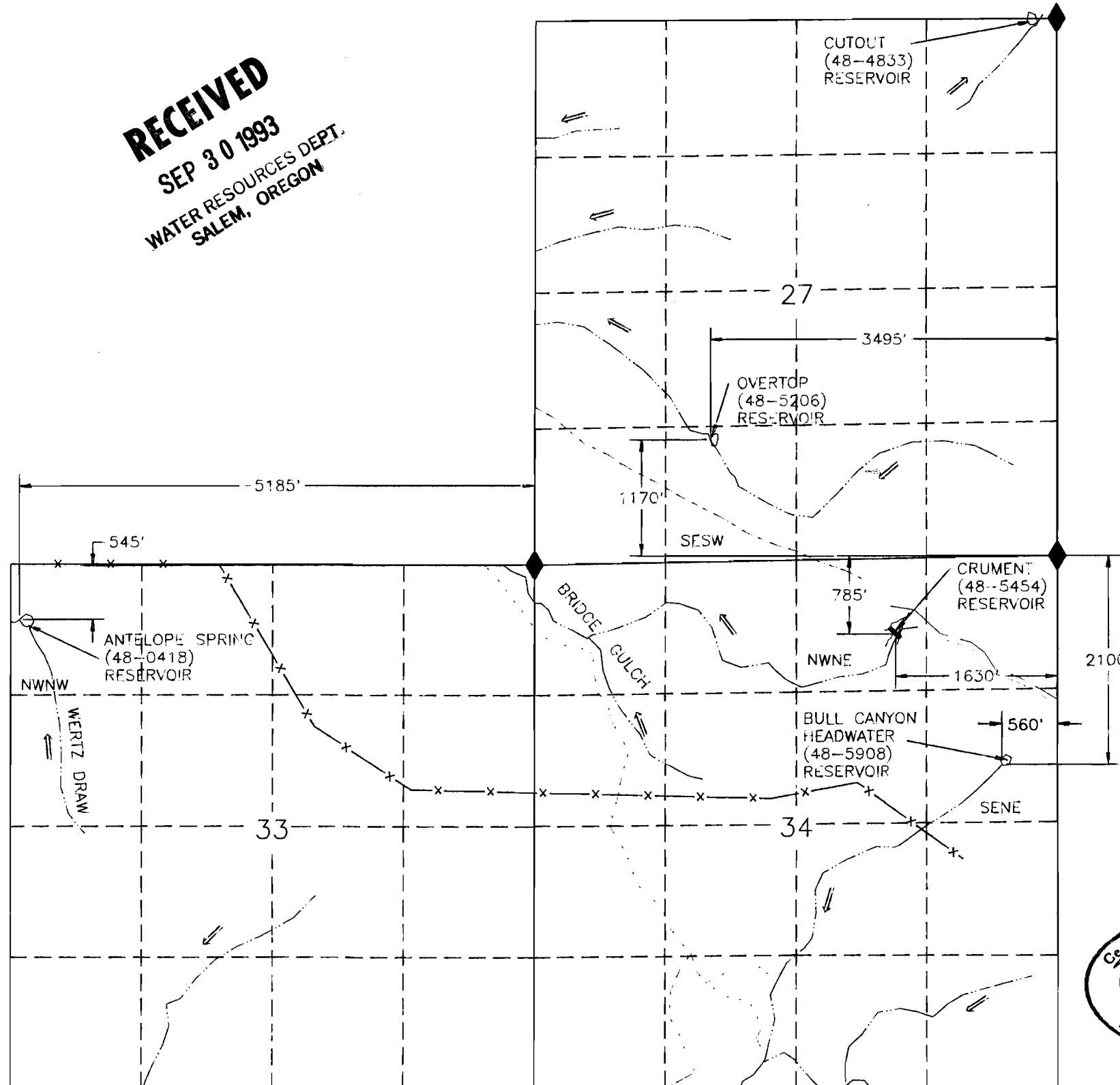

### LEGEND

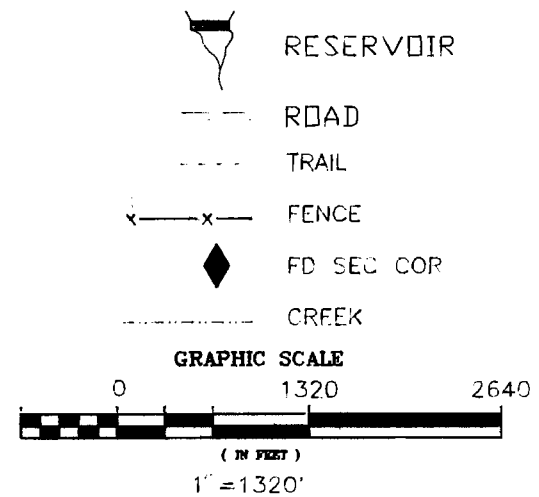

Certified Water Right Examiner  
#182  
*Vernon R. Pritchard*  
Vernon R. Pritchard  
May 17, 1983  
STATE OF OREGON



UNITED STATES DEPARTMENT OF THE INTERIOR  
BUREAU OF LAND MANAGEMENT  
DIVISION OF OPERATIONS VALE DISTRICT

RESERVOIRS LOCATED IN  
SEC. 27, 33 & 34, T. 21S., R. 38E., W.M.

DESIGNED \_\_\_\_\_  
REVIEWED *Vernon R. Pritchard*  
APPROVED *George House*  
CHIEF, BRANCH OF ENGINEERING

DRAWN: \_\_\_\_\_ SCALE: \_\_\_\_\_

DATE: 8/20/83 SHEET 1 OF 1

ACAD RELEASE 11  
DWG FILE: CRUMEN.DWG

DRAWING NO. 12-73661-1