

APPLICATION MAP FOR PERMIT TO CONSTRUCT A RESERVOIR

SE1/4 SW1/4 SEC 11 T 23S R 38E W.M.

U.S.G.S. QUAD - MOSQUITO MOUNTAIN, OREG. - 7 1/2'

RECEIVED

OCT 04 1993

WATER RESOURCES DEPT.
SALEM, OREGON

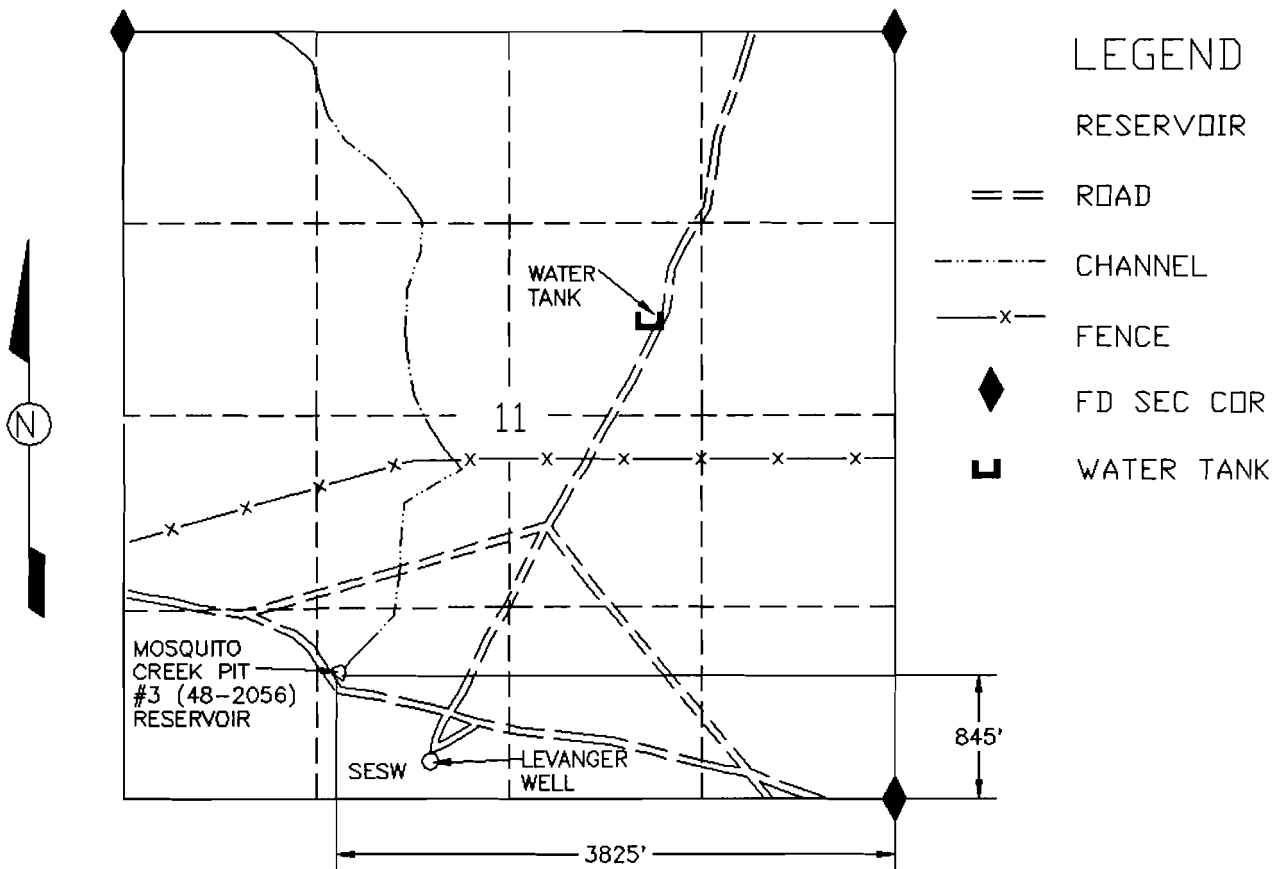

LEGEND

RESERVOIR

== ROAD

..... CHANNEL

—x— FENCE

◆ FD SEC COR

┌ WATER TANK

MOSQUITO CREEK PIT #3 (48-2056) RESERVOIR

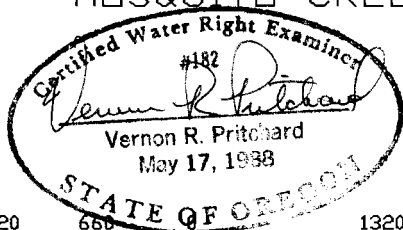

SCALE 1"=1320'

THIS MAP IS FOR THE PURPOSE OF LOCATING A WATER RIGHT AND IS NOT INTENDED TO PROVIDE LEGAL DIMENSIONS FOR LOCATION OF PROPERTY BOUNDARIES.



UNITED STATES DEPARTMENT OF THE INTERIOR
BUREAU OF LAND MANAGEMENT
DIVISION OF OPERATIONS VALE DISTRICT

MOSQUITO CREEK PIT #3 (48-2056) RESERVOIR

DESIGNED		
REVIEWED	<i>Vernon R. Pritchard</i>	
APPROVED	<i>George D. House</i> CHIEF, BRANCH OF ENGINEERING	
DRAWN:	CG	SCALE: 1"=1320'
DATE:	09/21/93	SHEET 1 OF 1
DRAWING NO.	DR-03-9172.45-433	

ACAD RELEASE 11/DCA
DWG FILE: MOSQ3APP

R-73725

0028