

T. 31 N., R. 29 E., W.M.

G6010
61531

87314

FINAL PROOF SURVEY

UNDER



APPL. G-7311 PER. G-7078 (Map 2 of 2)

G-79233
G-66773

IN NAME OF
THE TRAVELERS INS. CO.

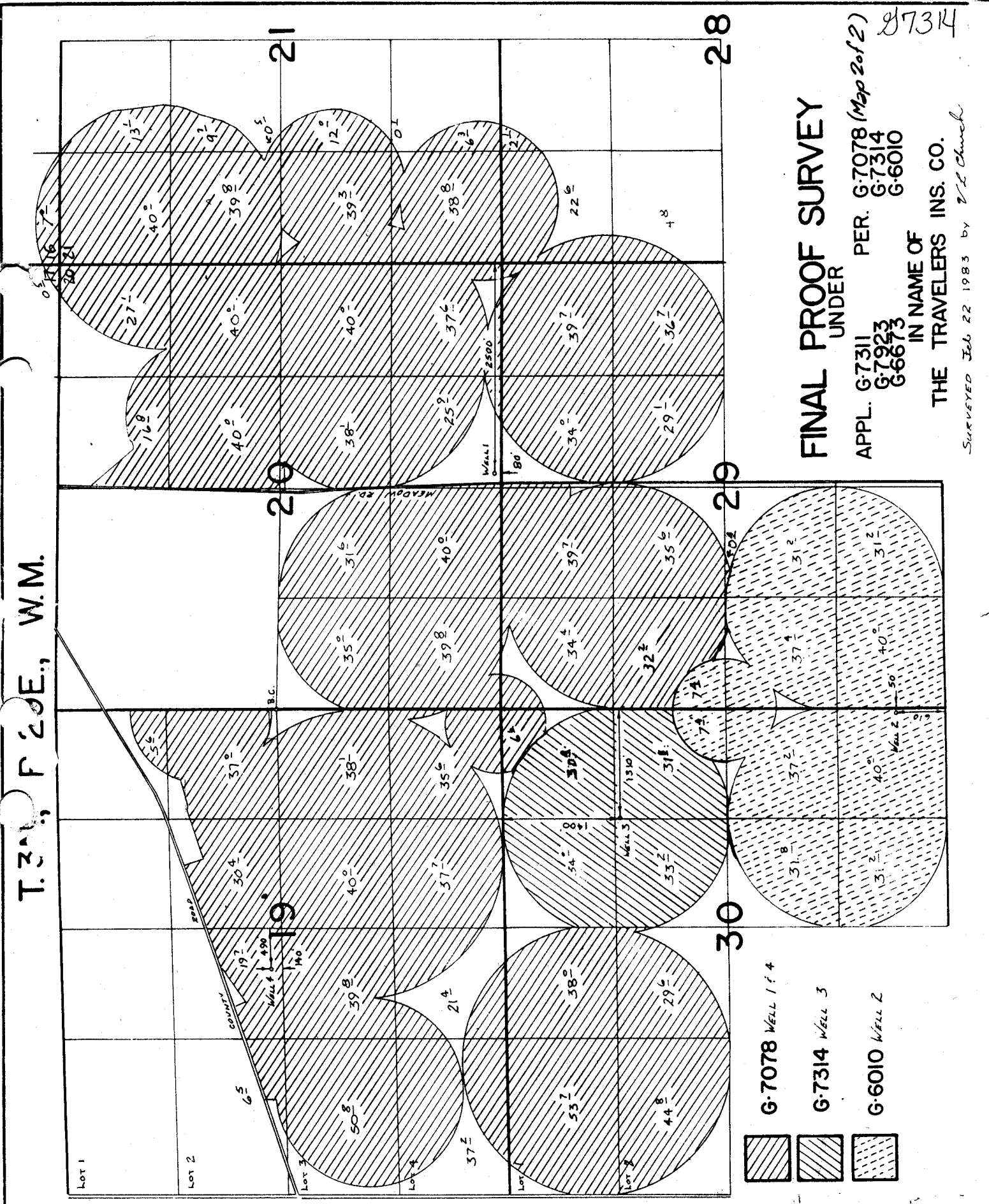
SURVEYED Feb 22 1983 by J.L. Church



-  G-7078 WELL 1 & 4
-  G-7314 WELL 3
-  G-6010 WELL 2