

T. 4N., R. 29E., W.M.

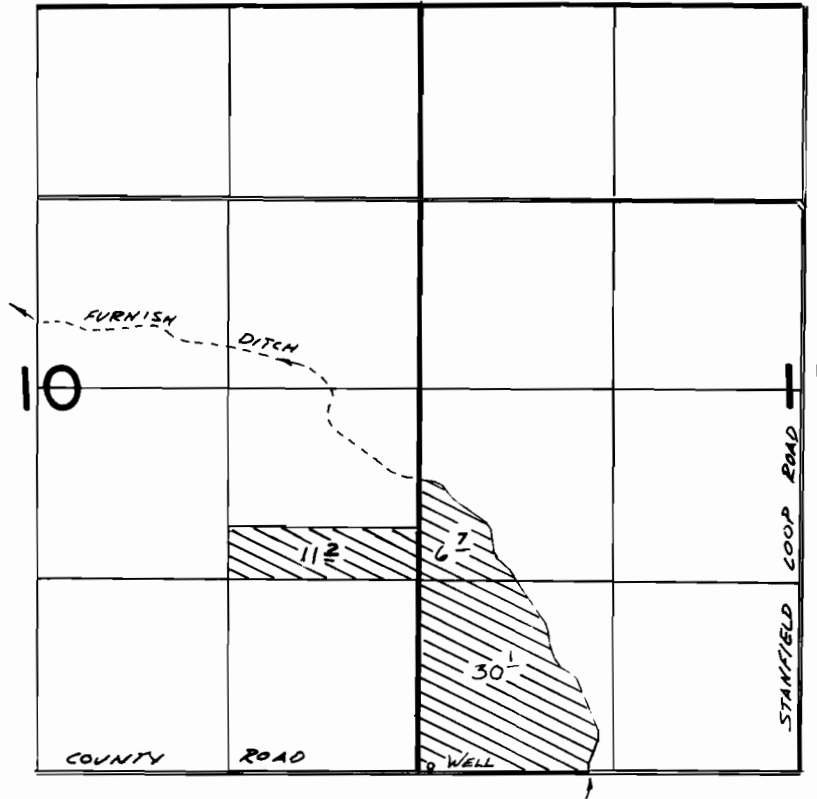

WELL LOC: 40' N. & 80' E FROM SW COR. SEC 11

FINAL PROOF SURVEY
UNDER

Application No. **G:10128** Permit No. **G:9307**
IN NAME OF

..... **IVAN J. COOK**

Surveyed *Dec. 7* 19*82*, by *V. Church*