

T. 27 S., R. 12 W., W. M.

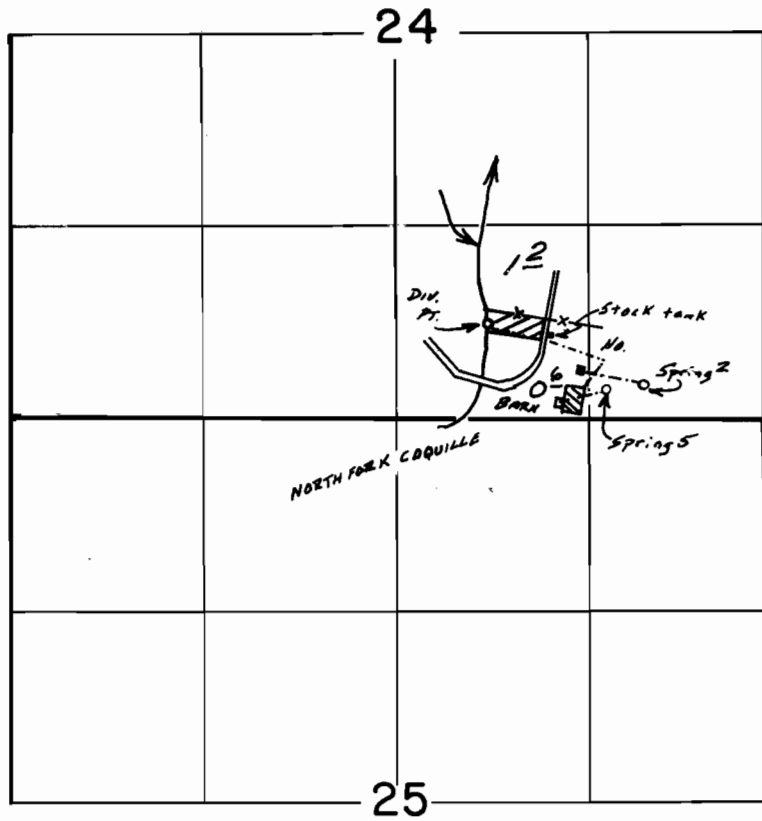

RIVER: 620' N & 630' E From S 1/4 cor., Sec 24.

Spring #2: 240' N & 1700' E from S 1/4 cor., Sec 24.

Spring #5: 200' N & 1470' E from S 1/4 cor., Sec 24.

Scale 1" = 1320'

 River

 Spring 5

FINAL PROOF SURVEY UNDER

Application No. 497.96 Permit No. 367.07....
IN NAME OF

ALBERT & LINDA ENYEART

Surveyed Sept. 13, 1979, by Steve Donaldson