

UNITED STATES  
DEPARTMENT OF THE INTERIOR  
BUREAU OF LAND MANAGEMENT

Application No. R-18877  
Permit No. R11082

# Oregon State Water Filings

TOWNSHIP 21S, RANGE 38E, W. M. Runway  
4835

SECTION

NE 1/4 of SW 1/4  
of Sec. 22

North

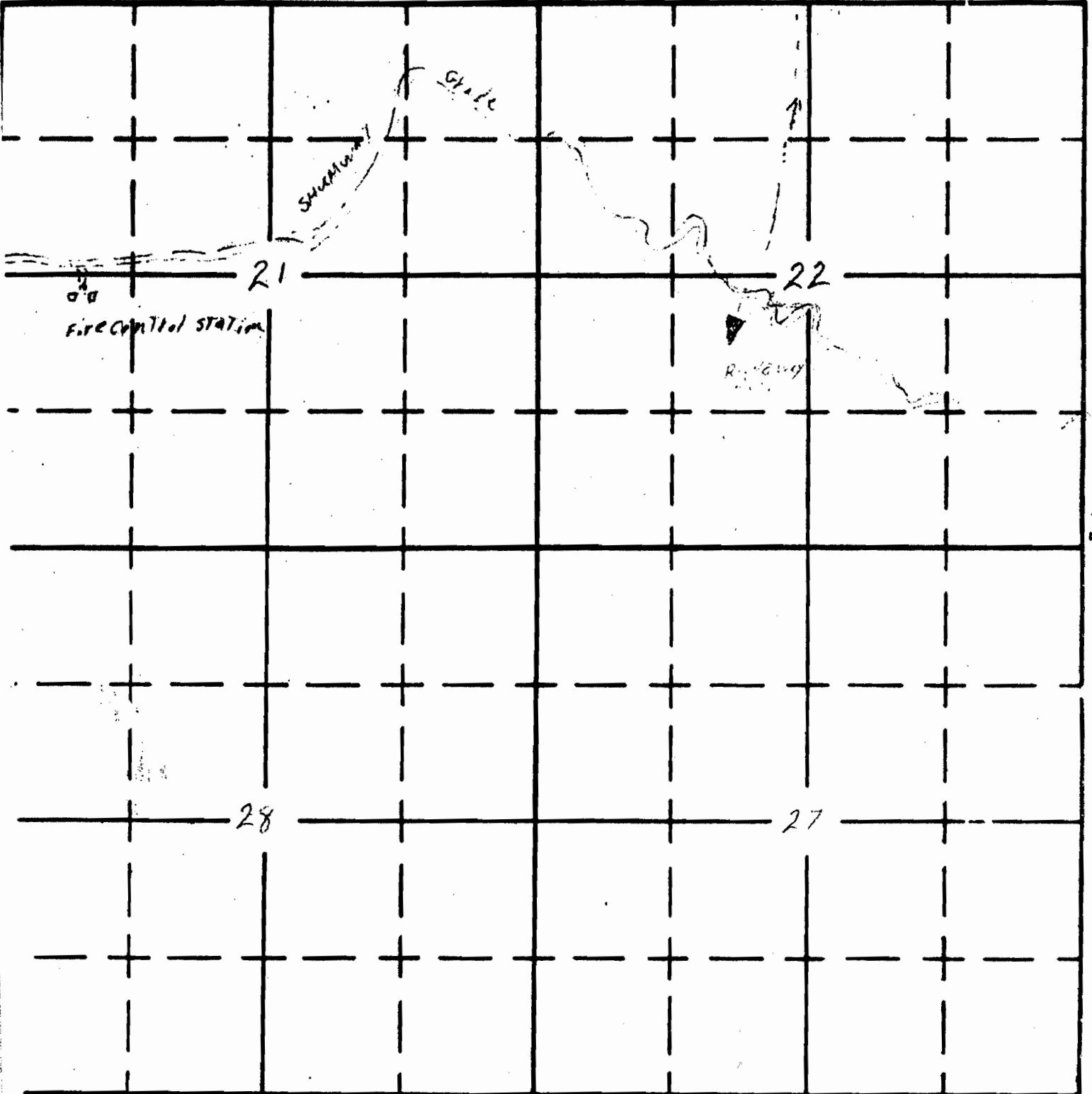

East

South

APPLICATION No. R-18877

Form 22-187  
March 1961

UNITED STATES  
DEPARTMENT OF THE INTERIOR  
BUREAU OF LAND MANAGEMENT

Boundary Res  
0796

SECTION

# Oregon State Water Filings

SW 1/4 of NW 1/4  
Sec 30

TOWNSHIP 235, RANGE 40E, W. M.

North

Application No. **R-68866**  
Permit No. **R11213**

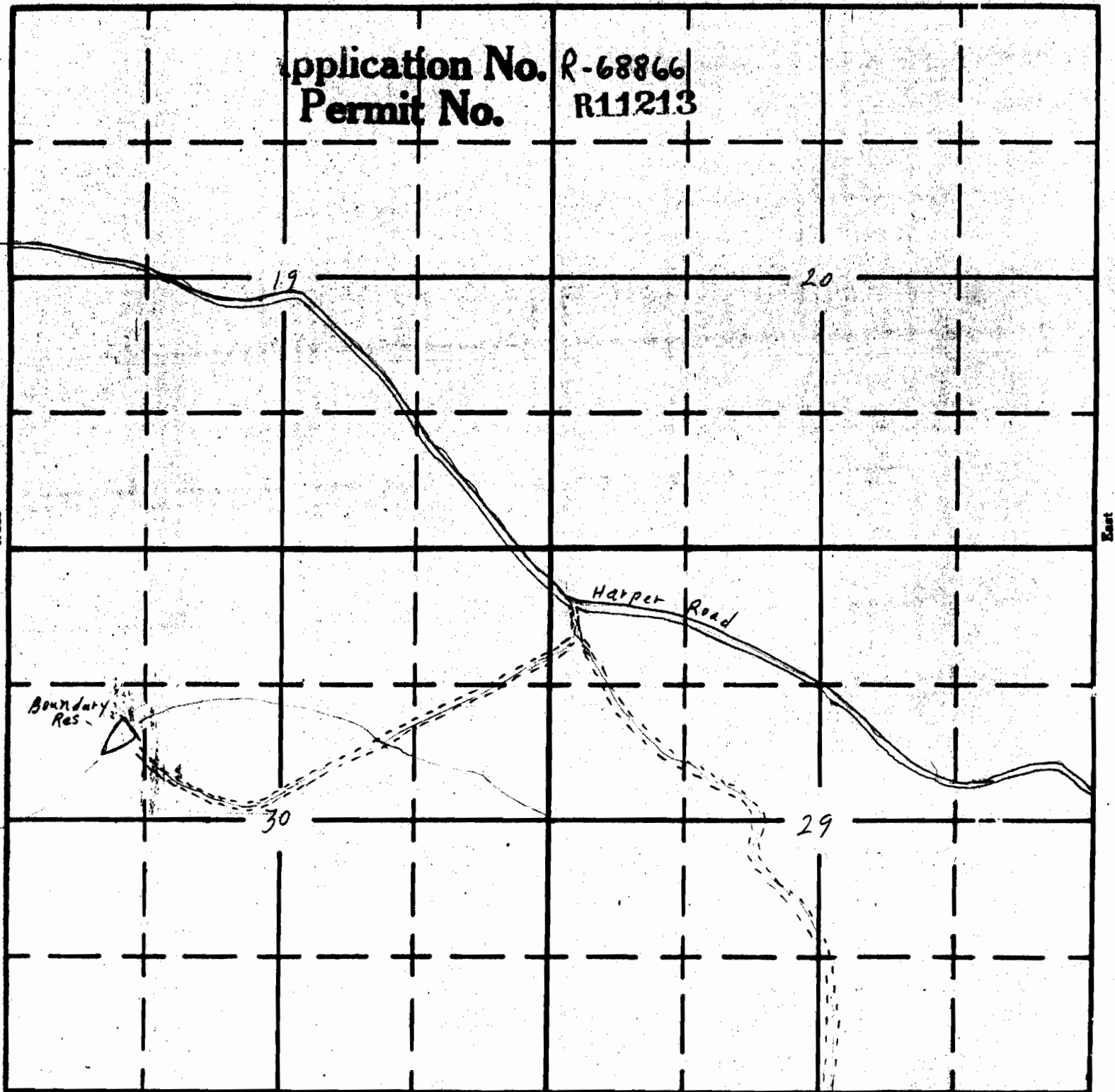

South

APPLICATION No. **R-68866**  
PERMIT No.