

T.3N. R.29E. W.M.

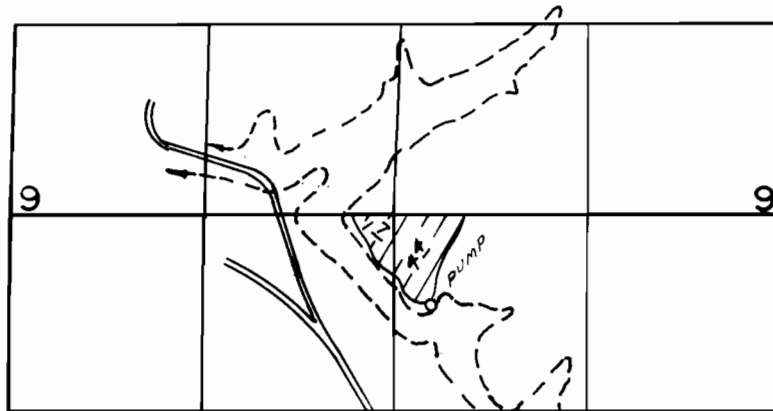

T.3N. R.29 & 30E. W.M.

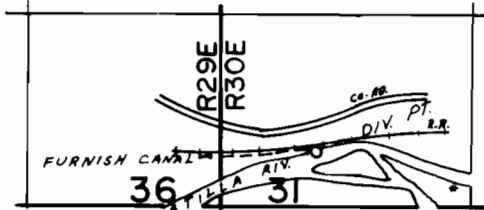

DIV. PT. LOC. 380' N. & 650' E. FROM SW COR. SEC. 31

16

FURNISH CANAL
U.S. FEED CANAL

FINAL PROOF SURVEY
UNDER

Application No. 51943... Permit No. 37406...
IN NAME OF

ECHO CEMETERY DISTRICT

Surveyed SEP. 10. 1975., by L.H. NUNN