





# T-6970 RR Map for Certificate 75555

T. 3N., R. 28E., W.M.  
 UMATILLA COUNTY  
 SCALE 1" = 1320'

WATER RIGHTS TRANSFER MAP  
 IN NAME OF  
L & L FARMS

Water Rights Transferred To These Locations

-  PERMIT #G-6893  
CERT. #51786
-  PERMIT #G-6936  
CERT. #51784
-  PERMIT #G-7036  
CERT. #51785  
PRIMARY
-  PERMIT #G-7036  
CERT. #51785  
SUPPLEMENTAL

Well 1 Located 960' N. & 30' E. from S. 1/4 Corner Section 23  
 Well 2 Located 930' S. from N. 1/4 Corner Section 26  
 Well 3 Located 60' S. & 820' E. from N.W. Corner Section 23

THIS MAP IS FOR THE PURPOSE  
 OF IDENTIFYING THE LOCATION  
 OF WATER RIGHTS ONLY AND IS  
 NOT INTENDED TO PROVIDE  
 LEGAL DIMENSIONS OR LOCATIONS  
 OF PROPERTY OWNERSHIP LINES.

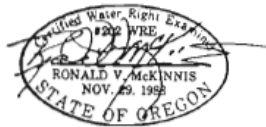
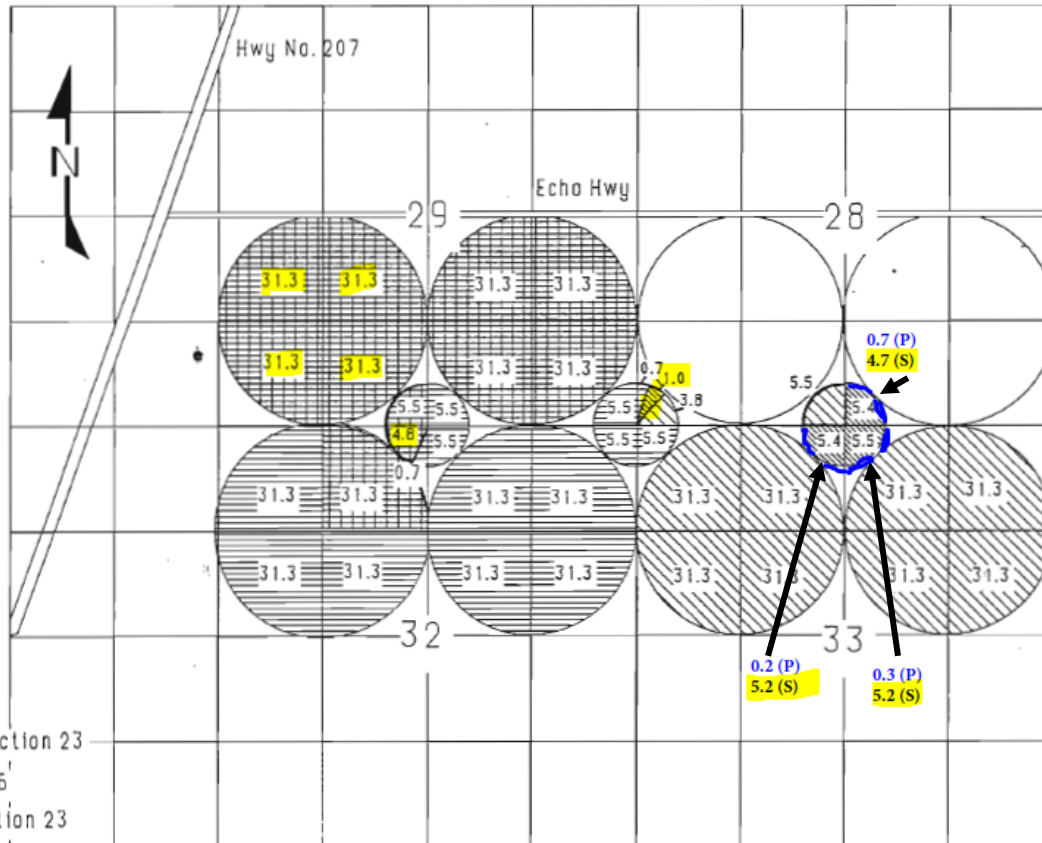

**RECEIVED**

JUL -9 1990

WATER RESOURCES DEPT.  
 SALEM, OREGON

ENGINEERING - SURVEYING - WATER RIGHTS  
 R V MCKINNIS ENGINEERING  
 Rt 1 Box 1122 Hermiston, Oregon 97838  
 503-567-2017