

JORDAN VALLEY IRRIGATION DISTRICT

T.30&31S.,R.44&45E.,WM.

T.30S.,R.46&47E.,WM.



ANTELOPE UNIT

FINAL PROOF SURVEY

Application No. 310 Permit No. 10843
R-2886 R-664

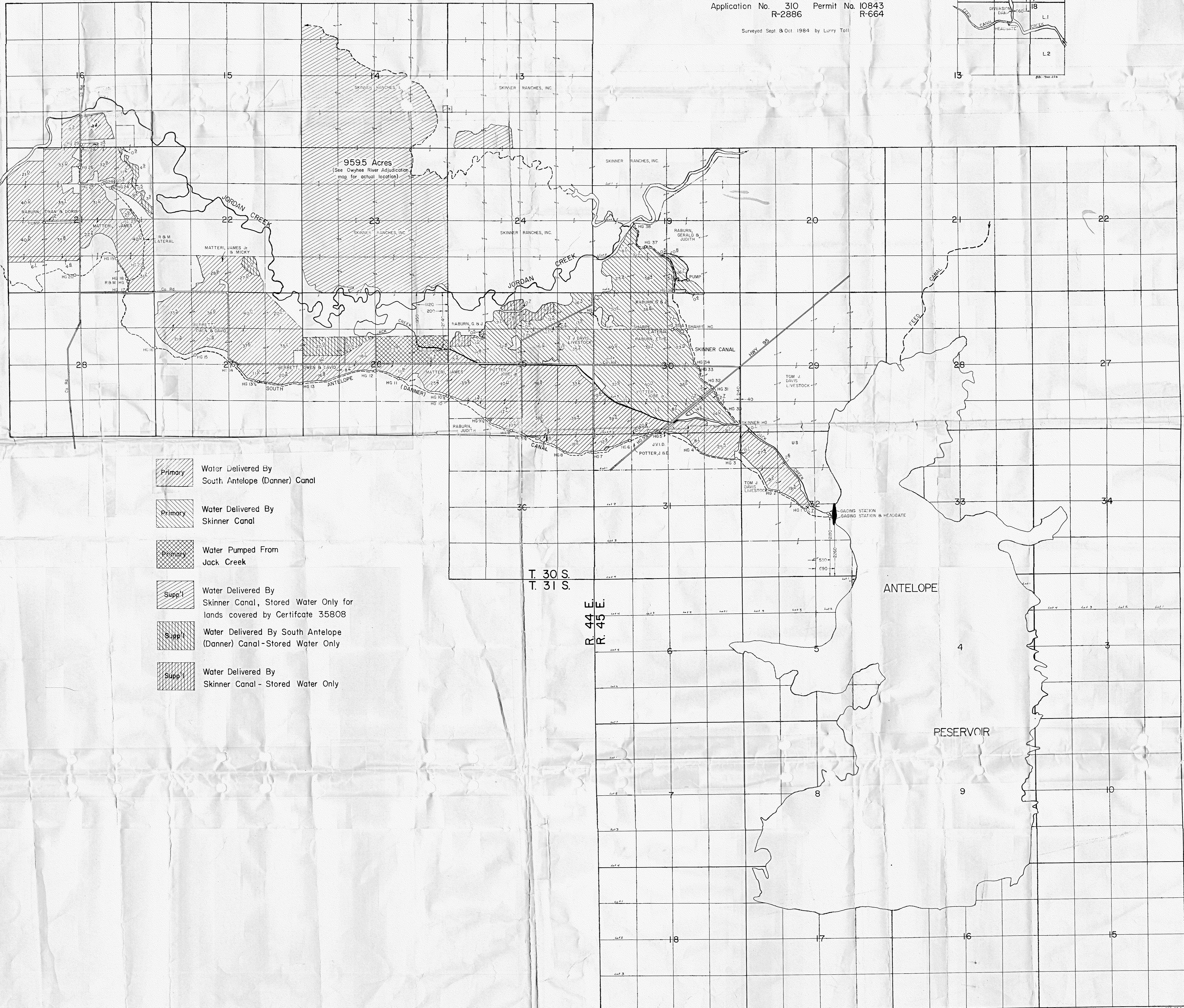
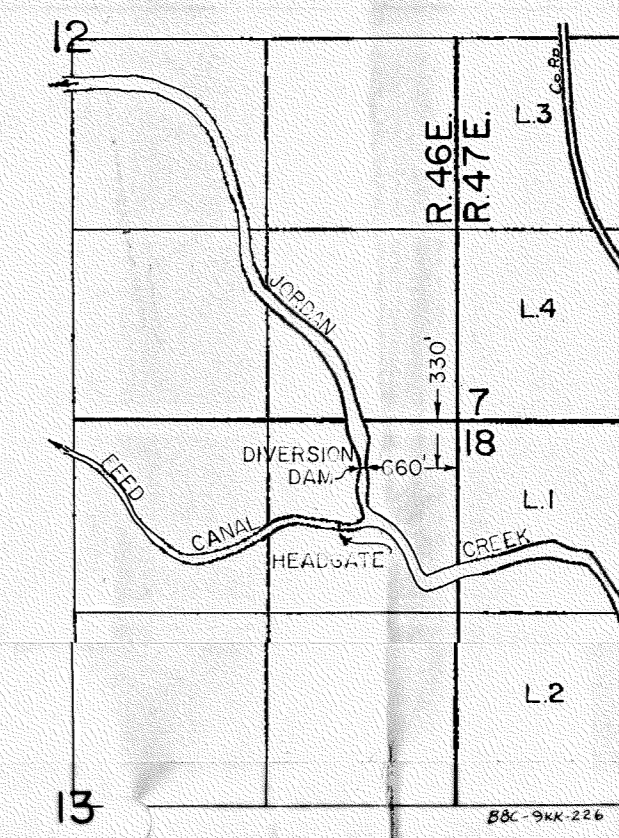
Surveyed Sept. & Oct. 1984 by Lurry Toll

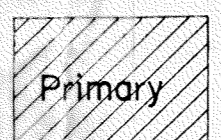
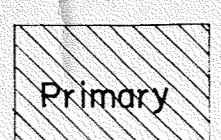
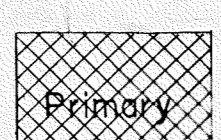
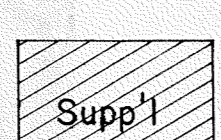

-  Primary Water Delivered By South Antelope (Danner) Canal
-  Primary Water Delivered By Skinner Canal
-  Primary Water Pumped From Jack Creek
-  Supp. 1 Water Delivered By Skinner Canal, Stored Water Only for lands covered by Certificate 35808
-  Supp. 1 Water Delivered By South Antelope (Danner) Canal - Stored Water Only
-  Supp. 1 Water Delivered By Skinner Canal - Stored Water Only

T. 30 S.
T. 31 S.

R. 44 E.
R. 45 E.

ANTELOPE

RESERVOIR

T.30&31S,R.42&43E,W.M.



NORTHSIDE UNIT

SOUTHSIDE UNIT

- Primary Water Delivered By Northside And Southside Canals
- Suppl Stored Water Only