

T. 26S., R. 3W., W.M.

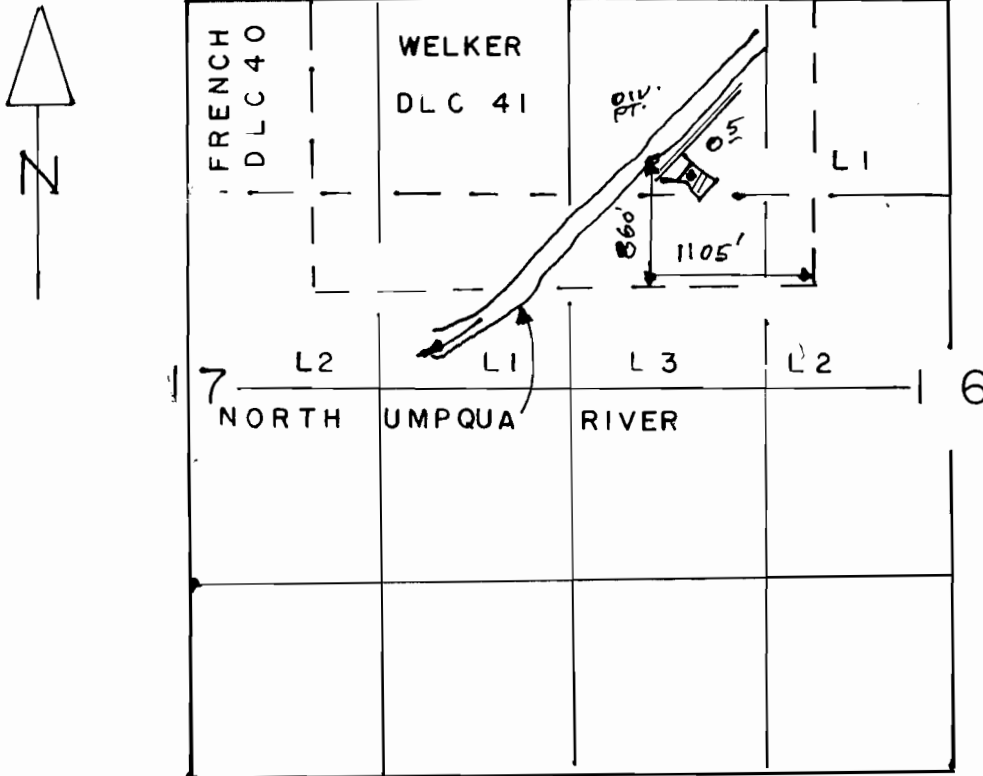

THE PURPOSE OF THIS MAP IS TO IDENTIFY THE LOCATION OF THE WATER RIGHT. IT IS NOT INTENDED TO PROVIDE INFORMATION RELATIVE TO THE LOCATION OF PROPERTY OWNERSHIP BOUNDARY LINES.

FINAL PROOF SURVEY
UNDER

Application No. 70404 Permit No. 51026
IN NAME OF

CHARLES R. RODGERS

Surveyed Aug. 29, 1993 by DUANE W. KIRBY

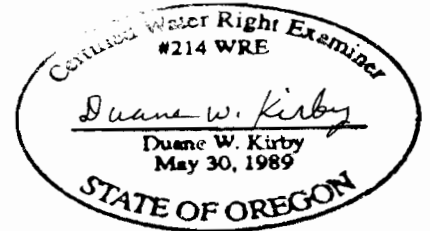

WATER RESOURCES DIVISION
SALEM, OREGON