

T. 26 S., R. 11 W. W.M.

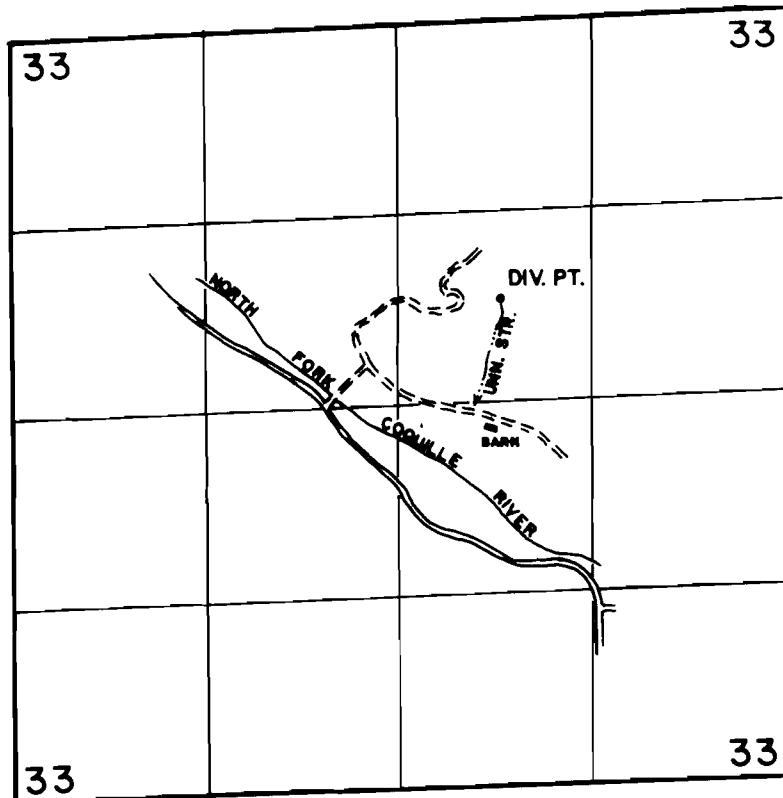

N

SCALE: 1" = 1320'

DIV. PT. LOCATION: 720' NORTH and 710' EAST  
from the center of SECTION 33.

## FINAL PROOF SURVEY UNDER

Application No. 53386. Permit No. 40675.....  
IN NAME OF

.....PAUL CULBERTSON.....

Surveyed SEPT. 28, 1988, by Z. F. SALEH.....  
SEPT. 17, 1990 B. W. BISHOP