

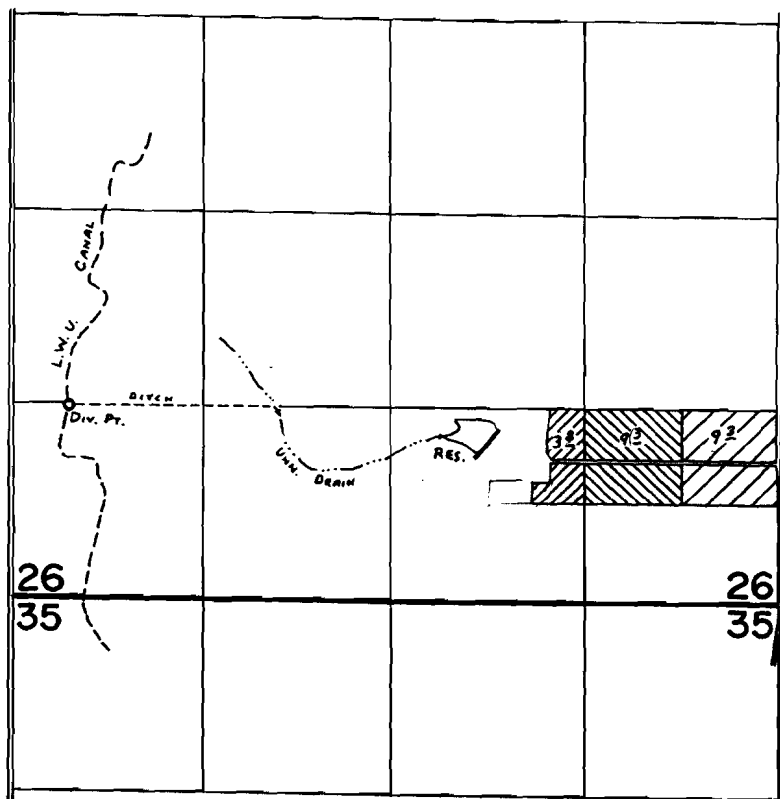



42347
75750

T.39S. R.19E. W.M.



Div. Pt. Loc: 1310' N. & 400' E. fr. S.W. Cor. Sec. 26.

Dam Loc: 1080' N. & 1990' W. fr. S.E. Cor. Sec. 26.

-  - PRIMARY IRR. fr. CANAL (APP. 37062), SUPPLEMENTAL IRR. fr. U.N.N. DRAIN & RES. (APP. R-56336 & 56340)
-  - PRIMARY IRR. fr. CANAL (T-4209), SUPPLEMENTAL IRR. fr. U.N.N. DRAIN & RES. (APP. R-56336 & 56340)
-  - PRIMARY IRR. fr. U.N.N. DRAIN & RES. (APP. R-56336 & 56340)

FINAL PROOF SURVEY UNDER

T-4209

R-56336

R-6705

Application No. 56340 Permit No. 42347.....

IN NAME OF

WILLIAM RAY ROGERS.....

Surveyed June 7 1980, by C.L. Hughes.....