

G.9125 12
 53457
 75533
 T6864
 T8013
 75826
 T8013
 T8420

T.26S.,R.16E.,W.M.

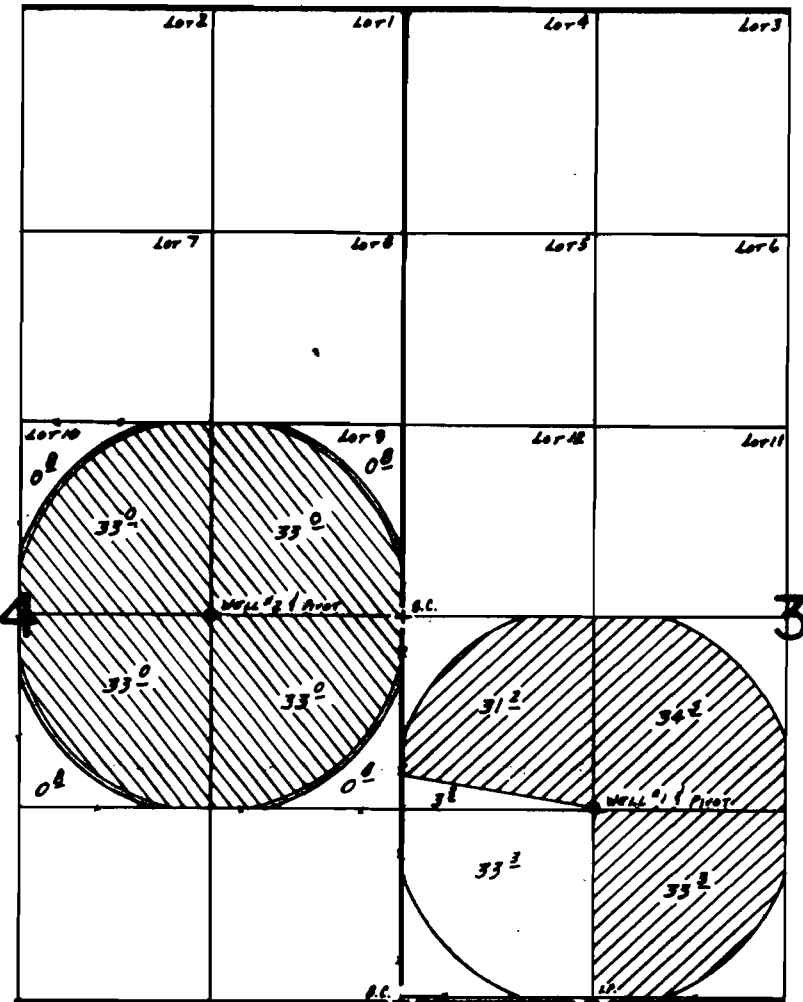

WELLS LOC: #1-1540 N. & 1320 E., #2-2640 N. & 1320 W., BOTH FROM THE SW COR. SEC 3.

 WELL No. 1
 WELL No. 2

SCALE: 1" = 1320'

FINAL PROOF SURVEY
 UNDER

Application No. G:10096 Permit No. G:9125.....
 IN NAME OF

.....**CHARLES D. NOFZIGER**.....

Surveyed OCT. 29... 1984, by R.W. BISHOP.....