

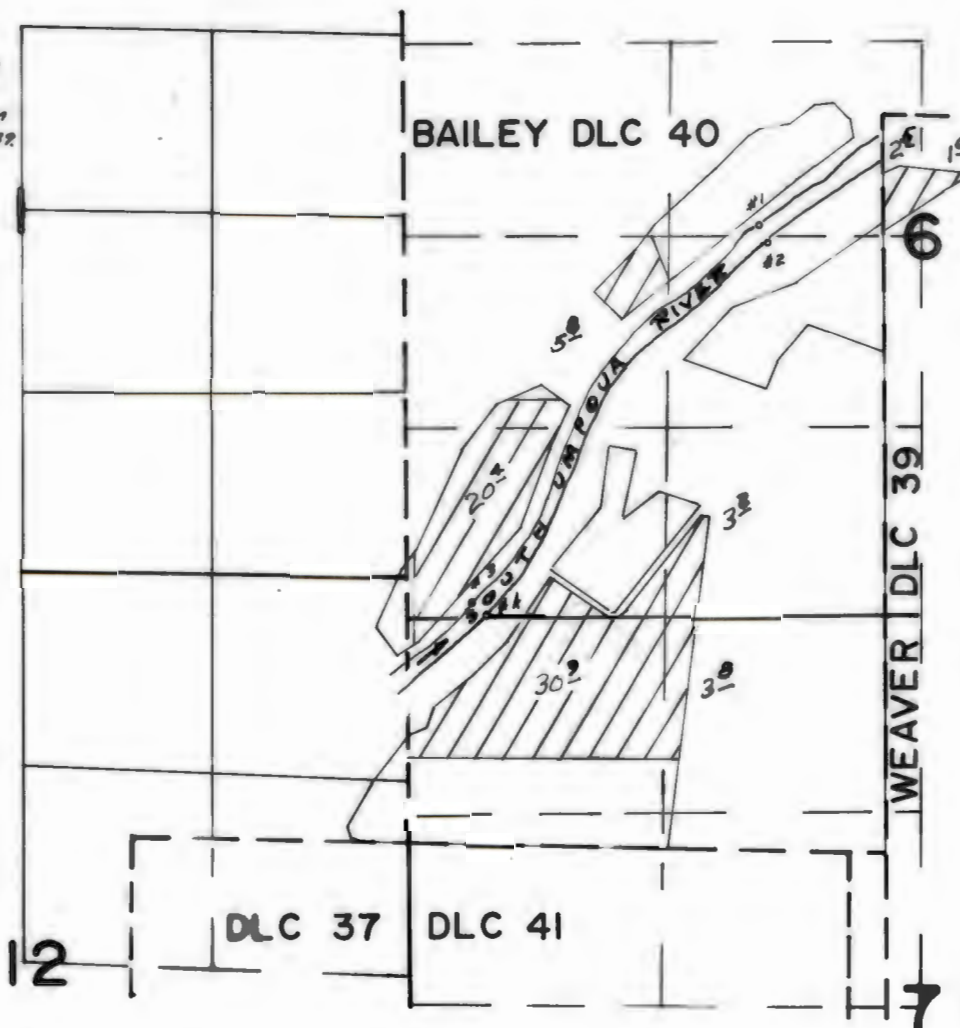

# T.30S. R.5 & 6W. W.M.

DIV. PTS. LOC.: #1 - 730' S. & 860' W.; #2 - 830' S. & 700' W.; #3 - 3300' S. & 2820' W.; #4 - 3390' S. & 2730' W. ALL FROM THE NW COR. WEAVER DLC 39.



## FINAL PROOF SURVEY UNDER

Application No. 16401..... Permit No. 12200.....  
IN NAME OF

**JAMES E. LEWIS**

Surveyed JUL. 27. 1949. by H.L. COFFMAN