

T30S. R.5 & 6W. W.M.

DIV. PTS. LOC. 2 #1-730'S. & 860'W.; #2-830'S & 780'W.; #3-3300'S. & 2820'W.; #4-3390'S. & 2730'W. ALL FROM THE NW COR. WEAVER DLC 39.

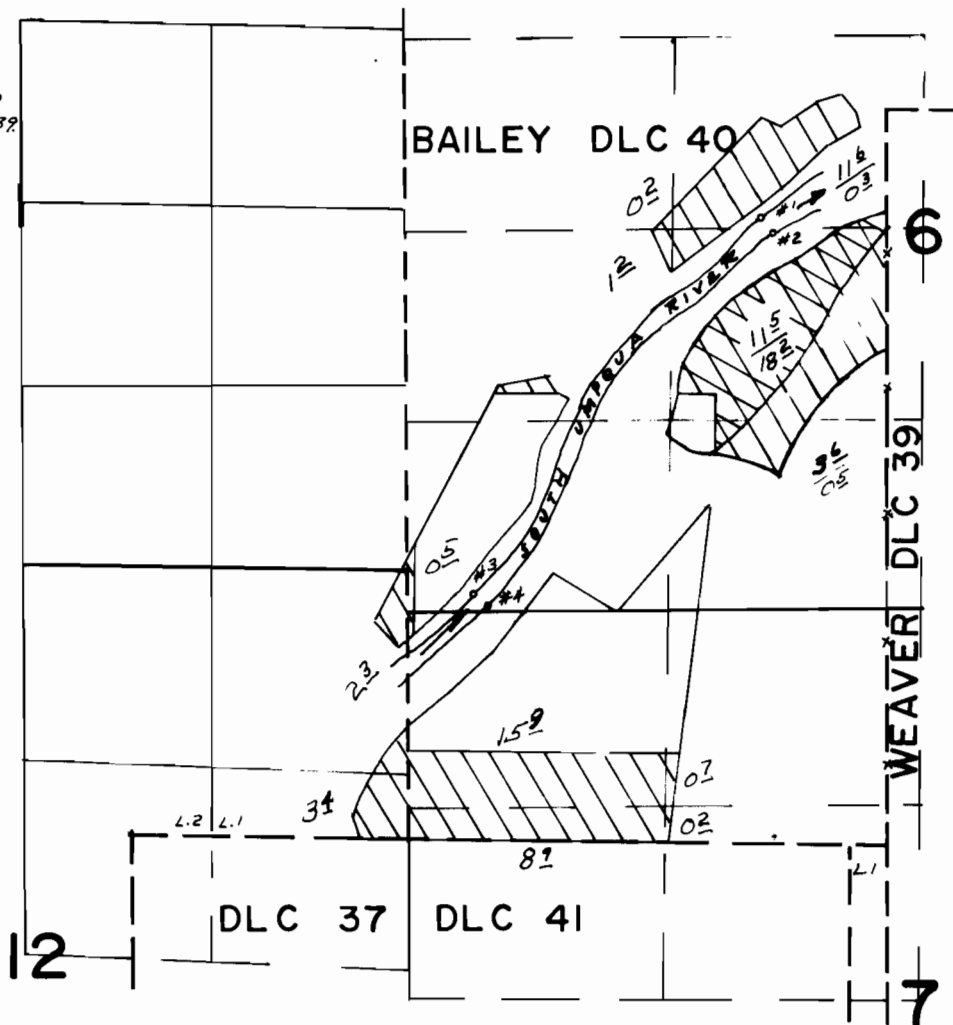

FINAL PROOF SURVEY UNDER

PRIMARY 
SUPPLEMENTAL 

Application No. 16048... Permit No. 11867...
IN NAME OF

JAMES E. LEWIS

Surveyed JUN. 12... 1939, by C. A. CUMMINGS