

T. 2N. R. 26E. W. M.

75848
52085
L4190
72774

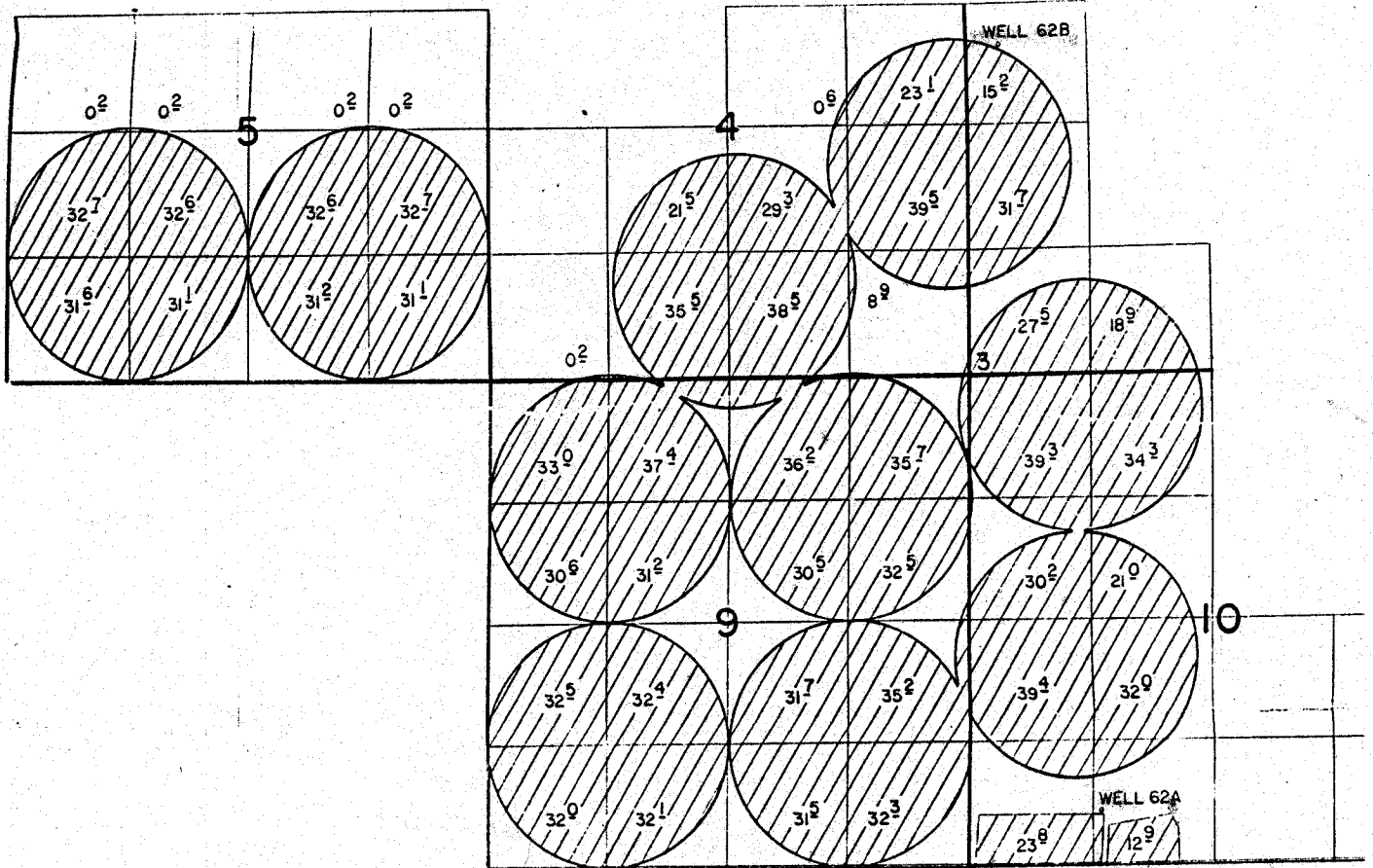

WELL 62B LOCATED 3500'N & 350'E FROM SW COR SEC 3 T.2N., R.26E. W.M.
 WELL 62A LOCATED 560'N & 1450'E FROM SW COR SEC 10 T.2N., R.26E. W.M.
 WELL 62 LOCATED 3700'S & 1790'E FROM NW COR SEC 23 T.2N., R.26E. W.M.

FINAL PROOF SURVEY
 UNDER

APPL. NO. G-5096

PER. NO. G-4918

IN NAME OF

CONNECTICUT GEN. LIFE INS. CO.

SURVEYED MAY 3, 1979 by R. BARWIN

NOT TO SCALE

Do large
map full

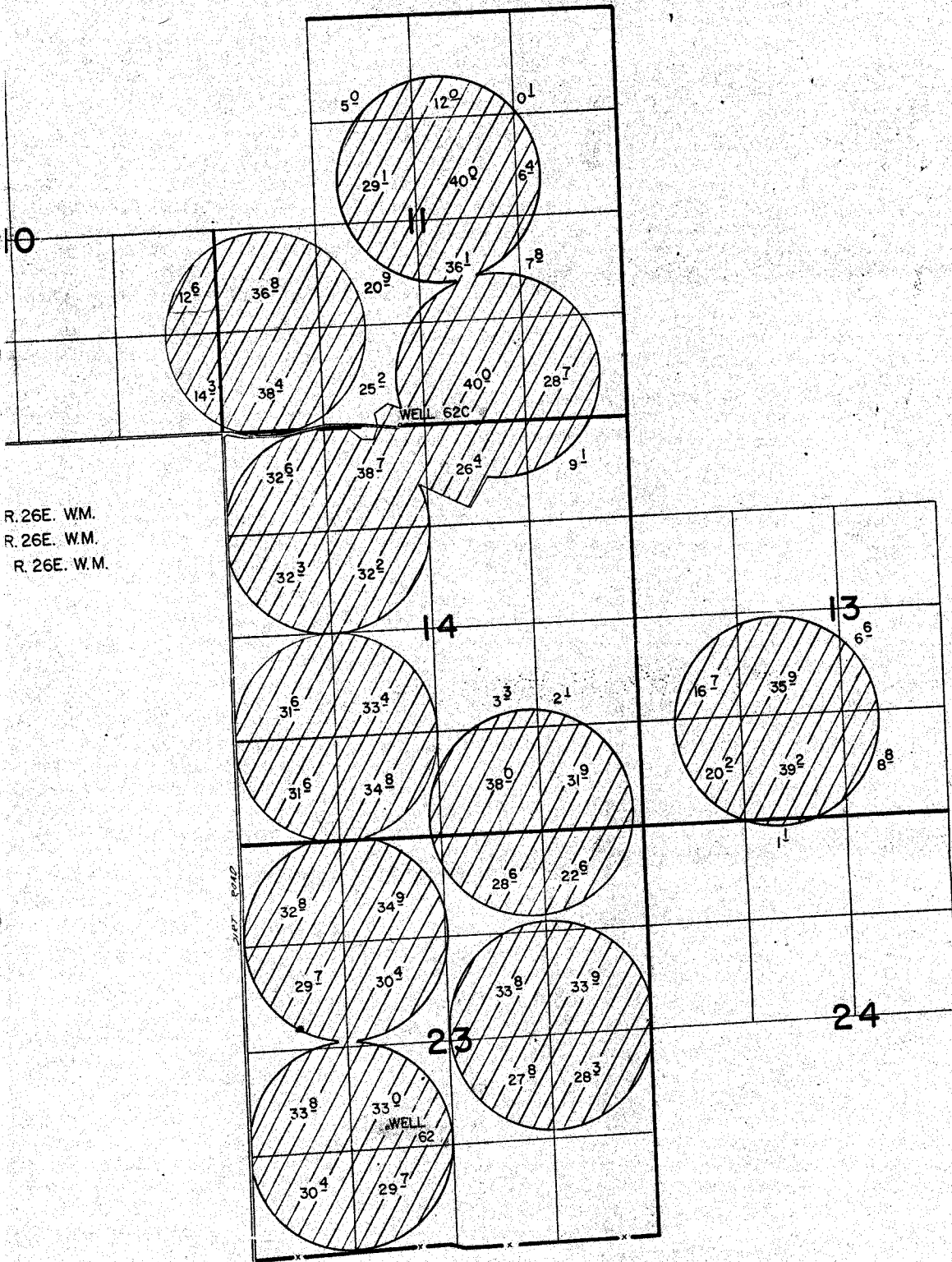

R. 26E. W.M.
 R. 26E. W.M.
 R. 26E. W.M.

NOT TO SCALE

See large map file

T2N R26E W.M.

SABER PHOTO 1-7 11:10
 PFS-1979-P-A

P.L.C.