

T.9S., R.45E., W.M.

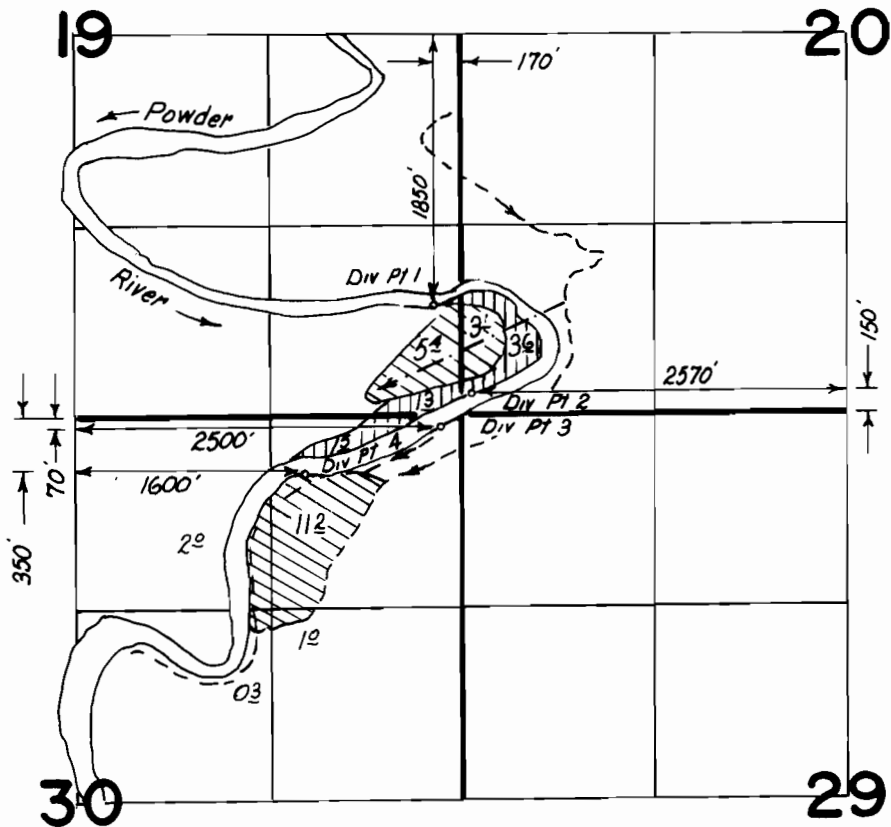

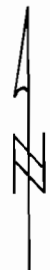

T.8S., R.45E., W.M.

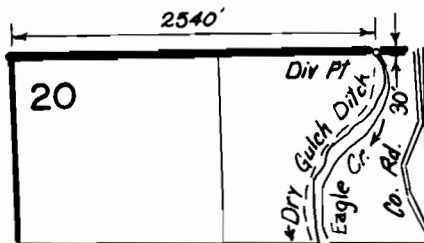

Scale: 1" = 1320'

FINAL PROOF SURVEY UNDER

-  Primary Irrigation
-  Supplemental Irrigation

Application No. 55549 Permit No. 42936....
IN NAME OF

JOHN KEATING SR

Surveyed 10-4 1988, by Kenn Kemp....