

T.9S., R.4W., W.M.

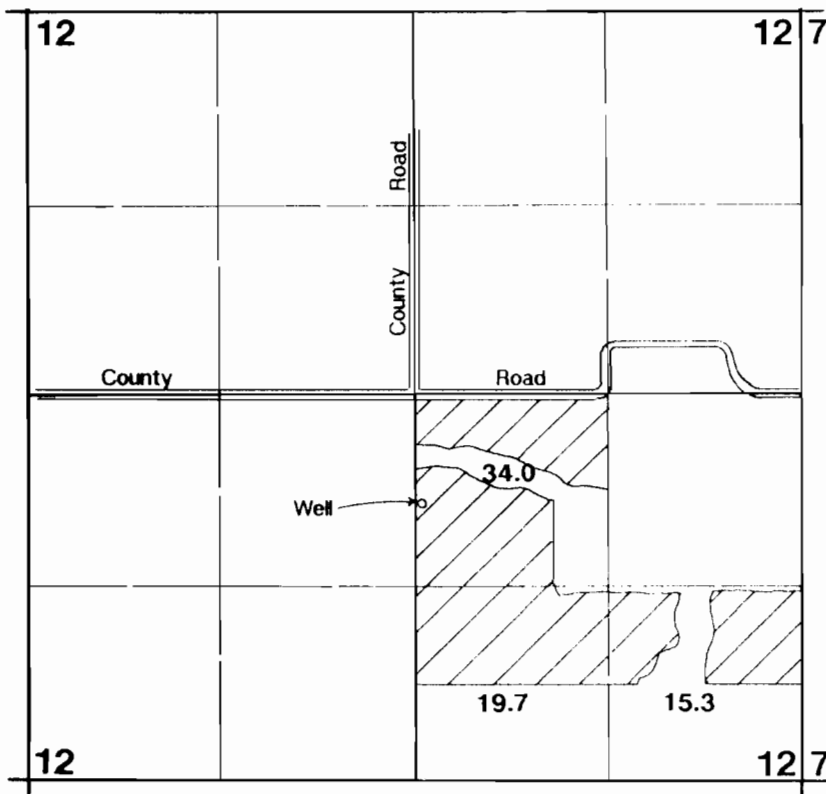

Well located 750'S & 20'E from center of Section 12.

Final Proof Survey

Application #: G-12366 Permit #: G-11391

In Name Of

James D. Brown

Surveyed on July 15, 1993 by JM Schuette

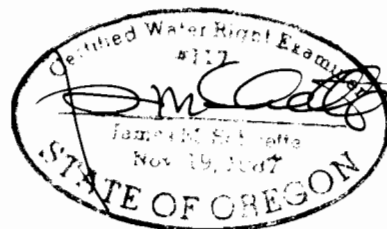

THIS MAP WAS PREPARED FOR THE PURPOSE OF IDENTIFYING THE LOCATION OF A WATER RIGHT ONLY AND IS NOT INTENDED TO PROVIDE LEGAL DIMENSIONS OR LOCATION OF PROPERTY OWNERSHIP LINES.