

Township 18 South Range 3 West, W.M.

1/4 CORNER 17-18

NW 1/4 SW1/4 SEC. 16

RECEIVED

SEP 25 1998 *det*

WATER RESOURCES DEPT.
SALEM, OREGON

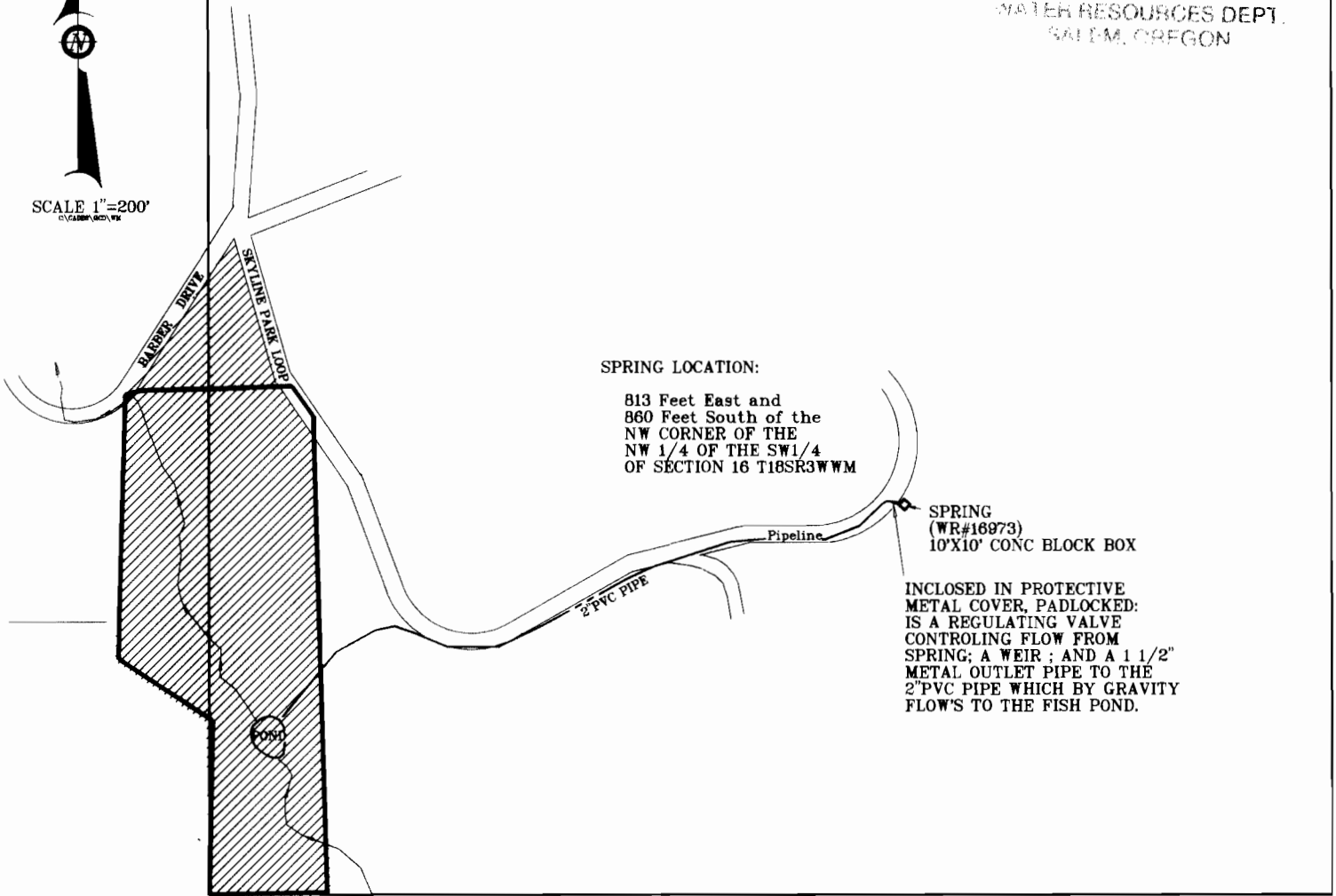

SPRING LOCATION:

813 Feet East and
860 Feet South of the
NW CORNER OF THE
NW 1/4 OF THE SW1/4
OF SECTION 16 T18SR3WWM

SPRING
(WR#16973)
10'X10' CONC BLOCK BOX

INCLUDED IN PROTECTIVE
METAL COVER, PADLOCKED:
IS A REGULATING VALVE
CONTROLLING FLOW FROM
SPRING; A WEIR ; AND A 1 1/2"
METAL OUTLET PIPE TO THE
2\"/>

FINAL PROOF SURVEY under Appl. No. 69655, Per. No. 51524

COMPLETED October 1, 1998



THIS MAP WAS PREPARED FOR THE PURPOSE OF
IDENTIFYING THE LOCATION OF A WATER RIGHT
ONLY AND IS NOT INTENDED TO PROVIDE LEGAL
DIMENSIONS OR LOCATION OF PROPERTY
OWNERSHIP LINES.