

Tr 29  
R 8 E

Permit No. 8982  
Application No. 8982

31253  
76030

Klamath River

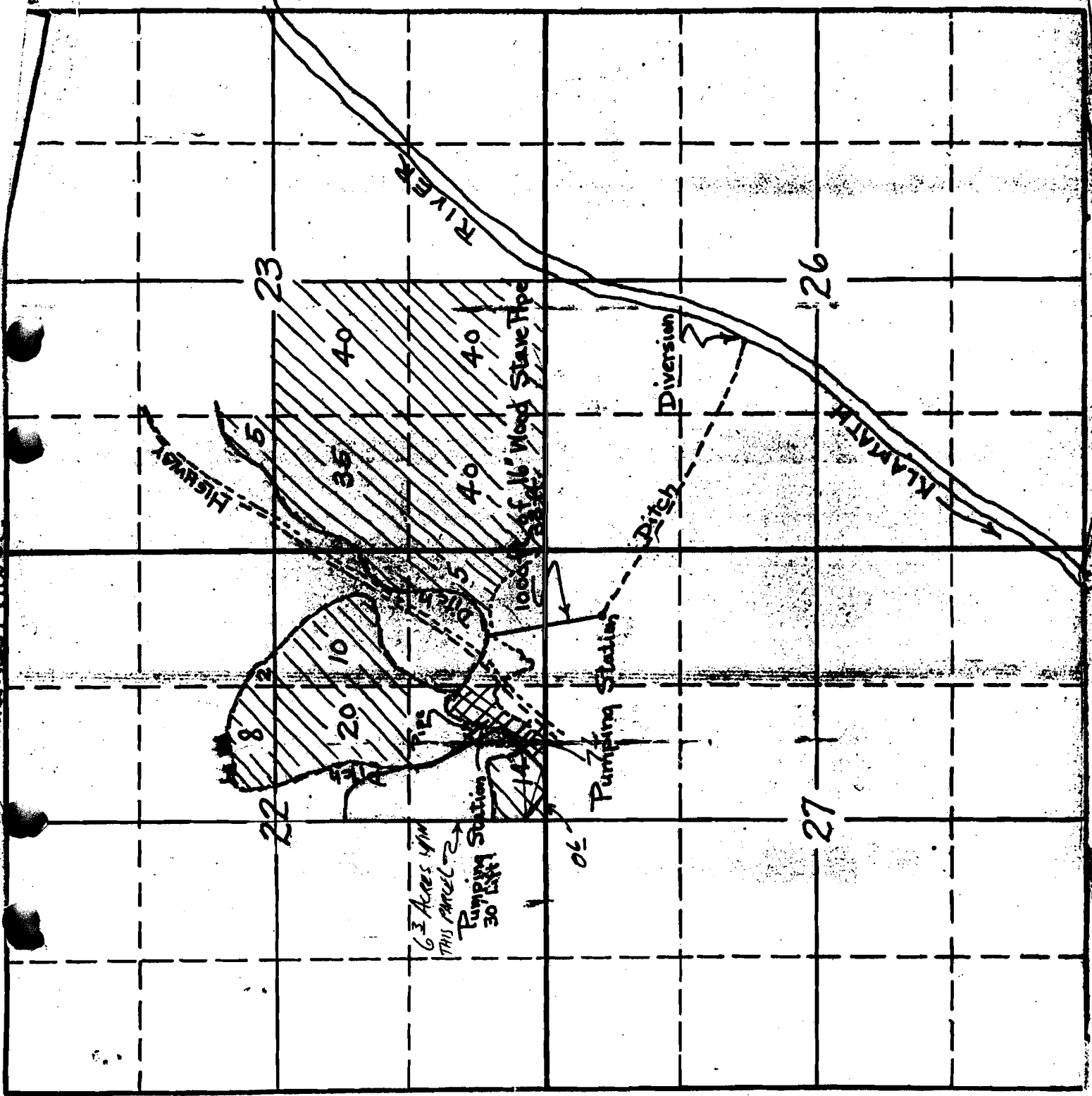

Sp. 12633  
Permit 8982.

ONLY 122  
ALLOWED  
69 - 18 = 51  
TO BE CANCELED  
7.1 REMAINING

VOL 53 P. 493

Permit  
8982