

THIS MAP WAS PREPARED FOR THE PURPOSE OF IDENTIFYING THE LOCATION OF THE WATER RIGHT AND IS NOT INTENDED TO PROVIDE LEGAL DIMENSIONS OR LOCATIONS OF PROPERTY OWNERSHIP LINES.

T25; R8,9 W; W.M.

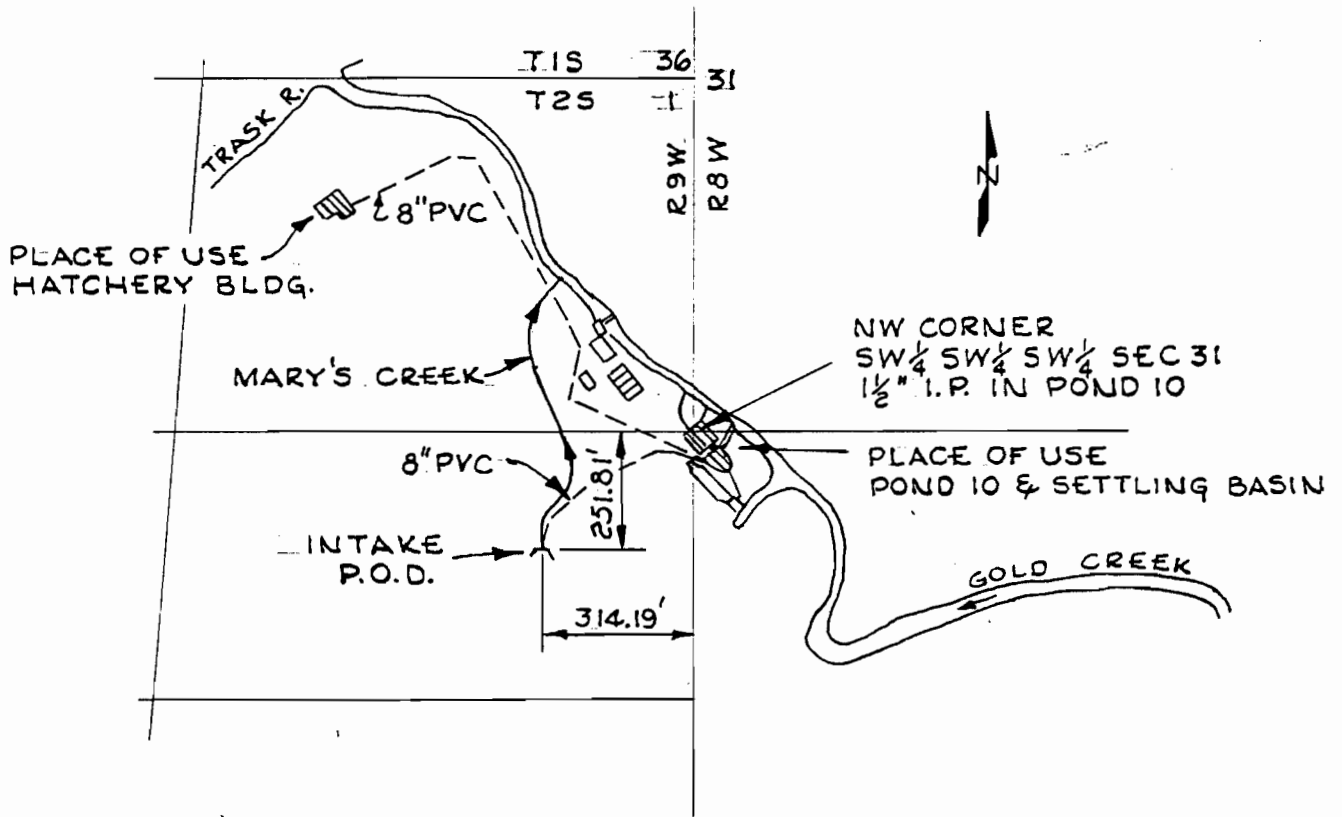

SCALE 1" = 400'

Robert O. Dodge

## FINAL PROOF SURVEY UNDER

APPLICATION NO. 5-71159

PERMIT NO. 52520

IN NAME OF

OREGON DEPARTMENT OF FISH AND WILDLIFE

SURVEYED: 10/22/96

BY: DODGE