

G-8877

76078

T. 39 S., R. 11 E., W.M.

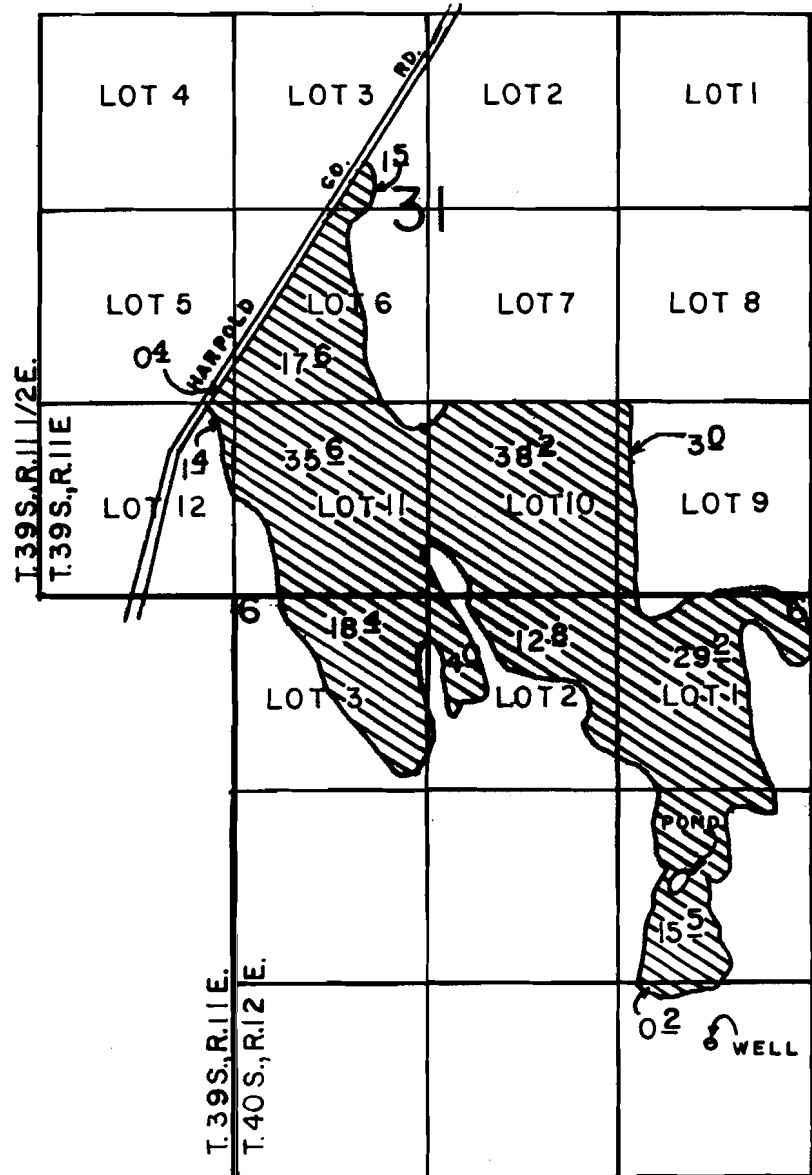

WELL LOC: 2220' N & 700' W FROM SE COR. OF SEC 6.

SCALE: 1" = 1320'

FINAL PROOF SURVEY

UNDER

Application No. G-9365 Permit No. G-8877
IN NAME OF

WILLIAM PAUL AND SUSAN ANNE WORTHINGTON

Surveyed JUNE 18, 1991, by B.W.BISHOP

Chart for Wells

177.8 AC