

T. 9S., R. 45 & 46E., W.M.

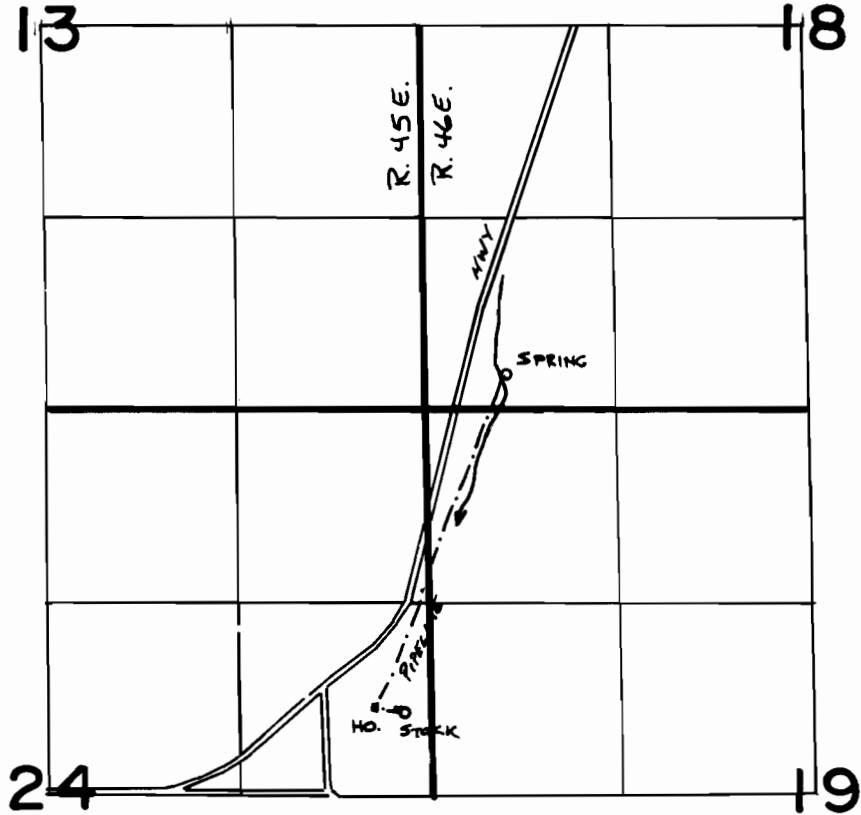

SCALE 1" = 1320'



SPRING LOC: 250'N. & 550'E FROM SW COR., SEC. 18

FINAL PROOF SURVEY

UNDER

APPL. 71145

PER. 52590

IN NAME OF

GEORGE HOLCOMB

SURVEYED SEPT. 9, 1996

The purpose of this map is for identifying the location of the water right only and is not intended to provide legal dimensions of property ownership lines.

RECEIVED

2000

May 17, 1988

