

53490
76116

T. 4 N. R. 29 E. W. M.

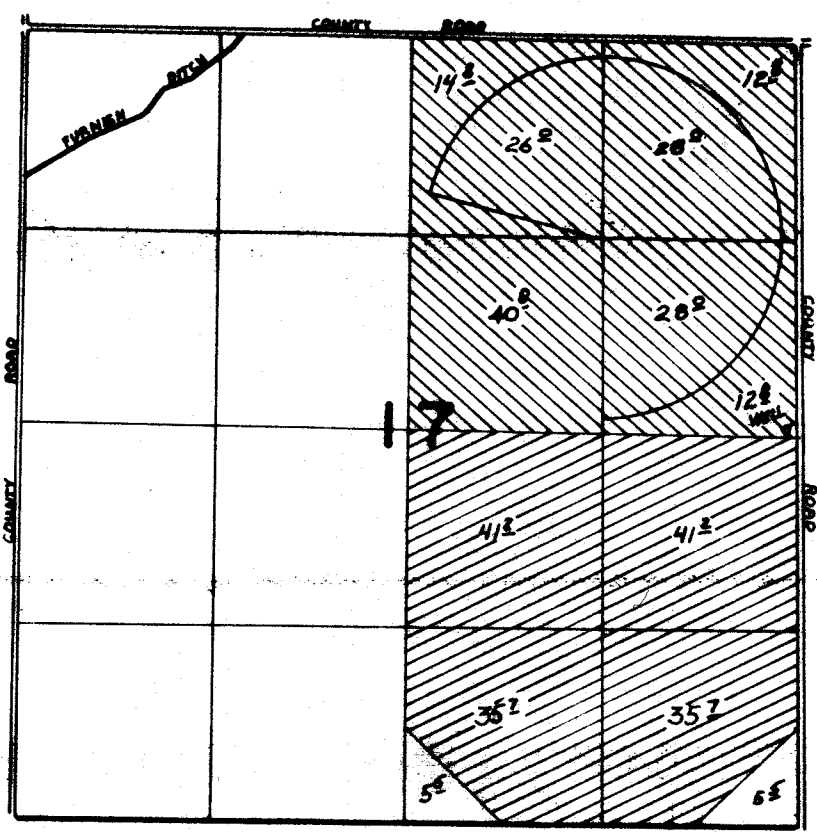

WELL LOCATED 50' N. AND 100' W. FROM E. 1/4 COR. SEC. 17

 PRIMARY
  SUPPLEMENTAL

FINAL PROOF SURVEY

UNDER

Application No. G-10569 Permit No. G-9809
IN NAME OF

PATRICK C. WALCHLI

Surveyed Jan. 28, 1985, by V.I. CHURCH