

48171
76277

RECEIVED

SEP 23 1983
WATER RESOURCES DEPT.
SALEM, OREGON

UNITED STATES
DEPARTMENT OF THE INTERIOR
BUREAU OF LAND MANAGEMENT

SECTION 7
SE 1/4 NW 1/4

Oregon State Water Filings

TOWNSHIP 39S., RANGE 4E., W. M.

Application No. R-66709, 66710

Permit No. R 9256

48171

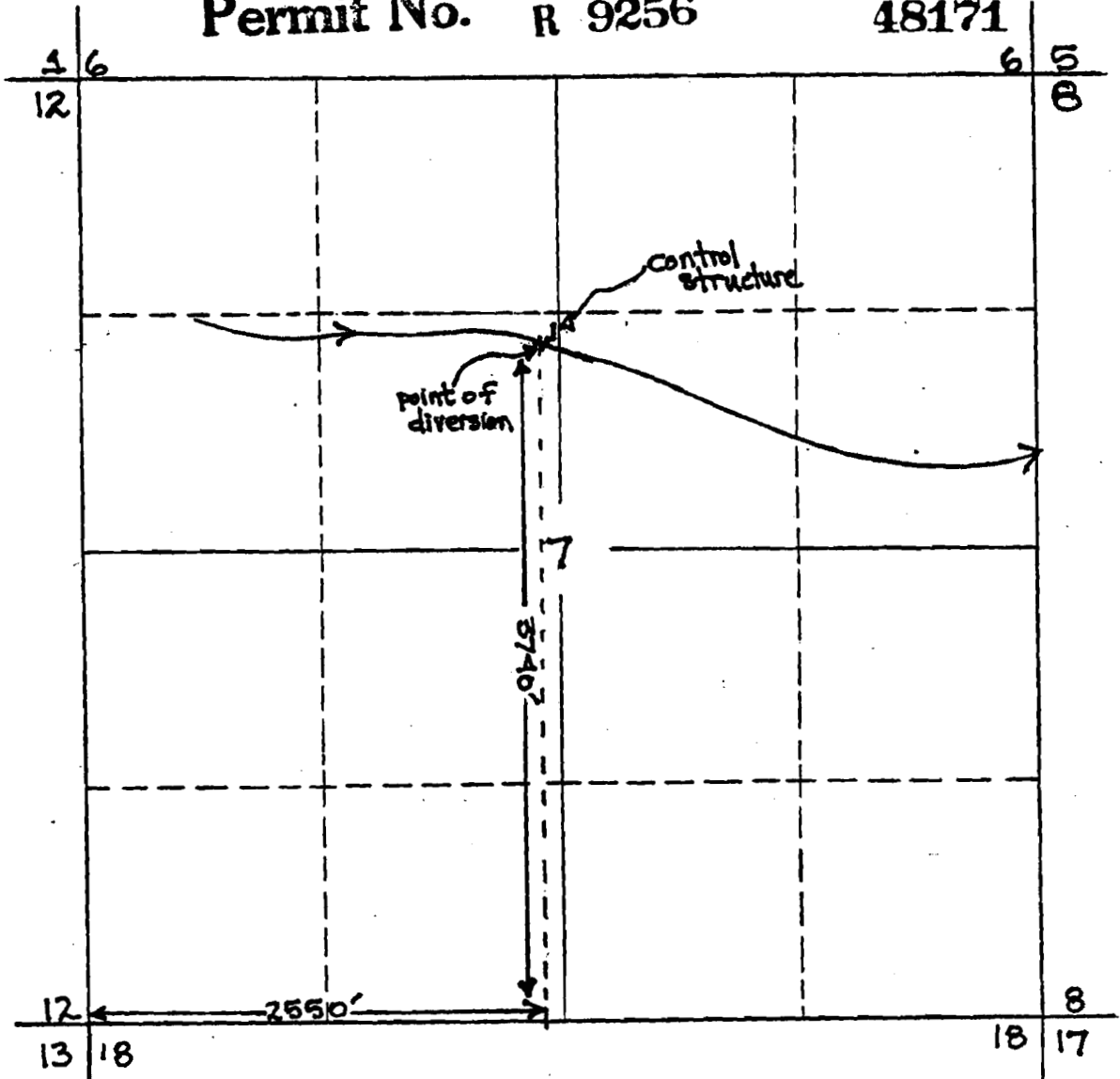

SCALE: 1" = 1000'

Enlargement of diversion and reservoir

