

T.1N.,R.14E.,W.M.

T-5192

T-5193

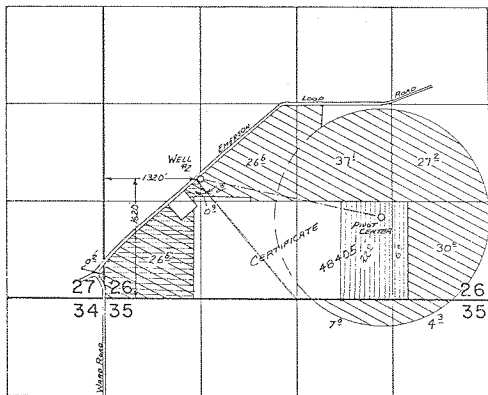

||||| TRANSFER FROM P.G. 6554  
 TRANSFER TO P.G. 7158  
 ===== TRANSFER TO P.G. 6582  
 ===== TRANSFER FROM P.G. 7108

**FINAL PROOF SURVEY**  
 UNDER

Application No. G-7438.. Permit No. G-7258...  
 IN NAME OF

GEORGE HARTH

Surveyed ..Sept..20. 1982., by J.J. Paul.....

**RECEIVED**

JAN 26 1983

WATER RESOURCES DEPT.  
 SALEM, OREGON