

T. 36 S., R. 12 E., W.M.

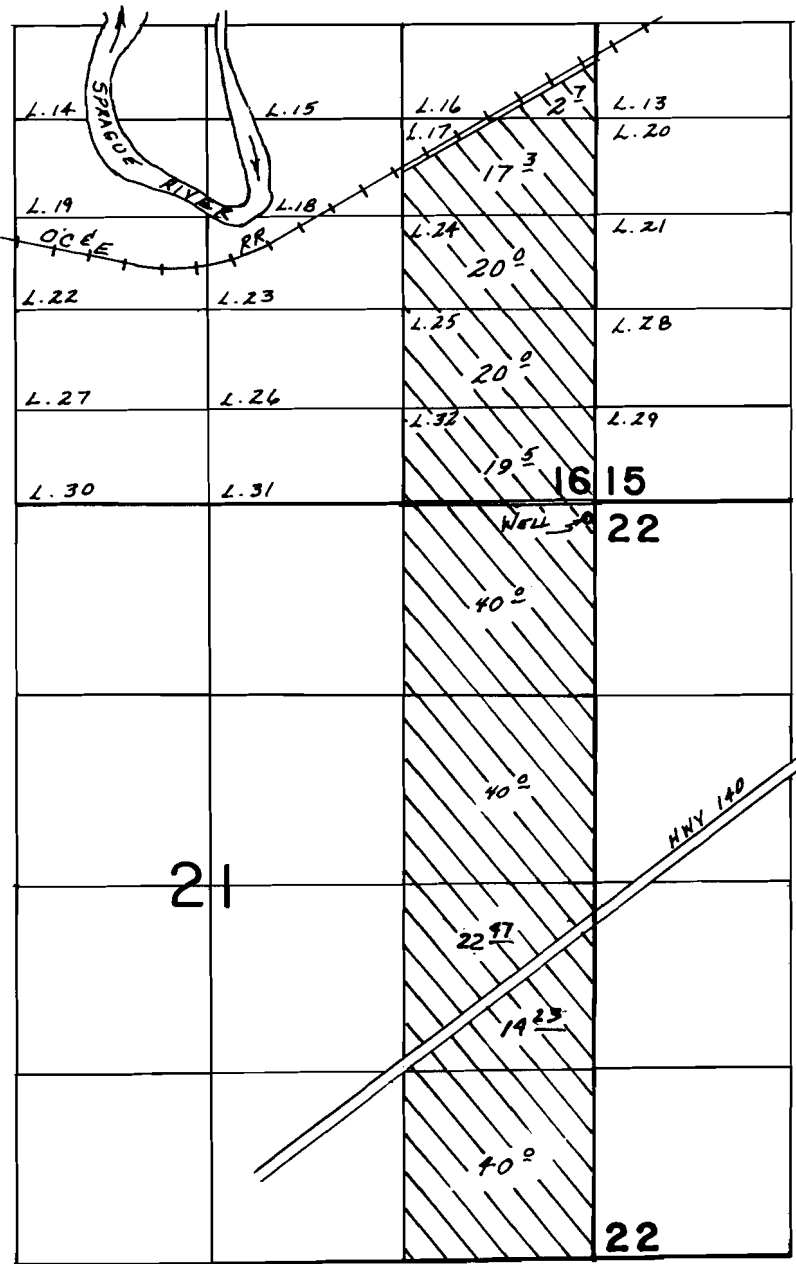

Spring River



SCALE: 1" = 1320'

WELL LOC: 100'S. & 30'W. FROM NE COR. SECTION 21.

FINAL PROOF SURVEY

UNDER

Application No. G-10934 Permit No. G-10140
IN NAME OF

TERRY & DESSA LEA HAGER

Surveyed JUNE 19 & 20, 1992, by B.W. BISHOP

JLB
4/14/92
BWB