

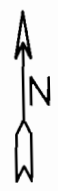
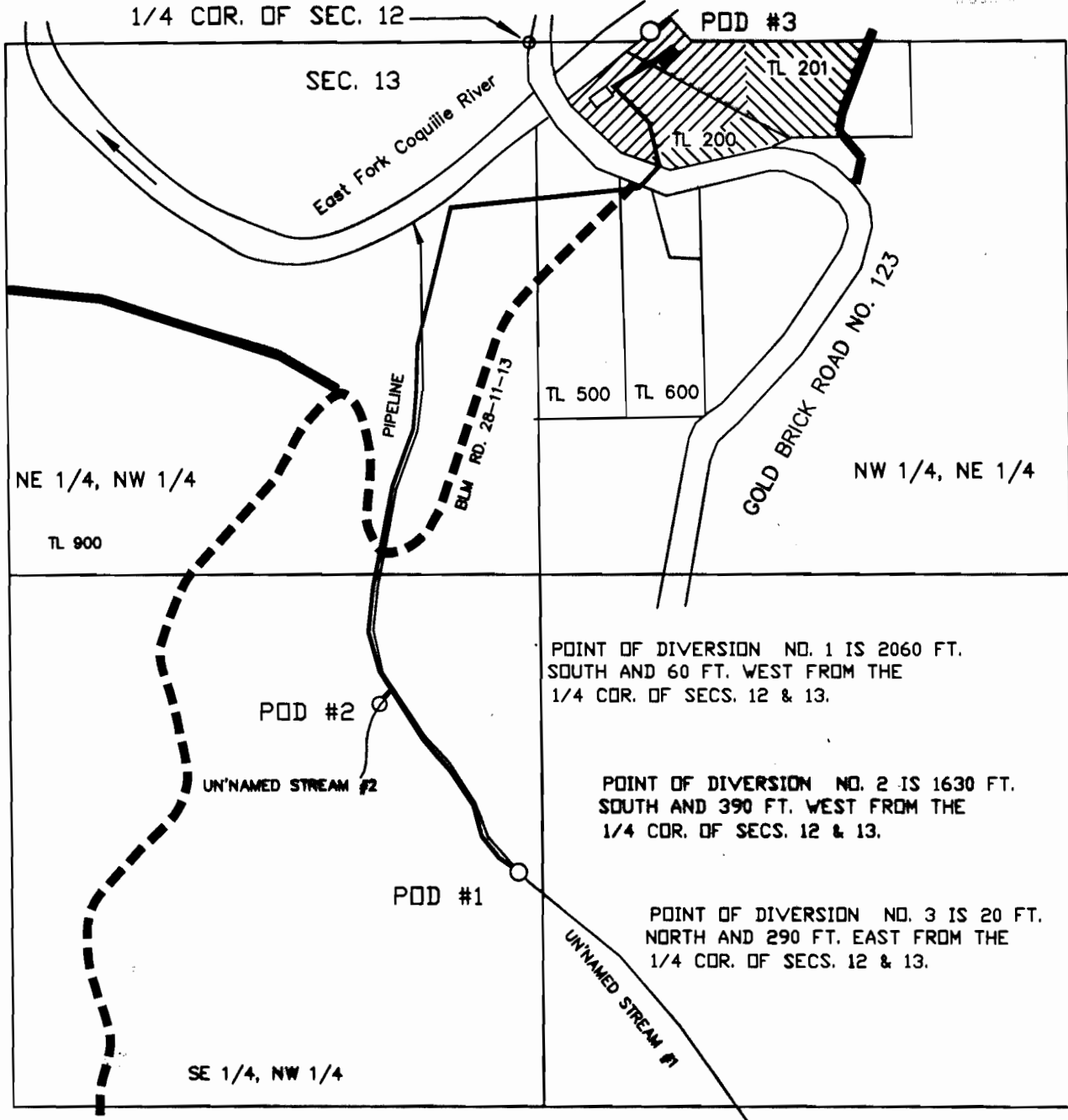

# BENEFICIAL USE

IN THE NAME OF: WAYNE AND LORENE PEARSON  
 LOT 201, SEC. 13, T 28 S, R 11 W, WM  
 1 INCH = 400 FEET

RECEIVED

1999  
 WAFFLE TECHNOLOGICALS DEPT.  
 100 E. 1000 S. SALT LAKE CITY, UT 84143



-  IRRIGATION & DOMESTIC PER 1981 CERTIFICATE OF WATER RIGHT # 46372
-  2 ACRES OF IRRIGATION & DOMESTIC PER PERMIT # 52707

THE PURPOSE OF THIS MAP IS TO IDENTIFY THE LOCATION OF THE WATER RIGHT. IT IS NOT INTENDED TO PROVIDE INFORMATION RELATIVE TO THE LOCATION OF PROPERTY OWNERSHIP BOUNDARY LINES.

SURVEYED MARCH 28, 1998  
 APPLICATION NO. S-73259  
 PERMIT NO. 52707

*Barbara Peterson*

July 8, 1999