

T.3S., R.4W., W.M.

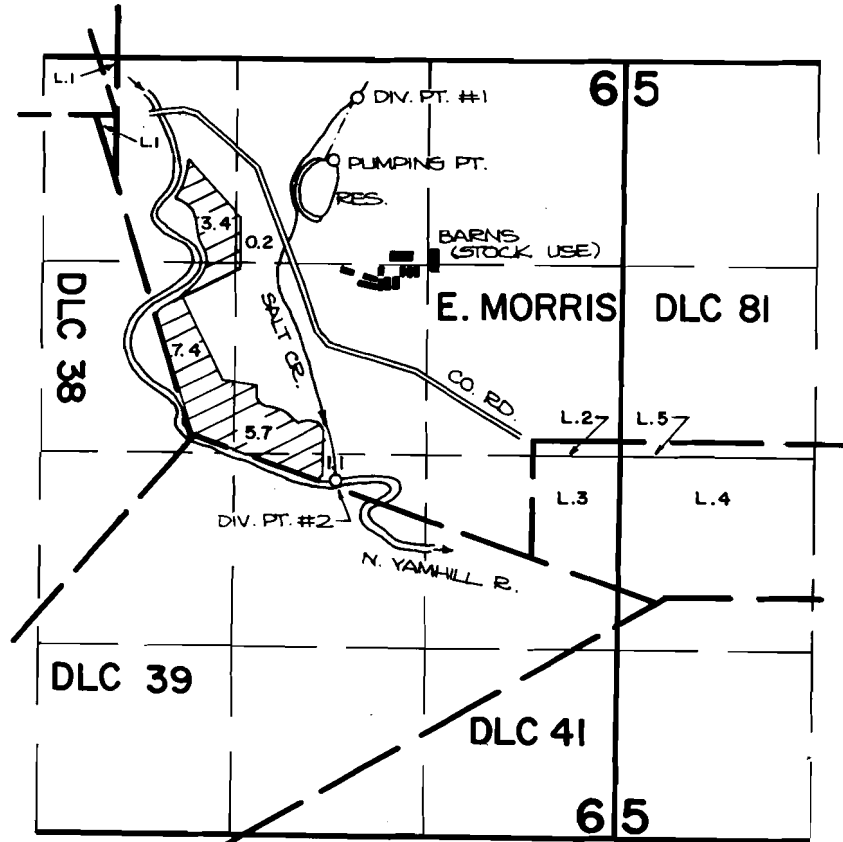

RES. LOCATION: 1635 FT. N. AND 1605 FT. W.;
DIV. PT. #1 LOCATION: 2340 FT. N. AND 1210 FT. W.;
DIV. PT. #2 LOCATION: 175 FT. S. AND 1350 FT. W.;
ALL FROM THE N.W. CORNER OF LOT 2, (SE of NE)



SCALE: 4" = 1 MILE

FINAL PROOF SURVEY
UNDER

R-53358 R-6339
Application No. 53359... Permit No. 39587.....
IN NAME OF

ROLLIE MORRIS

Surveyed JULY 10, 1984, by *P. Proter*