

RECEIVED

JUL 23 1980
WATER RESOURCES DEPT.
SALEM, OREGON

T-4570

RECEIVED
AUG 11 1980
WATER RESOURCES DEPT.
SALEM, OREGON

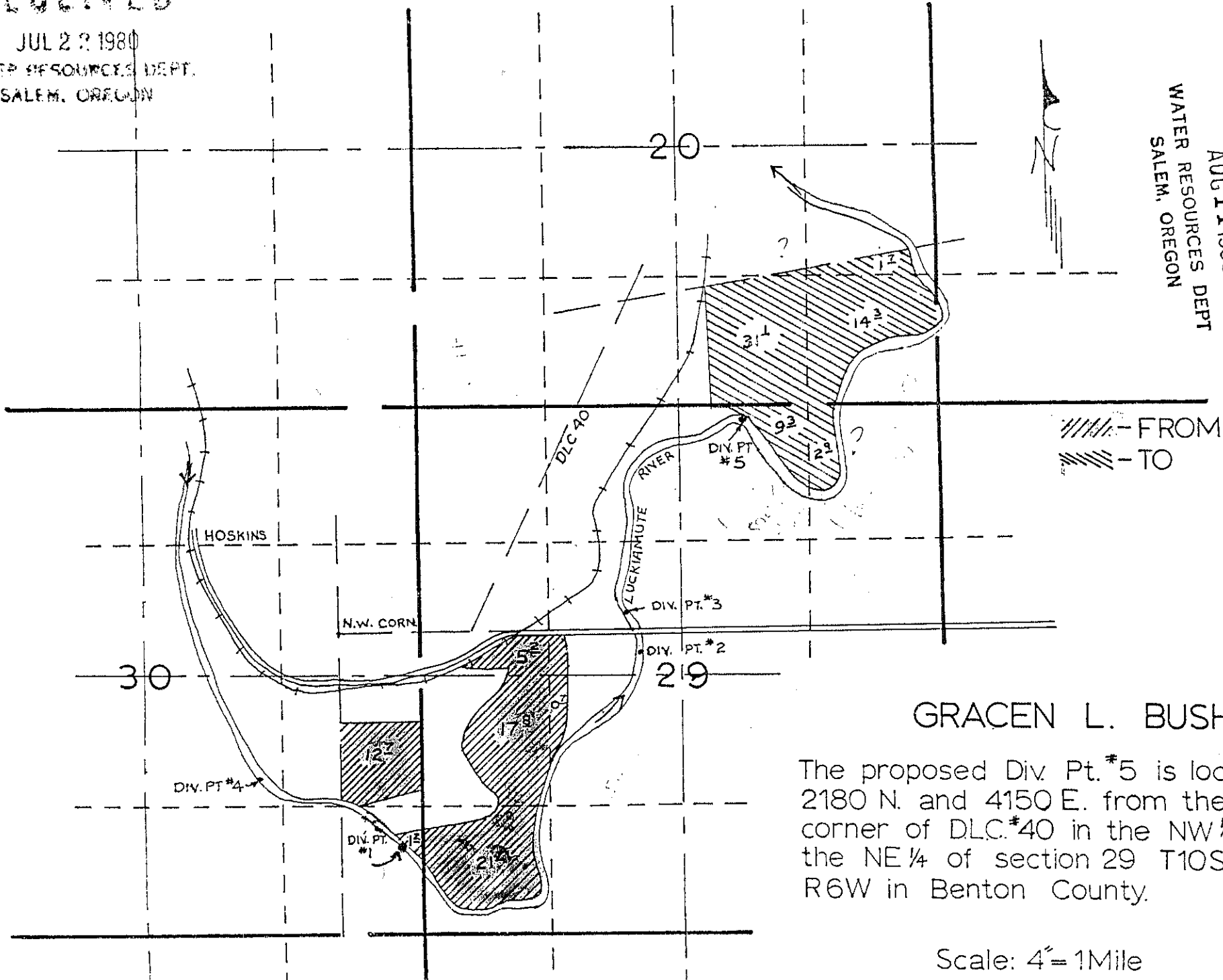

GRACEN L. BUSH

The proposed Div. Pt. #5 is located 2180 N. and 4150 E. from the N.W. corner of DLC.#40 in the NW 1/4 of the NE 1/4 of section 29 T10S R6W in Benton County.

Scale: 4" = 1 Mile