

35968
76447
76495
T4837
N

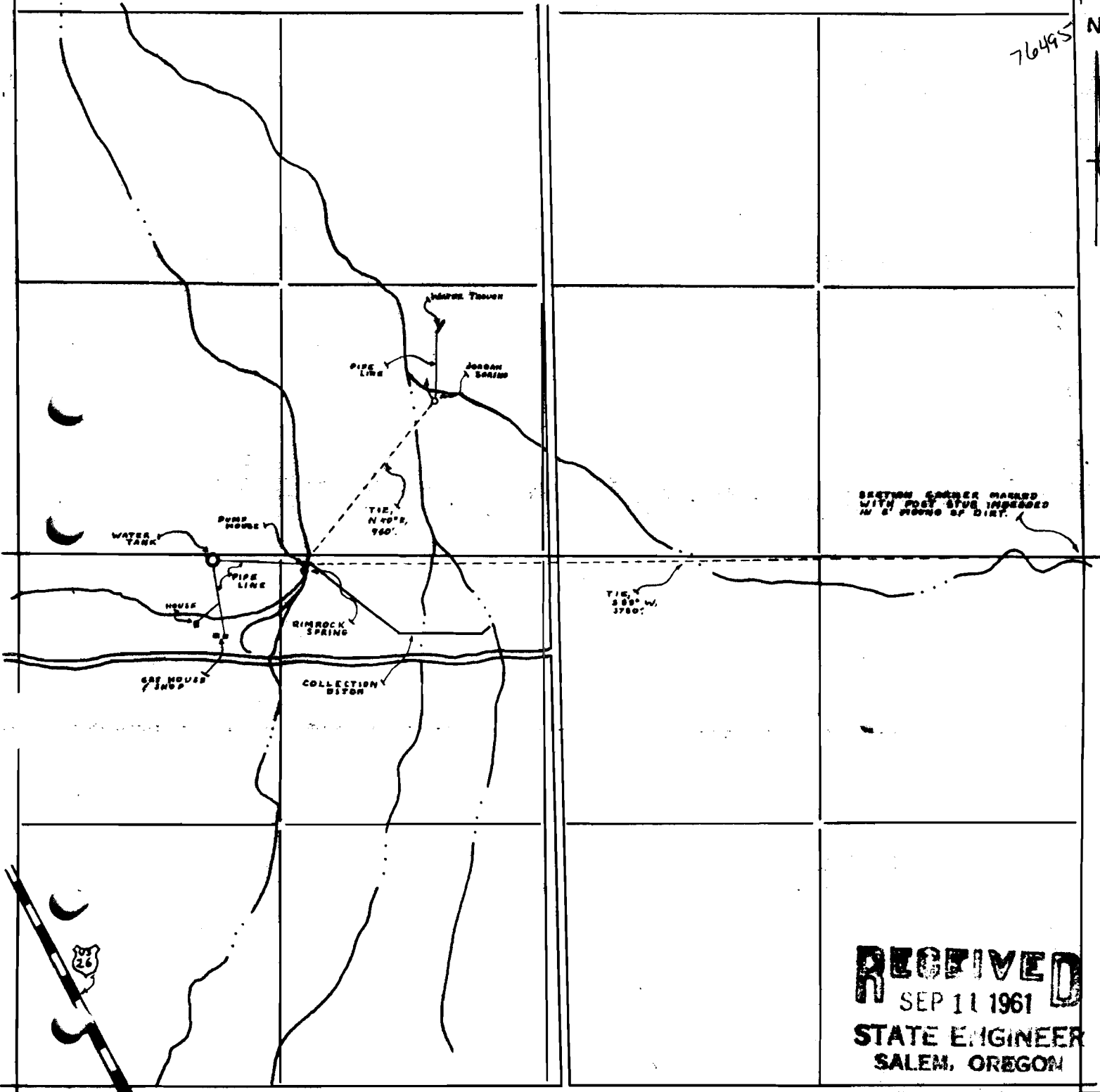

RECEIVED
 SEP 11 1961
 STATE ENGINEER
 SALEM, OREGON

34

Application No. **35020**
 Permit No. **27531**

CAMP SPRINGS

Drawn by: B Flint

Date 10-10-60

- LEGEND -

Intermittent Stream
 Roads



SCALE - 8 IN = 1 MI

27531

STATE OF OREGON
 DEPT. OF TRANSPORTATION