

RECEIVED

SEP 29 1998

WATER RESOURCES DEPT.
SALEM, OREGON

T. 25S., R. 12W., W.M.
COOS COUNTY, OR
FOR DOMESTIC USE

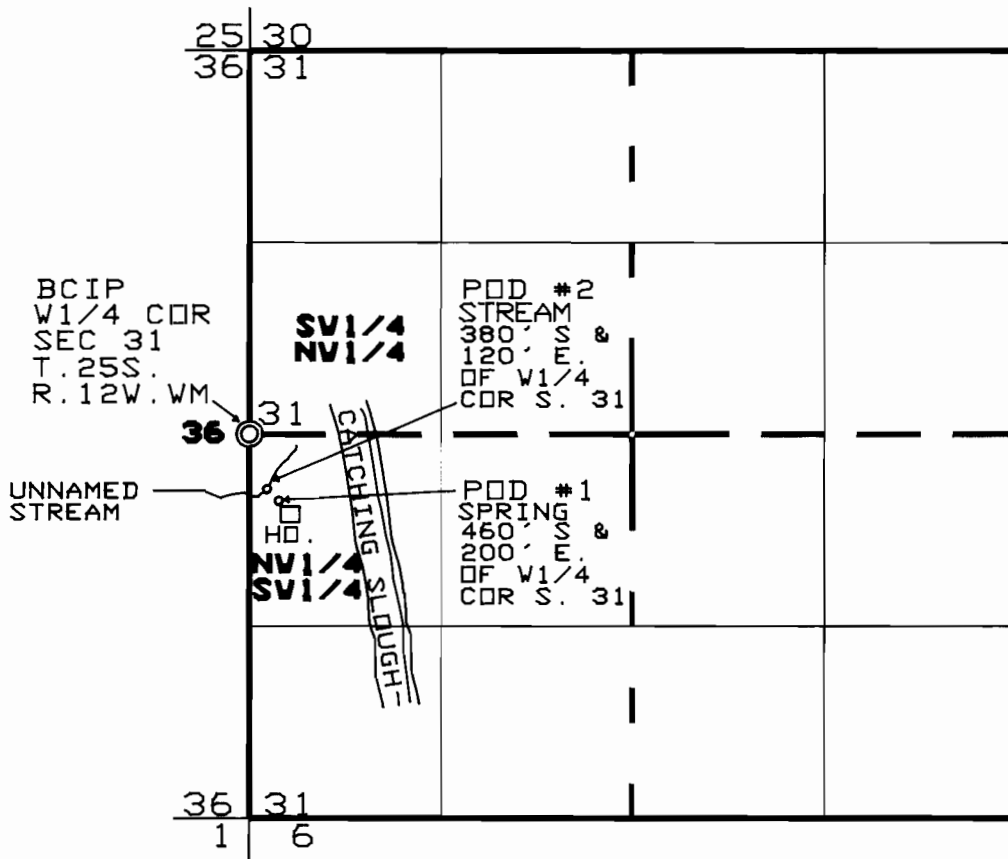

1" == 1320'

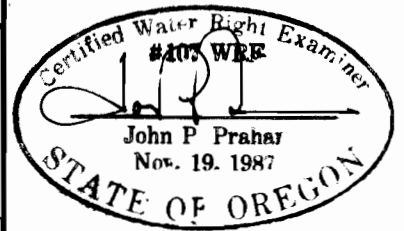

FINAL PROOF SURVEY
UNDER
PERMIT 51568 APP. 72890
IN THE NAME OF D. J. SMITH

SURVEYED BY C.W.R.E. #107, JOHN P. PRAHAR ON SEPT. 24, 1998.
NOTE: THE SOLE PURPOSE OF THIS MAP IS TO ASSIST IN LOCATING A WATER RIGHT AND IS NOT INTENDED TO SHOW OWNERSHIP OR PROPERTY LINES OR GIVE LEGAL DIMENTIONS.